

F3_a

Overhaul Kits, Pistons, Rings, Liners, Gaskets (3 Cylinder - Dexta 3.144 cu in)

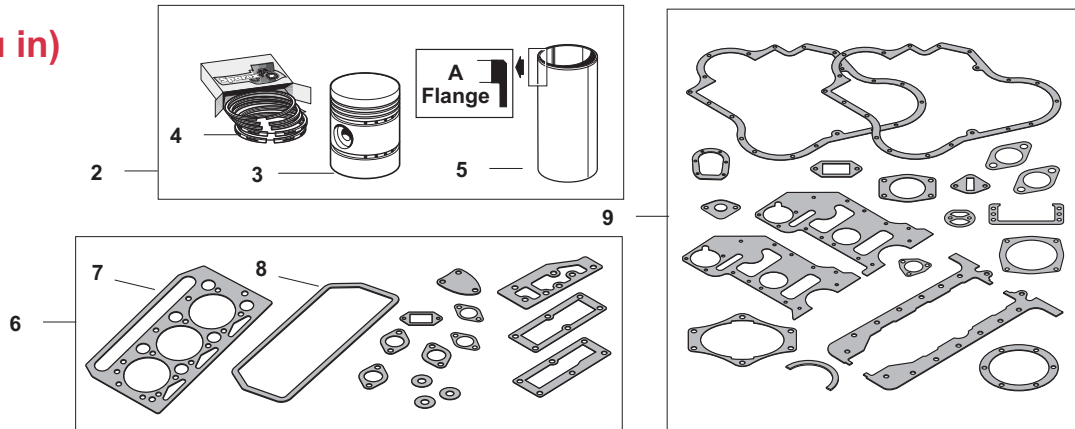
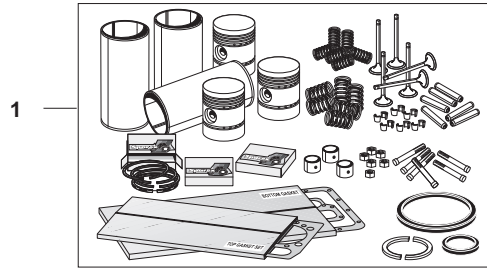

OUR #	DESCRIPTION	EQUIVALENT	TRACTOR MODEL
1	R66596 Overhaul Kit w/ Valve Train Kit - Straight - Unfinished Liner Contains: Pistons, Rings, Liners, Upper & Lower Gasket Sets, Intake & Exhaust Valves, Rod Bushings, Rod Bolts & Nuts, Front & Rear Crankshaft Seals, Guides, Springs, Keepers		Dexta 3.144 cu in (NOTE: If Block has Counterbore at top of cylinder, use Kit R40368 or R40387)
1	R40387 Overhaul Kit w/ Valve Train Kit - Flanged - Unfinished Liner		Dexta 3.144 cu in (NOTE: If Block <u>does not have</u> Counterbore at top of cylinder use Kit R66596)
1	R40368 Overhaul Kit w/ Valve Train Kit - Flanged - Finished Liner		Dexta 3.144 cu in (NOTE: If Block <u>does not have</u> Counterbore at top of cylinder use Kit R66596)
2	R66663 Piston, Ring & Liner Kit Straight - Unfinished Liner		Dexta 3.144 cu in (NOTE: If Block has Counterbore at top of cylinder use Kit R40461 or R40446)
2	R40461 Piston, Ring & Liner Kit Flanged - Unfinished Liner		Dexta 3.144 cu in (NOTE: If Block <u>does not have</u> Counterbore cylinder use Kit R66663)
2	R40446 Piston, Ring & Liner Kit Flanged - Finished Liner		Dexta 3.144 cu in (NOTE: If Block <u>does not have</u> Counterbore at top of cylinder use Kit R66663)
3	R40404 Piston, w/ Pin & Keepers	957E6102C	Dexta 3.144 cu in
4	R40418 Ring Set - 1 Cylinder	957E6149A	Dexta 3.144 cu in
5	R75967 Liner - Straight - Unfinished Liner	957E6055	Dexta 3.144 cu in (NOTE: If Block has Counterbore at top of cylinder use R40433 or R40439)
5	R40439 Liner - Flanged - Unfinished Liner	957E6055	Dexta 3.144 cu in (NOTE: If Block <u>does not have</u> Counterbore at top of cylinder use Kit R75967)
5	R40433 Liner - Flanged - Finished Liner	957E6055	Dexta 3.144 cu in (NOTE: If Block <u>does not have</u> Counterbore at top of cylinder use Kit R75967)
6	R40588 Upper Gasket Set		Dexta 3.144 cu in
7	R40619 Head Gasket	960E6051	Dexta 3.144 cu in
8	R40630 Rocker Cover Gasket	957E6584	Dexta 3.144 cu in
9	R66827 Lower Gasket Set - less Crankshaft Seals		Dexta 3.144 cu in

F3_a

Overhaul Kits, Pistons, Rings, Liners, Gaskets (3 Cylinder - Super Dexta 3.152 cu in)

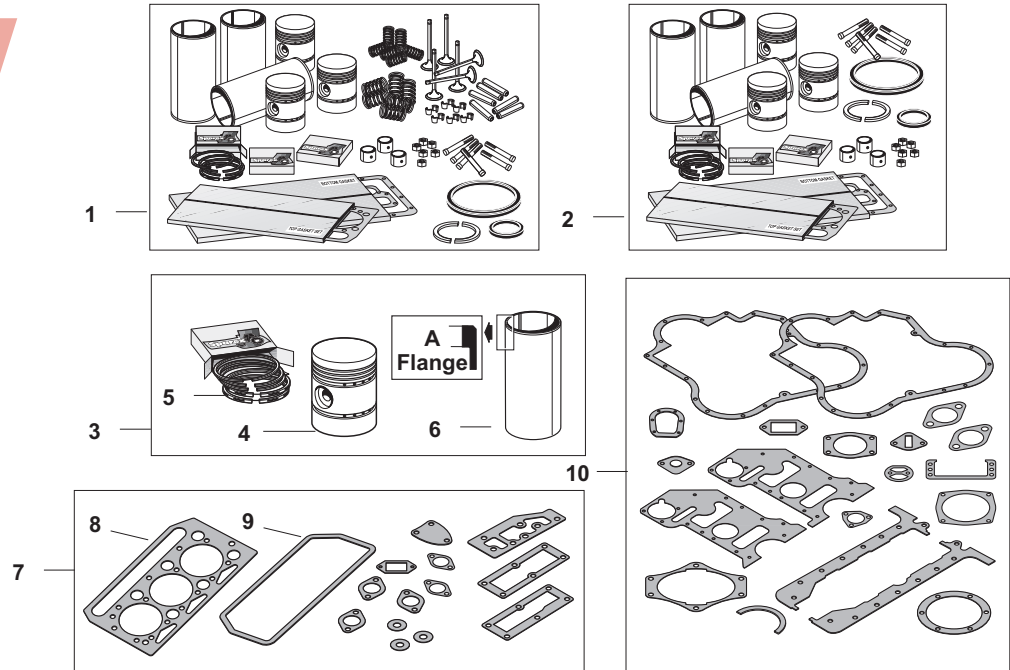

OUR #	DESCRIPTION	EQUIVALENT	TRACTOR MODEL
1	R66597 Overhaul Kit w/ Valve Train Kit - <u>Straight - Unfinished Liner</u> Contains: Pistons, Rings, Liners, Upper & Lower Gasket Sets, Intake & Exhaust Valves, Rod Bushings, Rod Bolts & Nuts, Front & Rear Crankshaft Seals, Guides, Springs, Keepers		Super Dexta 3.152 cu in (NOTE: If Block has Counterbore at top of cylinder, use Kit R40388, R40368 or R41883)
1	R40388 Overhaul Kit w/ Valve Train Kit - <u>Flanged - Unfinished Liner</u>		Super Dexta 3.152 cu in (NOTE: If Block does not have Counterbore at top of cylinder use Kit R66597)
1	R40370 Overhaul Kit w/ Valve Train Kit - <u>Flanged - Finished Liner</u>		Super Dexta 3.152 cu in (NOTE: If Block does not have Counterbore at top of cylinder use Kit R66597)
2	R41883 Overhaul Kit less Valve Train Kit - <u>Flanged - Finished Liner</u>		Super Dexta 3.152 cu in (NOTE: If Block does not have Counterbore at top of cylinder use Kit R66597)
3	R66664 Piston, Ring & Liner Kit - <u>Straight - Unfinished Liner</u>		Super Dexta 3.152 cu in (NOTE: If Block has a Counterbore at top of cylinder use Kit R40460 or R40445)
3	R40460 Piston, Ring & Liner Kit - <u>Flanged - Unfinished Liner</u>		Super Dexta 3.152 cu in (NOTE: If Block does not have Counterbore at top of cylinder use Kit R66664)
3	R40445 Piston, Ring & Liner Kit - <u>Flanged - Finished Liner</u>		Super Dexta 3.152 cu in (NOTE: If Block does not have Counterbore at top of cylinder use Kit R66664)
4	R40403 Piston w/ Pin & Keepers	960E6102B	Super Dexta 3.152 cu in
5	R40417 Ring Set - Cord Ring - 1 Cylinder	960E6149A	Super Dexta 3.152 cu in
5	R40430 Ring Set - Standard Type - 1 Cylinder	960E6149A	Super Dexta 3.152 cu in
5	R41323 Ring Set - Duaflex Type - 1 Cylinder	960E6149A	Super Dexta 3.152 cu in
6	R75968 Liner - <u>Straight - Unfinished</u>	960E6055	Super Dexta 3.152 cu in (NOTE: If Block has a Counterbore at top of Cylinder use R40438 or R40432)
6	R40438 Liner - <u>Flanged - Unfinished</u>		Super Dexta 3.152 cu in (NOTE: If Block does not have Counterbore at top of Cylinder use R75968)
6	R40432 Liner - <u>Flanged - Finished</u>		Super Dexta 3.152 cu in (NOTE: If Block does not have Counterbore at top of Cylinder use R75968)
7	R40588 Upper Gasket Set	957E6608	Super Dexta 3.152 cu in
8	R40619 Head Gasket	960E6051	Super Dexta 3.152 cu in
9	R40630 Rocker Cover Gasket	957E6584	Super Dexta 3.152 cu in
10	R66827 Lower Gasket Set - less Crankshaft Seals		Super Dexta 3.152 cu in

F3_a

Crankshaft, Bearings, Connecting Rods (3 Cylinder - Dexta, Super Dexta)

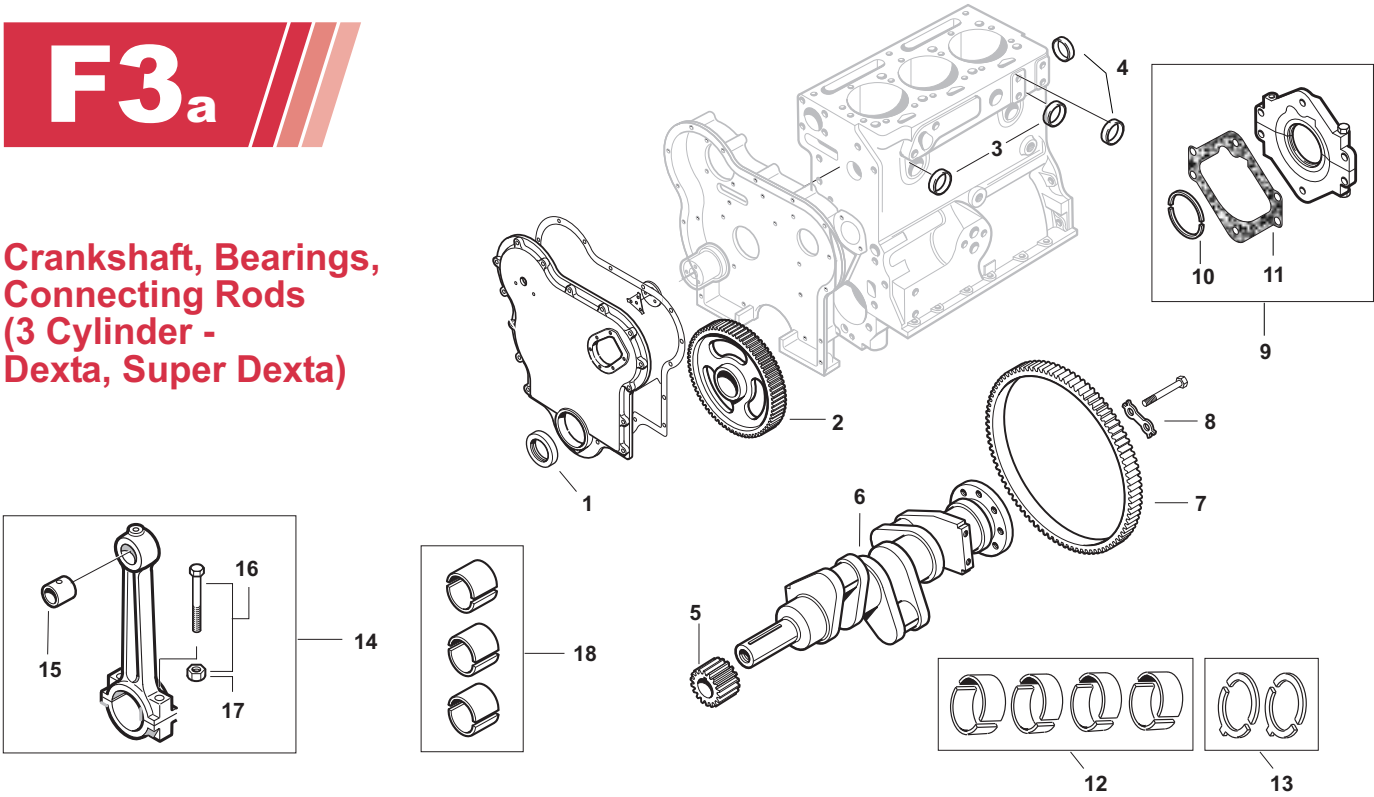

OUR #	DESCRIPTION	EQUIVALENT	TRACTOR MODEL
1	R65980 Seal - Front Timing Cover	957E6362	Dexta, Super Dexta
2	R40523 Idler Gear - 90 Teeth (9 1/2" Dia)	E33CP9	Dexta, Super Dexta
3	R08449 Expansion Plug (1 1/4")	115411ES	Dexta, Super Dexta
3	R12874 Expansion Plug (1 1/4") Stainless	115411ES	Dexta, Super Dexta
4	R08444 Expansion Plug (7/8")	115412ES	Dexta, Super Dexta
5	R40353 Gear - Crankshaft	957E6306	Dexta, Super Dexta
6	R61955 Crankshaft less Bearings	E2006T9	Dexta, Super Dexta
7	R65998 Ring Gear	957E6384B	Dexta, Super Dexta
8	R40347 Flywheel Bolt - Lock Tab	957E6367	Dexta, Super Dexta
9	R41494 Rear Seal Assembly Includes: Seal, Gasket, Retainer		Dexta, Super Dexta
10	R40354 Seal - Rear Main Rope	957E6701	Dexta, Super Dexta
11	R41494 Gasket - Rear Main Seal	957E6344A	Dexta, Super Dexta
12	R40331 Main Bearing Set - Standard (less Thrust Bearings)	957E6331L/R 957E6333L/R 957E6341L/R 957E6342L/R	Dexta, Super Dexta
12	R40332 Main Bearing Set - .010" (less Thrust Bearings)	957E6331M 957E6333M 957E6341M 957E6342M	Dexta, Super Dexta
12	R40333 Main Bearing Set - .020" (less Thrust Bearings)	957E6331N 957E6333N 957E6341N 957E6342N	Dexta, Super Dexta
12	R40334 Main Bearing Set - .030" (less Thrust Bearings)	957E6331P 957E6333P 957E6341P 957E6342P	Dexta, Super Dexta

F3_a

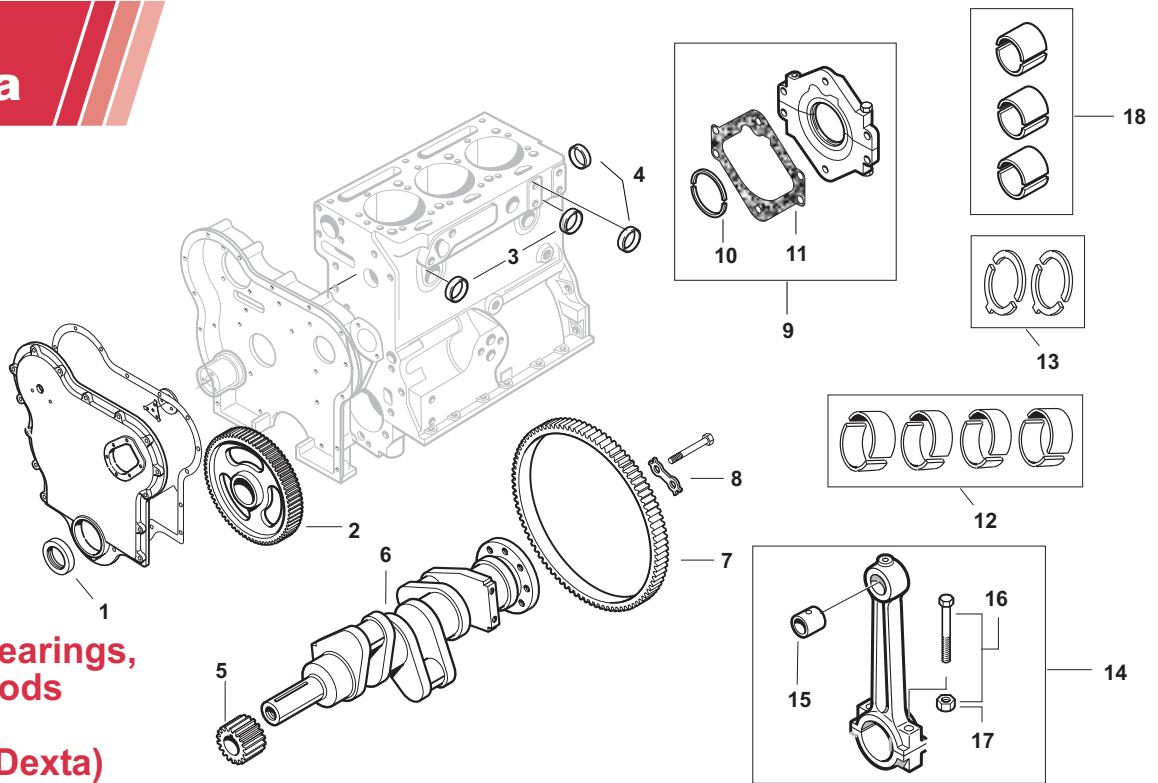

Crankshaft, Bearings, Connecting Rods (3 Cylinder - Dexta, Super Dexta)

OUR #	DESCRIPTION	EQUIVALENT	TRACTOR MODEL
12	R42077 Main Bearing Set - .040" (less Thrust Bearings)		Dexta, Super Dexta
12	R42114 Main Bearing Set - .050" (less Thrust Bearings)		Dexta, Super Dexta
13	R40343 Thrust Washer Set - Standard - 2 pair (.122" thick - Squared Tab, Centered)	957E6334A 957E6336C	Dexta, Super Dexta (NOTE: ->SN 1449364 the lower thrust washer tab was rounded and offset. Later engines used a squared tab located in the center of the washer.)
13	R40344 Thrust Washer Set - .007" (.129" thick - Squared Tab, Centered)	957E6334B 957E6336D	Same as Above
14	R40357 Connecting Rod Assembly	957E6200	Dexta, Super Dexta
15	R40360 Connecting Rod Bushing	957E6207	Dexta, Super Dexta
16	R40362 Connecting Rod Bolt & Nut	957E6215 385279S2	Dexta, Super Dexta
17	R41328 Connecting Rod Nut	385279S2	Dexta, Super Dexta
18	R40315 Rod Bearing Set - Standard	957E6211Fx6	Dexta, Super Dexta
18	R40316 Rod Bearing Set - .010"	957E6211Gx6	Dexta, Super Dexta
18	R40317 Rod Bearing Set - .020"	957E6211Hx6	Dexta, Super Dexta
18	R40318 Rod Bearing Set - .030"	957E6211Jx6	Dexta, Super Dexta
18	R42079 Rod Bearing Set - .040"		Dexta, Super Dexta
18	R42109 Rod Bearing Set - .050"		Dexta, Super Dexta

F3_a

Oil & Fuel Pumps, Filters (3 Cylinder - Dexta, Super Dexta)

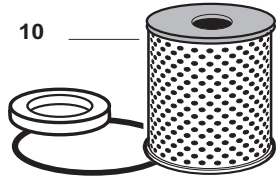
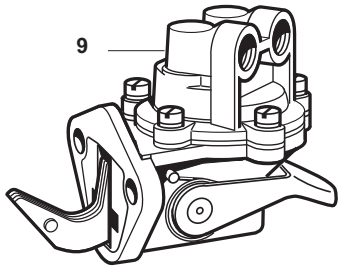
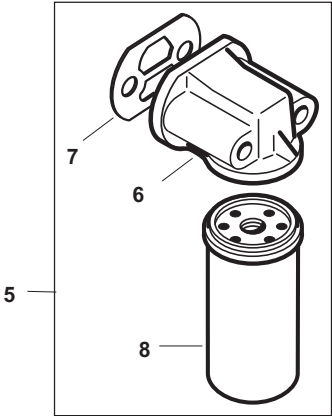
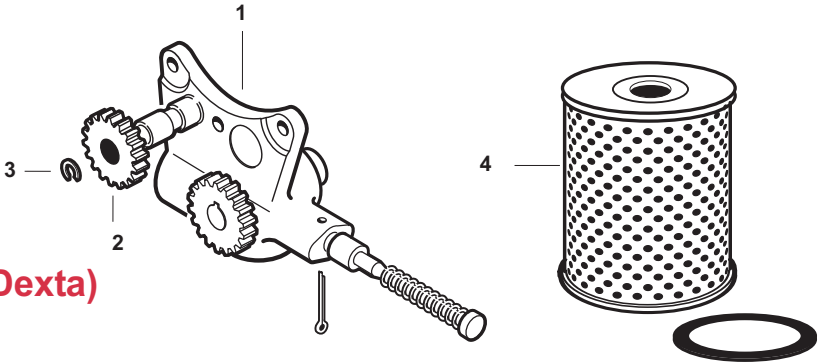

OUR #	DESCRIPTION	EQUIVALENT	TRACTOR MODEL
1			
2			
3			
4			
5			
6			
7			
8			
9			
10			
			E-Mail us for requests on this page
			ricksagriparts@gmail.com



**Cylinder Head, Camshaft and Related Components
(3 Cylinder - Dexta, Super Dexta)**

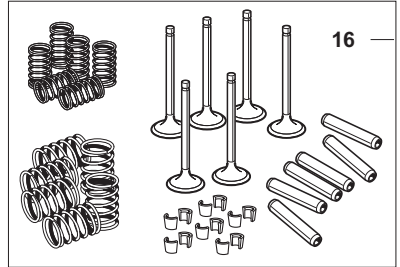
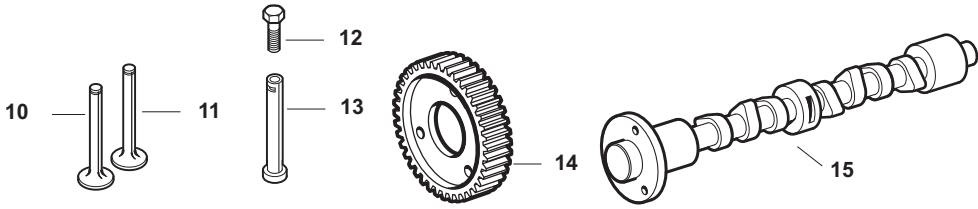
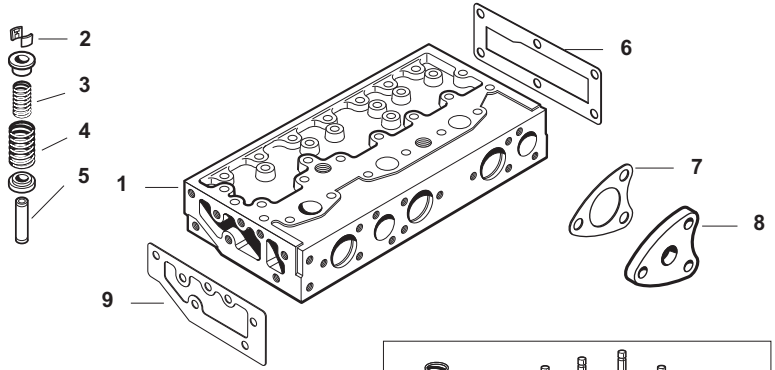

OUR #	DESCRIPTION	EQUIVALENT	TRACTOR MODEL
1	R40303 Cylinder Head Assembly (Complete w/ Valves)	E2046T9	Dexta, Super Dexta
2	R41412 Valve Collet - Sold per Piece	957E6518	Dexta, Super Dexta
3	R40500 Inner Valve Spring	957E6509	Dexta, Super Dexta
4	R40505 Outer Valve Spring	957E6513	Dexta, Super Dexta
5	R40495 Valve Guide	957E6510B	Dexta, Super Dexta
6	R42304 Gasket	E32CA9	Dexta, Super Dexta
7	R42230 Gasket - Combustion Chamber Cap	957E6K003	Dexta, Super Dexta
8	R41567 Combustion Chamber Cap	E62CA9	Dexta, Super Dexta
9	R42211 Gasket - Thermostat Housing	957E8255	Dexta, Super Dexta
10	R40475 Intake Valve	957E6507	Dexta, Super Dexta
11	R40485 Exhaust Valve	957E6505	Dexta, Super Dexta
12	R42291 Screw - Tappet Adjusting	957E6549	Dexta, Super Dexta
13	R41345 Tappet - Camshaft Follower	957E6489	Dexta, Super Dexta
14	R40520 Camshaft Gear	957E6256	Dexta, Super Dexta
15	R41507 Camshaft	957E6250	Dexta, Super Dexta
16	R41585 Valve Train Kit - Includes: Intake & Exhaust Valves, Guides, Springs, Keepers		Dexta, Super Dexta

Technical Information

Models	Piston	Ring Sets	Liner
--------	--------	-----------	-------

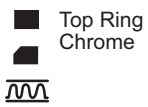
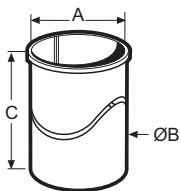
9N, 2N, 8N	R60840 	R60853 		R60846 Heavywall .090" A=3.18" ID B=3.36" OD C=6.437" Length 3.40" Top Lip	R60847 Thinwall .040" A=3.18" ID B=3.36" OD C=6.437" Length 3.36" Top Lip
------------------	--	--	--	--	---

9N, 2N, 8N - General Information

Crankshaft Specifications Standard Main Journals 2.248-2.249 Standard Rod Journals 2.093-2.094 Main Bearing Cap Torque 75-80 Ft Lb Rod Bearing Cap Torque 45 Ft Lb	Valve Clearance Intake .012 Exhaust .014	Head Torque Nuts 50-50 Ft Lb Hot Bolts 65-70 Ft Lb Hot	Point Gap Front Drive Distributor .015 Angle Drive Distributor .025 Spark Plugs .025
---	---	---	---

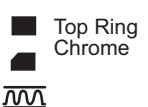
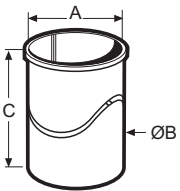
NAA, Jubilee, 600, 700, 601, 701, 2000 134 cu in Gas	R60841 (Overbore) 	R60854 (Overbore) 		R60848 (Overbore) A=3.50" ID B=3.65" OD C=6.93" Length 3.74" Top Lip
--	--	--	---	---

NAA, Jubilee, 600, 700, 601, 701, 2000 - General Information

Crankshaft Specifications Standard Main Journals 2.497-2.498 Standard Rod Journals 2.297-2.298 Main Bearing Cap Torque 100-105 Ft Lb Rod Bearing Cap Torque 45-50 Ft Lb	Valve Clearance Intake .014-.016 Hot Exhaust .014-.016 Hot	Head Torque Gasoline 65-70 Hot Rocker Support Bolts 45 Ft Lb	Point Gap .025 Plug Gap .025
--	---	---	---

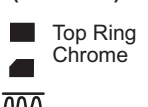
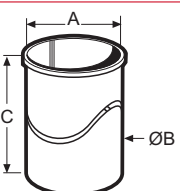
800, 900, 801, 901, 4000	R60842 (Overbore) 	R60855 (Overbore) 		R60845 (Overbore) A=4.01" ID B=4.10" OD C=6.93" Length 4.25" Top Lip
--------------------------------	---	---	--	---

800, 900, 801, 901, 4000 - General Information



Crankshaft Specifications Standard Main Journals 2.497-2.498 Standard Rod Journals 2.297-2.298 Main Bearing Cap Torque 100-105 Ft Lb Rod Bearing Cap Torque 45-50 Ft Lb	Valve Clearance Intake .014-.016 Hot Exhaust .014-.016 Hot	Head Torque Gasoline 65-70 Hot Rocker Support Bolts 45 Ft Lb	Point Gap .025 Plug Gap .025
--	---	---	---





General Information

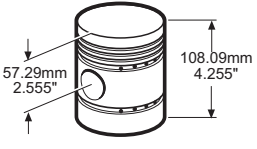

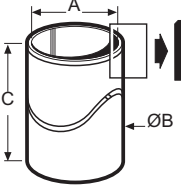
Do not use gasoline or kerosene to clean the sleeve walls after honing or boring the cylinders. Solvents of this type will not remove the abrasive but will further imbed small abrasive particles into the pores of the cylinder sleeve. Wash the sleeve bores with hot soapy water. Flush water jackets to remove foreign materials which might cause excessive wear to the water pump. Coat the cylinder with clean engine oil to prevent rusting.

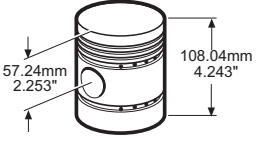
F3

Technical Information

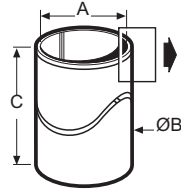
Models	Piston	Ring Sets	Liner	Finished	Semi-Finished		
A3.144	R40404 	R40418 	 R40433 R40439	R40433 A=88.925mm/3.5" B=93.71mm/3.6895" C=215.9mm/8.5"	R40439 A=Un-Finished B=93.71mm/3.6895" C=215.9mm/8.5"		
Dexta - A3.144 - Perkins Diesel - General Information							
Number of Cylinders	3	Crankshaft Journal Dia.	2.749"	Injection Pump Make - Model	Simms - Inline	Big End Cap Torque	65/70Lbs/Ft
Bore - Inches	3.5"	Crank Pin Diameter	2.249"	Injection Pump Timing-Mech.	20° BTDC	Flywheel Bolt Torque	75 Lbs/Ft
Stroke - Inches	5"	Piston Pin Diameter	1.250"	Injection Pump Timing-Vacuum	26° BTDC	Compression Ring Gaps	0.008"-0.012"
Displacement - Cu.In.	144 cu.in.	Firing Order	1-2-3	Injector Nozzle Setting	2300 Psi.	Oil Control Ring Gaps	0.008"-0.012"
Compression Ratio	16.5:1	Valve Clearance - Inlet	0.010" Hot	Engine Low Idle Rpm	550	Crank Case Oil	2 Gallons
Pistons Removed from Main Bearings	Above	Valve Clearance - Exhaust	0.010" Hot	Engine High Idle Rpm	2200	Cooling System	2.25 Gallons
Cylinder Sleeves	Dry	Valve Angle - Inlet	44°	Cylinder Head Torque	55-60 Lbs/Ft		
		Valve Angle - Exhaust	44°	Main Bearing Cap Torque	90/95 Lbs/Ft		

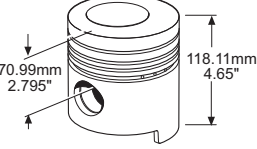
A3.152	R40403 	R40417 	R40430 	R41323 	 R40432 R40438	R40432 A=91.49mm/3.602" B=93.66mm/3.687" C=215.9mm/8.5"	R40438 A=Un-Finished B=93.663mm/3.687" C=215.9mm/8.5"
Super Dexta - A3.152 - Perkins Diesel - General Information							
Number of Cylinders	3	Crankshaft Journal Dia.	2.749"	Injection Pump Make - Model	Simms - Inline	Big End Cap Torque	70-80 Lbs/Ft
Bore - Inches	3.6"	Crank Pin Diameter	2.249"	Injection Pump Timing-Mech.	20° BTDC	Flywheel Bolt Torque	75 Lbs/Ft
Stroke - Inches	5"	Piston Pin Diameter	1.250"	Injection Pump Timing-Vacuum	26° BTDC/1760	Compression Ring Gaps	0.009"-0.013"
Displacement - Cu.In.	152.7cu.in.	Firing Order	1-2-3	Injector Nozzle Setting	Psi.	Oil Control Ring Gaps	0.009"-0.013"
Compression Ratio	17.4:1	Valve Clearance - Inlet	0.010" Hot	Engine Low Idle Rpm	500	Crank Case Oil	2 Gallons
Pistons Removed from Main Bearings	Above	Valve Clearance - Exhaust	0.010" Hot	Engine High Idle Rpm	2200	Cooling System	2.25 Gallons
Cylinder Sleeves	Dry	Valve Angle - Inlet	44°	Cylinder Head Torque	55-60 Lbs/Ft		
		Valve Angle - Exhaust	44°	Main Bearing Cap Torque	110-120 Lbs/Ft		

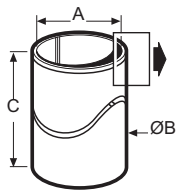
Major Super Major Power Major	R65958 	R65952 		R65957 A=100.00mm/3.94" B=111.76mm/4.40" C=222.88mm/8.77"			
Major 57>65 - Super Major - General Information							
Number of Cylinders	4	Crankshaft Journal Dia.	3"	Valve Angle - Exhaust	29.5°	Main Bearing Cap Torque	See Manual
Bore - Inches	3.937"	Crank Pin Diameter	2.5"	Injection Pump Make - Model	Simms - Inline	Big End Cap Torque	55/60 Lbs/Ft
Stroke - Inches	4.525"	Piston Pin Diameter-Early	1.250"	Injection Pump Timing-Mech.	21° BTDC	Flywheel Bolt Torque	80/90 Lbs/Ft
Displacement - Cu.In.	220.35 cu.in.	Piston Pin Diameter-Late	1.375"	Injection Pump Timing-Vacuum	See R14222	Compression Ring Gaps	0.014"-0.034"
Compression Ratio	16:1	Firing Order	1-2-4-3	Injector Nozzle Setting	1760 Psi.	Oil Control Ring Gaps	0.015"-0.035"
Pistons Removed from Main Bearings	Above	Valve Clearance - Inlet	0.015" Hot	Engine Low Idle Rpm	550	Crank Case Oil	2 Gallons
Cylinder Sleeves	Wet	Valve Clearance - Exhaust	0.012" Hot	Engine High Idle Rpm	1900-1925	Cooling System	3.6 Gallons
		Valve Angle - Inlet	29.5°	Cylinder Head Torque	85/90 Lbs/Ft		

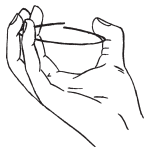

Cord Ring Instructions

Third Compression Ring consists of 4 steel segmentR Grasp and compress as shown until ring ends slightly overlap. Ring ends will curl up or down, if segment is turned over. (Ring ends should curl down on segment placed in bottom of groove, up on 2nd segment, etc. See ill right.) Space end gaps 180° apart for alternate segments after all are installed.

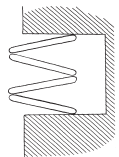

F3

Exhaust System (3 Cylinder - Dexta, Super Dexta)

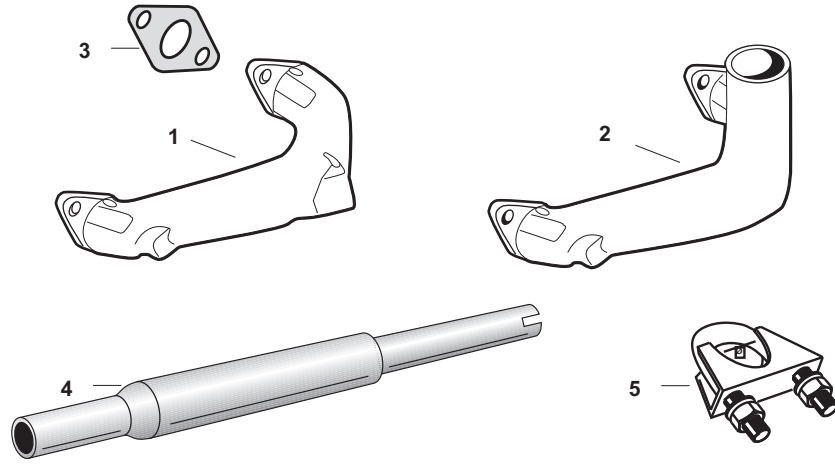

	OUR #	DESCRIPTION	EQUIVALENT	TRACTOR MODEL
1	R66046	Manifold - Horizontal	957E9430B	Dexta, Super Dexta
2	R66047	Manifold - Vertical	957E9430A	Dexta, Super Dexta
3	R41348	Gasket - 2 Required	957E9448	Dexta, Super Dexta
4	R06303	Muffler - Vertical	957E5230D	Dexta, Super Dexta
5	R08872	Muffler Clamp (1 1/8")		
5	R08873	Muffler Clamp (1 1/4")		
5	R08874	Muffler Clamp (1 3/8")		
5	R08875	Muffler Clamp (1 1/2")		
5	R08876	Muffler Clamp (1 5/8")		
5	R08877	Muffler Clamp (1 11/16")		
5	R08878	Muffler Clamp (1 3/4")		
5	R08879	Muffler Clamp (1 7/8")		
5	R08880	Muffler Clamp (2")		

F3_b

Piston, Ring, Liners, Gaskets and Cylinder Head (4 Cylinder - 1939-1964)

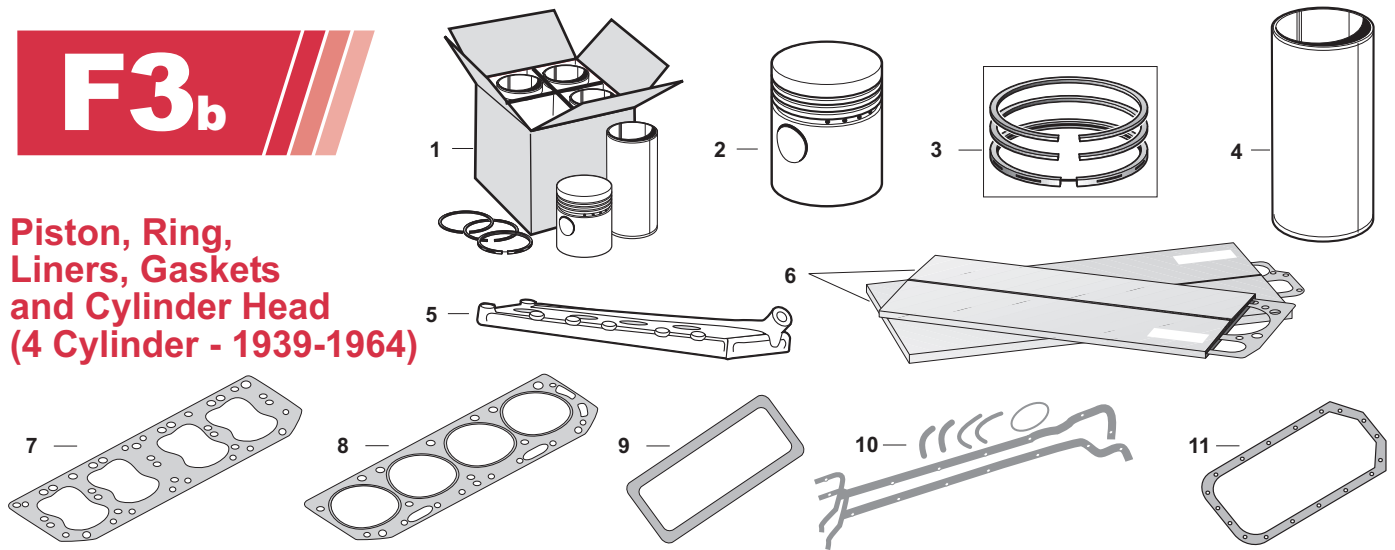

	OUR #	DESCRIPTION	EQUIVALENT	TRACTOR MODEL
1	R60704	Piston, Ring & Liner Kit (.040 Thin Wall) 3 Ring	APN6055E	9N, 2N, 8N (Piston - R60840, Rings - R60853, Liner - R60847)
1	R60705	Piston, Ring & Liner Kit (.090 Heavy Wall) 3 Ring	APN6055D	9N, 2N, 8N (Piston - R60840, Rings - R60853, Liner - R60846)
1	R60706	Piston, Ring & Liner Kit (3 1/2" Overbore) 3 Ring	CPN6055A	NAA, Jubilee, 600, 700, 601, 701, 2000 (134 cu. in. Gas Engine) (Piston - R60841, Rings - R60854, Liner - R60848)
1	R60708	Piston, Ring & Liner Kit (4" Overbore) 3 Ring	FPN6055A	800, 900, 801, 901, 4000 (172 cu. in. Gas Engine) (Piston - R60842, Rings - R60855, Liner - R60845)
2	R60840	Piston - 3 Ring	8N6108B	9N, 2N, 8N
2	R60841	Piston - 3 Ring (3 1/2" Overbore)		NAA, Jubilee, 600, 700, 601, 701, 2000 (134 cu in Gas Engine) (Will not fit standard Bore)
2	R60842	Piston - 3 Ring (4" Overbore)		800, 900, 801, 901, 4000 (172 cu in Gas Engine) (Will not fit Standard Bore)
3	R60853	Complete Ring Set - 3 Ring Chrome	8N6149B	9N, 2N, 8N
3	R60854	Complete Ring Set - 3 Ring Chrome (3 1/2" Overbore)		NAA, Jubilee, 600, 700, 601, 701, 2000 (134 cu in Gas Engine) (Will not fit Standard Bore)
3	R60855	Complete Ring Set - 3 Ring Chrome (4" Overbore)		800, 900, 801, 901, 4000 (172 cu in Gas Engine) (Will not fit Standard Bore)
4	R60847	Liner (.040" Thin Wall)	C0NN6055B	9N, 2N, 8N
4	R60846	Liner (.090" Heavy Wall)	8N6055B	9N, 2N, 8N
4	R60848	Liner (3 1/2" Overbore)		NAA, Jubilee, 600, 700, 601, 701, 2000 (Must use oversize Piston & Ring)
4	R60845	Liner (4" Overbore)		800, 900, 801, 901, 4000 (Must use oversize Piston & Ring)
5	R66843	Cylinder Head	8N6050A	9N, 2N, 8N
6	R60836	Overhaul Gasket Kit	8N6008	9N, 2N, 8N
6	R61509	Overhaul Gasket Set w/ Crank Seals (Less Head Gasket)	309953	NAA, Jubilee, 600, 700, 800, 900, 601, 701, 801, 901, 2000, 4000 (Gas Only)
7	R66458	Head Gasket - Non Metal	8N6051A	9N, 2N, 8N
8	R61511	Head Gasket	EAE6051D	NAA, Jubilee, 600, 700 (-> 57)
8	R60411	Head Gasket	D3JL6051A	601, 701, 2000 (58-64 Gas)
8	R60442	Head Gasket	E9JL6051AA	800, 900, 801, 901, 4000 (55-64 Gas)
9	R66457	Rocker Cover Gasket	EAE6584C	NAA, Jubilee, 600, 700, 800, 900, 601, 701, 801, 901, 2000, 4000 (Gas)
10	R66459	Oil Pan Gasket & Seal Kit	9N6781	9N, 2N, 8N
11	R66454	Oil Pan Gasket	EAF6710B	NAA, Jubilee, 600, 700, 800, 900, 601, 701, 801, 901, 2000, 4000

F3_b

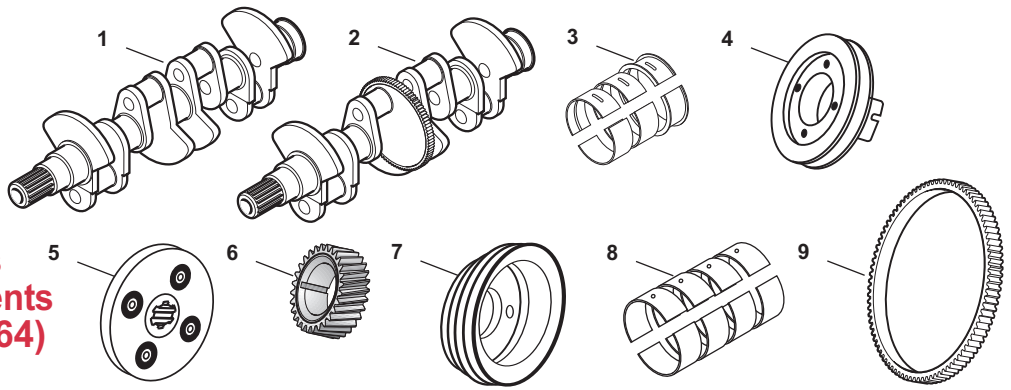

Crankshaft, Bearings and Related Components (4 Cylinder - 1939-1964)

	OUR #	DESCRIPTION	EQUIVALENT	TRACTOR MODEL
1	R66669	Crankshaft - Less Bearings	D1NL6303D	NAA, Jubilee, 600, 700, 800, 900, 601, 701, 801, 901, 2000, 4000 (Gas)
2	R66670	Crankshaft - Less Bearings	E2JL6300BA	601, 701, 801, 901, 2000, 4000 (Diesel)
3	R60871	Main Bearing Set - Std.	9N6333Ax4 9N6331Ax2	9N, 2N, 8N
3	R60872	Main Bearing Set - .010"	9N6333Ex4 9N6331Ex2	9N, 2N, 8N
3	R60873	Main Bearing Set - .020"	9N6333Gx4 9N6331Gx2	9N, 2N, 8N
3	R60874	Main Bearing Set - .030"	A0NN6333A x4 A0NN6331A x2	9N, 2N, 8N
3	R60875	Main Bearing Set - .040"		9N, 2N, 8N
3	R60876	Main Bearing Set - Std.	EAF6331Ax4 EAF6342Cx2	NAA, Jubilee, 600, 700, 800, 900, 601, 701, 801, 901, 2000, 4000
3	R60877	Main Bearing Set - .010"	EAF6331Dx4 EAF6342Fx2	NAA, Jubilee, 600, 700, 800, 900, 601, 701, 801, 901, 2000, 4000
3	R60878	Main Bearing Set - .020"	EAF6331Ex4 EAF6342Gx2	NAA, Jubilee, 600, 700, 800, 900, 601, 701, 801, 901, 2000, 4000
3	R60879	Main Bearing Set - .030"	C0NN6331Ex4	NAA, Jubilee, 600, 700, 800, 900, 601, 701, 801, 901, 2000, 4000
3	R60880	Main Bearing Set - .040"	C0NN6331Fx4	NAA, Jubilee, 600, 700, 800, 900, 601, 701, 801, 901, 2000, 4000
4	R61965	Pulley - Crankshaft (4 Bolt Holes 1/4" x 20)	192160 2N6312	9N, 2N, 8N
5	R61559	Loader Drive Adaptor (3/4 - 6 Spline)	192161	9N, 2N, 8N
6	R61043	Crankshaft Gear	EAF6306B	NAA, Jubilee, 600, 700, 800, 900, 601, 701, 801, 901, 2000, 4000
7	R60796	Pulley - Crankshaft - Double Groove	C0NN6351A	600, 700, 800, 900, 601, 701, 801, 901, 2000, 4000
8	R60881	Rod Bearing Set - Std.	9N6211Ax8	9N, 2N, 8N
8	R60882	Rod Bearing Set - .010"	9N6211Ex8	9N, 2N, 8N
8	R60883	Rod Bearing Set - .020"	9N6211Gx8	9N, 2N, 8N
8	R60884	Rod Bearing Set - .030"	A0NN6211Ax8	9N, 2N, 8N
8	R60885	Rod Bearing Set - .040"	A0NN6211Bx8	9N, 2N, 8N
8	R60886	Rod Bearing Set - Std.	312026	NAA, Jubilee, 600, 700, 800, 900, 601, 701, 801, 901, 2000, 4000
8	R60887	Rod Bearing Set - .010"	312103	NAA, Jubilee, 600, 700, 800, 900, 601, 701, 801, 901, 2000, 4000
8	R60888	Rod Bearing Set - .020"	312104	NAA, Jubilee, 600, 700, 800, 900, 601, 701, 801, 901, 2000, 4000
8	R60889	Rod Bearing Set - .030"	C0NN6211B	NAA, Jubilee, 600, 700, 800, 900, 601, 701, 801, 901, 2000, 4000
8	R60890	Rod Bearing Set - .040"	C0NN6211C	NAA, Jubilee, 600, 700, 800, 900, 601, 701, 801, 901, 2000, 4000
9	R61103	Ring Gear	9N6384	9N, 2N, 8N, NAA, Jubilee, 600, 700, 800, 900, 601, 701, 801, 901, 2000, 4000

F3

MELLING
ENGINE PARTS
Made in USA

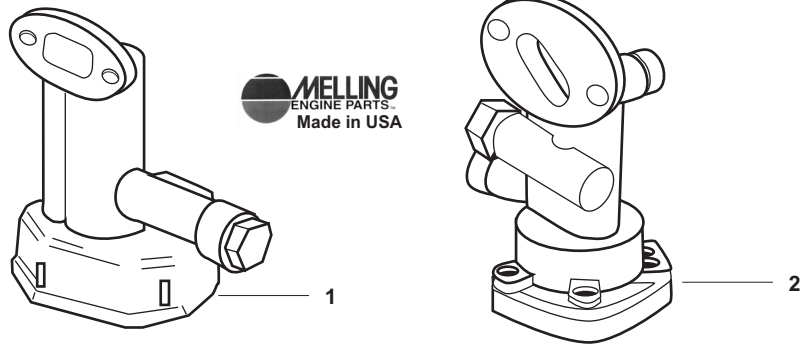

Oil Pumps and Filters (4 Cylinder - 1939-1964)

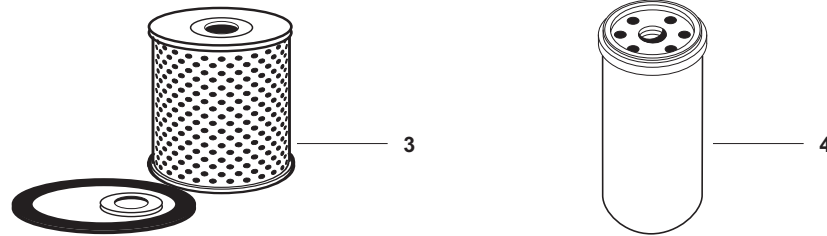

OUR #	DESCRIPTION	EQUIVALENT	TRACTOR MODEL
1	R66554 Oil Pump - Gear Type - Slotted Drive	EAF6621D	NAA, Jubilee
1	R66555 Oil Pump - Gear Type - Hex Drive	EAE6621AB	600, 700, 800, 900, 601, 701, 801, 901 ('55-61 Gas)
2	R66556 Oil Pump - Rotor Type	C3NN6621A	2000, 4000, ('62-64 Gas)
3	R61121 Engine Oil Filter - Individually Boxed	APN6731B 86546605	9N, 2N, 8N
3	R61122 Engine Oil Filter - Bulk Carton (Order in multiples of 12)	APN6731B 86546605	9N, 2N, 8N
3	R60169 Engine Oil Filter - Cartridge Type w/ Gasket	CPN6731B 86546608	NAA, Jubilee, 600, 700, 800, 900, 601, 701, 801, 901, 2000, 4000
4	R40538 Engine Oil Filter - Spin-on Type	E7NN6714AA 86546614	NAA, Jubilee, 600, 700, 800, 900, 601, 701, 801, 901, 2000, 4000

F3_b

Fuel System Components (4 Cylinder - 1939-1964)

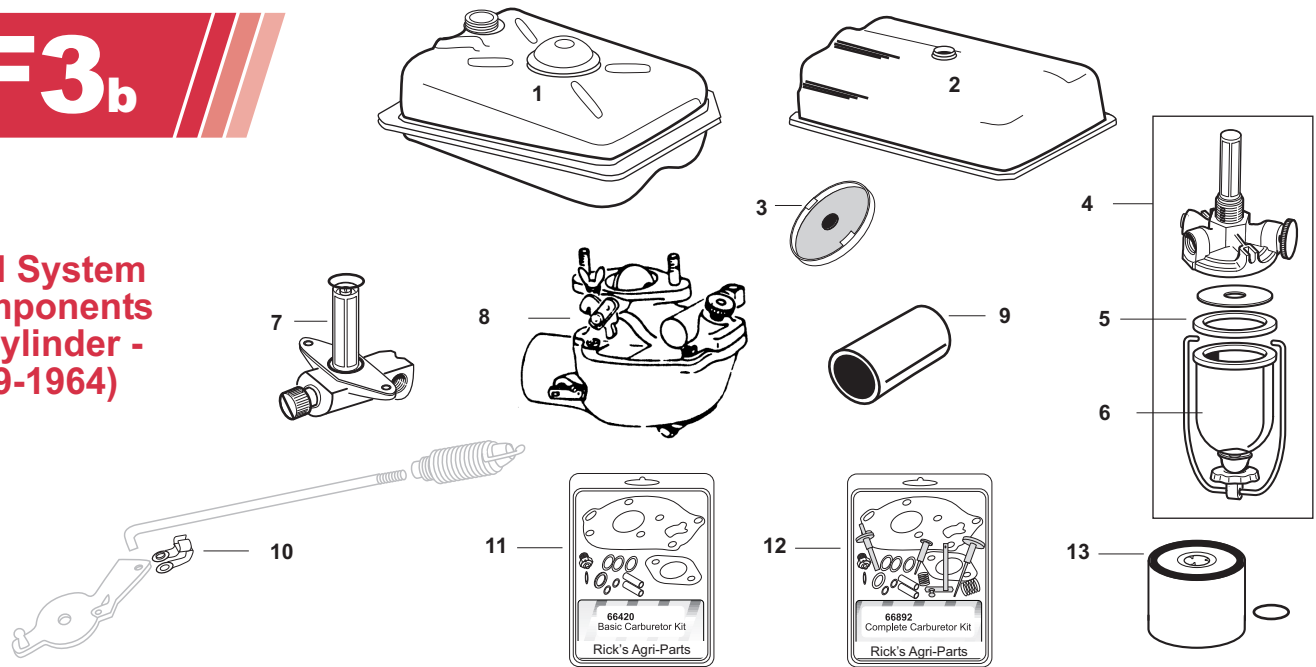

OUR #	DESCRIPTION	EQUIVALENT	TRACTOR MODEL
1	R61950 Gas Tank - Less Cap	9N9002	9N, 2N, 8N
2	R61130 Gas Tank - Less Cap (Uses either Threaded Shut-off or center mounted Bolt on Shut-off)	NAA9002E NCA9002A	NAA, Jubilee, 600, 700, (601, 701, 2000 Can fit but has no hole for sender unit) (800, 900, 801, 901, 4000 Will fit but smaller capacity and no hole for sender unit)
3	R65819 Cap - Gas Tank	D5NN9030A	9N, 2N, 8N, NAA, Jubilee, 600, 700, 800, 900, 601, 701, 801, 901, 2000, 4000
4	R61577 Shut Off & Sediment Bowl Assembly	2N9155B	9N, 2N, 8N, NAA, Jubilee
5	R61508 Gasket - Sediment Bowl (2" OD) Pack of 10	NAA9160A	(9N, 2N, 8N, NAA, Jubilee, 600, 700, 800, 900, 39/57)
6	R66417 Sediment Bowl (2" OD x 1.280")	9N9162	(9N, 2N, 8N, NAA, Jubilee, 600, 700, 800, 900, 39/57)
7	R60365 Shut-off Assembly w/ O-Ring (1/4" Fuel Line)	311292	(600, 700, 800, 900, 601, 701, 801, 901 ->12/60)
8	R61596 Carburetor	8N9510C	9N, 2N, 8N
9	R60595 Hose - Carburetor to Air Cleaner Pipe	9N9652	(9N, 2N, 8N, NAA, Jubilee, 600, 700, 800, 900 ->58)
10	R41343 Throttle Rod Clip	D9NN9825AA D9NN9825AB	NAA, Jubilee, 600, 700, 800, 900, 601, 701, 801, 901, 2000, 4000 (-> '65)
11	R66420 Basic Carburetor Kit - Includes: Gaskets, Throttle Shaft, Needle & Seat (Viton), Shaft Seals, Float Pin, Screws		9N, 2N, 8N
11	R66421 Basic Carburetor Kit - Includes: Gaskets, Throttle Shaft, Needle & Seat (Viton), Shaft Seals, Float Pin, Screws		(NAA, Jubilee, 600, 700 ->57)
12	R66893 Complete Carburetor Kit - Includes: Basic Kit plus Choke Shaft, Spring, Adjusting Needles, Main Nozzle		9N, 2N, 8N
13	R66892 Complete Carburetor Kit - Includes: Basic Kit plus Choke Shaft, Spring, Adjusting Needles, Main Nozzle		(NAA, Jubilee, 600, 700 ->58)
13	R61788 Fuel Filter - Diesel	309991 86546599	601, 701, 801, 901, 2000, 4000
13	R70536 Fuel Filter - Diesel	CAPN99162A	6000

F3_b

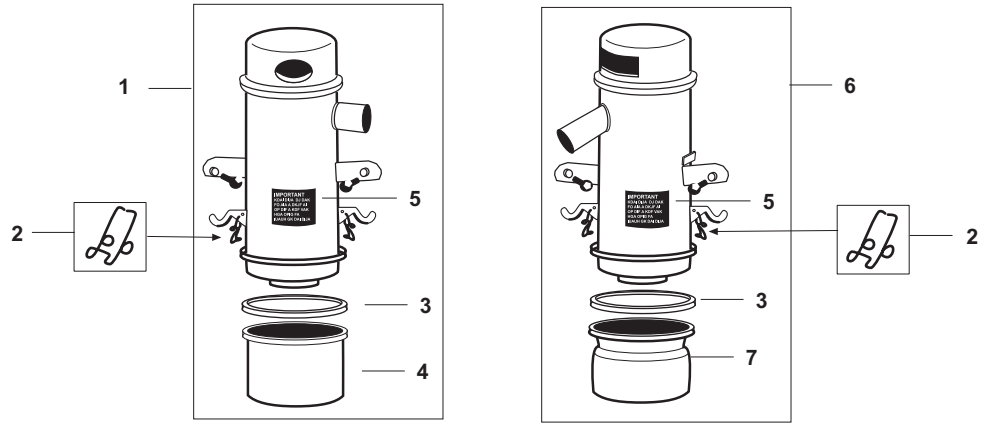

Air Cleaners and Related Components (4 Cylinder - 1939-1964)

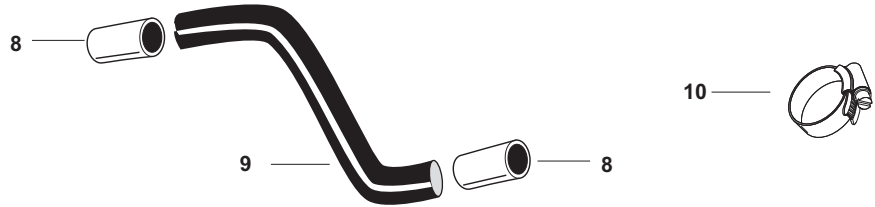

OUR #	DESCRIPTION	EQUIVALENT	TRACTOR MODEL	
1	R61620	Air Cleaner Assembly	8N9600B	8N
2	R61646	Spring Clip	9N9678	(8N, NAA, Jubilee, 600, 700, 800, 900 ->58)
3	R61647	Gasket	9N9623B	8N
4	R61648	Cup	311507	8N
5	R66624	Decal - Air Cleaner Instruction		(8N, NAA, Jubilee, 600, 700, 800, 900 ->58)
6	R60578	Air Cleaner Assembly	312917 EAE9600D	NAA, Jubilee, 600
6	R60582	Air Cleaner Assembly	C7NN9600J 312918	700, 800, 900
7	R60583	Cup	B5NN9658A	(NAA, Jubilee, 600, 700, 800, 900 ->58)
8	R60595	Air Cleaner Hose	9N9652	(9N, 2N, 8N, NAA, Jubilee, 600, 700, 800, 900 ->58)
9	R60603	Air Cleaner Tube	9N18215C	9N, 2N, 8N
10	R04330	Clamp - Air Cleaner Hose	107325 81811886	Fits R60595

F3_b

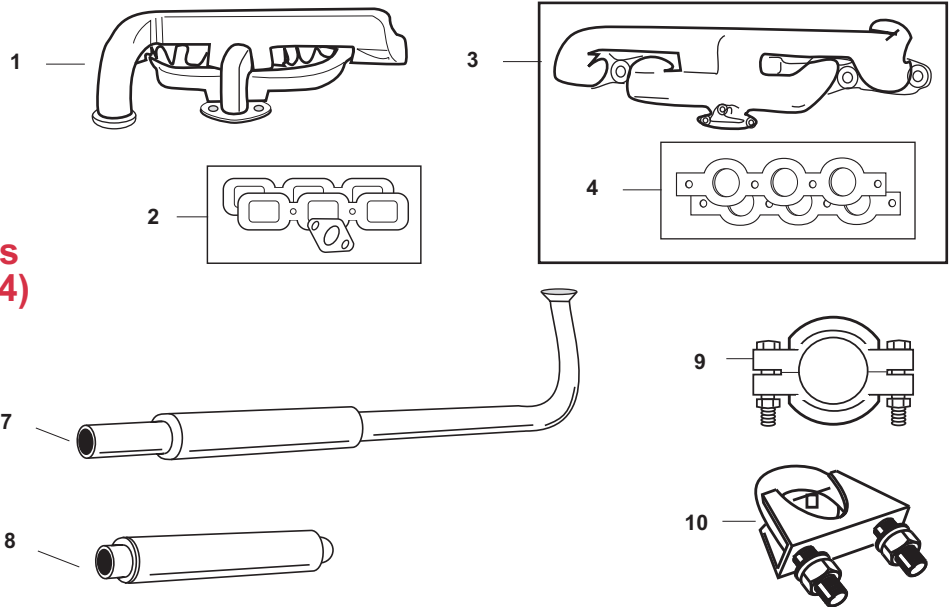

Manifolds and Mufflers (4 Cylinder - 1939-1964)

OUR #	DESCRIPTION	EQUIVALENT	TRACTOR MODEL
1	R60607 Manifold (Less Gaskets)	9N9425	9N, 2N, 8N
2	R60613 Manifold Gasket Set	9N9448 9N9447	9N, 2N, 8N
3	R60699 Manifold w/ Gasket - Gas	B9NN9425A	NAA, Jubilee, 600, 700, 800, 900, 601, 701, 801, 901, 2000, 4000
4	R60307 Manifold Gasket - Gas	C0NN9448C	Same As Above
5	R60089 Elbow w/ Gasket	310075	801, 901, 4000
6	R60309 Gasket	NAA55232A	NAA, Jubilee, 600, 700, 800, 900, 601, 701, 2000
6	R60306 Gasket	310074	801, 901, 4000
7	R60445 Muffler	8N5230	9N, 2N, 8N
8	R61355 Muffler - 1 5/8" Inlet 1 3/4" Inlet End, OD 1 11/16" Outlet End, OD	NAA5230E	NAA, Jubilee, 600, 700, 800, 900, 601, 701, 2000
8	R61533 Muffler - 2" Inlet 2 1/8" Inlet End, OD 1 7/8" Outlet End, OD	310079	801, 901, 4000
9	R60654 Muffler Clamp	CAPN5200A	9N, 2N, 8N
10	R08872 Muffler Clamp - 1 1/8"		
10	R08873 Muffler Clamp - 1 1/4"		
10	R08874 Muffler Clamp - 1 3/8"		
10	R08875 Muffler Clamp - 1 1/2"		
10	R08876 Muffler Clamp - 1 5/8"		
10	R08877 Muffler Clamp - 1 11/16"		
10	R08878 Muffler Clamp - 1 3/4"		
10	R08879 Muffler Clamp - 1 7/8"		
10	R08880 Muffler Clamp - 2"		
10	R06314 Muffler Clamp - 2 1/8"		



**Overhaul Kits,
Piston, Rings
and Liners
(Fordson Major,
Power Major,
Super Major)**

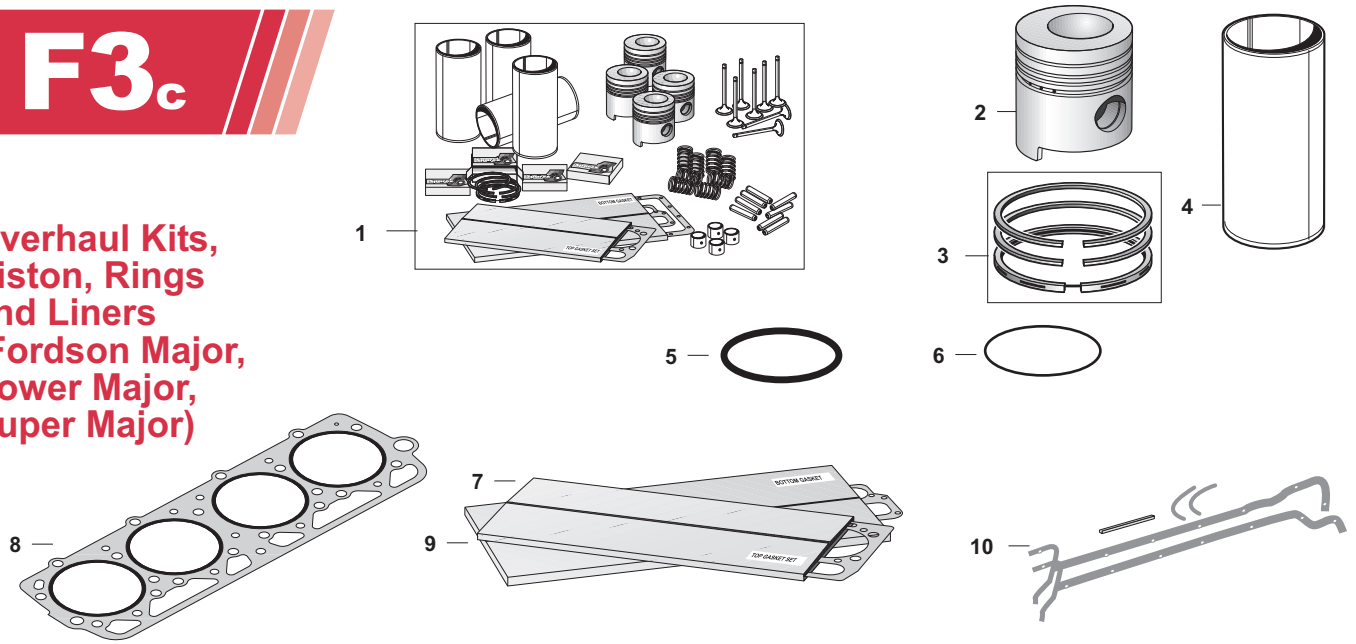

OUR #	DESCRIPTION	EQUIVALENT	TRACTOR MODEL
1	R66816 Overhaul Kit w/ Valve Train (1 1/4" Piston Pin - No O-Ring top of liner) Contains: Pistons, Rings, Liners, Liner Seals, Rod Bushings, Intake & Exhaust Valves, Springs, Valve Springs 8 1/2 Coils, Upper & Lower Gasket Set		(Fordson Major 52-4/57)
1	R66710 Overhaul Kit - Valve springs 8 1/2 Coils (1 3/8" Piston Pin - No O-Ring top of liner) Contains: Same as Above		(Fordson Major, Power Major 4/57-2/61)
1	R66711 Overhaul Kit - Valve Springs 7 Coils (1 3/8" Piston Pin - O-Ring top of liner) Contains: Same as Above		(Fordson Super Major 61-12/64)
2	R66719 Piston (1 1/4" Pin)	E1ADDN6102G	Fordson Major
2	R65958 Piston (1 3/8" Pin)	E1ADDN6102J	Fordson Power Major, Super Major (Use in sets of 4. Do not use with Decompressor or if a total of .010" has been removed from the cylinder block or head 7/1959-1964 After SN 1425097)
3	R65952 Ring Set - 1 Cylinder	510E6148A	Fordson Major, Power Major, Super Major
4	R66374 Liner (4.22/4.23 Top Face Dia) No upper O-Ring	E1ADDN6055B	(Fordson Major, Power Major 52-2/61)
4	R65957 Liner - w/ O-Ring on upper end	E1ADDN6055E	Fordson Super Major
5	R66563 Liner Seal - Lower (4.2" ID)	E1ADKN6061A	(Fordson Major, Power Major 52-2/61)
5	R66045 Liner Seal - Lower (5mm)	116534ESA	(Fordson Super Major 2/61-12/64)
6	R66048 Liner Seal - Upper (2.5mm)	116533ESA	(Fordson Super Major 2/61-12/64)
7	R66336 Upper Gasket Set w/ Head Gasket	E1ADDN6C037C	Fordson Major, Power Major, Super Major
8	R65881 Head Gasket	E1ADDN6051C	Fordson Major, Power Major, Super Major
9	R66385 Lower Gasket Set	E1ADDN6008AK	Fordson Major, Power Major, Super Major
10	R66337 Pan Gasket Set	E1ADDN6781C	Fordson Major, Power Major, Super Major

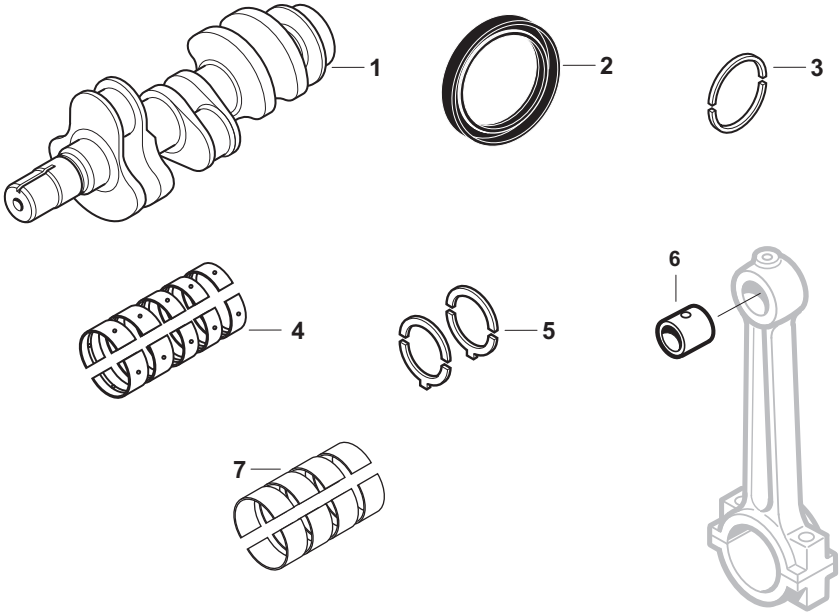

**Crankshaft,
Main Bearings and
Related Components
(Fordson Major,
Power Major,
Super Major)**

OUR #	DESCRIPTION	EQUIVALENT	TRACTOR MODEL
1	R60452 Crankshaft - less Bearing	E1ADDN6303F	Fordson Major, Power Major, Super Major
2	R61431 Seal - Front Crankshaft (89 x 62 x 12 mm)	E1ADKN6362A	(Fordson Major 52-9/54)
2	R61432 Seal - Front Crankshaft (89 x 65 x 12 mm)	510E6362	(Fordson Major, Power Major, Super Major w/ Narrow Belt 9/54->)
3	R65685 Seal - Rear Crankshaft (2 pcs)	793F6701AAA	Fordson Major, Power Major, Super Major
4	R65213 Main Bearing Set - Standard	528E6K371A	Fordson Major, Power Major, Super Major
4	R65214 Main Bearing Set - .010"	528E6K371B	Fordson Major, Power Major, Super Major
4	R65215 Main Bearing Set - .020"	528E6K371C	Fordson Major, Power Major, Super Major
4	R65216 Main Bearing Set - .030"	528E6K371D	Fordson Major, Power Major, Super Major
4	R65217 Main Bearing Set - .040"	528E6K371E	Fordson Major, Power Major, Super Major
5	R66783 Thrust Washer Set - Standard	E159Z9	Fordson Major, Power Major, Super Major
6	R65235 Bushing - Connecting Rod (1.503" OD x 1 3/8" ID x 1.475 long)	E1ADDN207	(Fordson Major, Power Major, Super Major 4/57->)
7	R65189 Rod Bearing Set - Standard	703F6211BAA	Fordson Major, Power Major, Super Major
7	R65190 Rod Bearing Set - .010"	703F6211BBA	Fordson Major, Power Major, Super Major
7	R65191 Rod Bearing Set - .020"	703F6211BCA	Fordson Major, Power Major, Super Major
7	R65192 Rod Bearing Set - .030"	703F6211BDA	Fordson Major, Power Major, Super Major
7	R65193 Rod Bearing Set - .040"	703F6211BEA	Fordson Major, Power Major, Super Major

F3_c

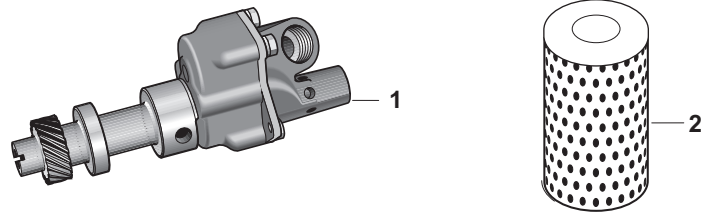

Oil, Fuel Pumps, Filters and Related Components (Fordson Major, Power Major, Super Major)

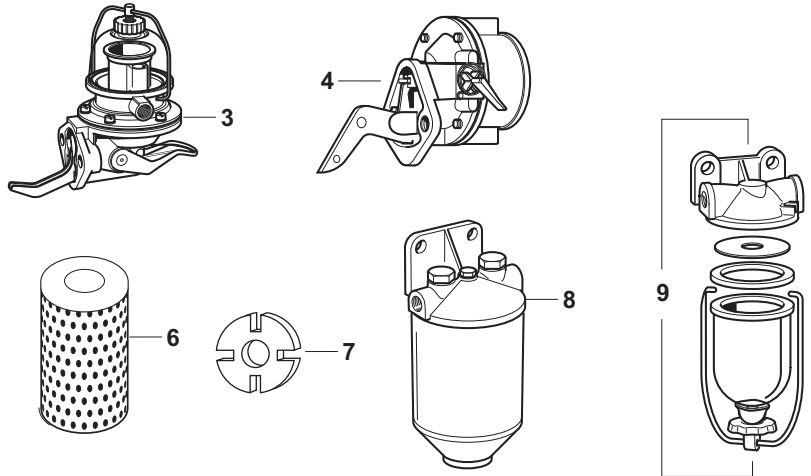

OUR #	DESCRIPTION	EQUIVALENT	TRACTOR MODEL
1	R65878 Oil Pump w/ Relief Valve	528E6600	(Fordson Major, Power Major, Super Major 4/57-12/64) Note: R65878. When replacing oil pump in engine prior to SN 1599502 you must replace auxiliary driveshaft with E96-CP9. On engines after SN 1599501 use driveshaft E94-CP5.
2	R40535 Oil Filter - Cartridge (6" x 2 3/4" Dia x 1 5/16" ID)	EPN6731A	(Fordson Major, Power Major 52-12/58)
2	R40537 Oil Filter - Cartridge (4 1/2" x 2 13/16" Dia x 13/16" ID)	957E6731A	(Fordson Power Major, Super Major 59-64)
3	R66105 Fuel Lift Pump w/ Glass Sediment Bowl	E1ADKN9350B	(Fordson Major, Power Major 52-8/61)
4	R65282 Fuel Lift Pump	E1ADDN9350	(Fordson Super Major 8/61-64)
5	R65284 Repair Kit - Lift Pump	E41Z9	Fordson Major, Power Major
6	R61430 Fuel Filter Element	EPN99162A	Fordson Major, Power Major, Super Major
7	R66550 Pad - Injector Pump Drive	E1ADDN993184	Fordson Major, Power Major, Super Major
8	R65812 Fuel Filter Assembly	E1ADDN9155C	(Fordson Super Major 8/61-64)
9	R65801 Fuel Sediment Bowl Assembly	510E9155E	(Fordson Super Major 8/61-64)

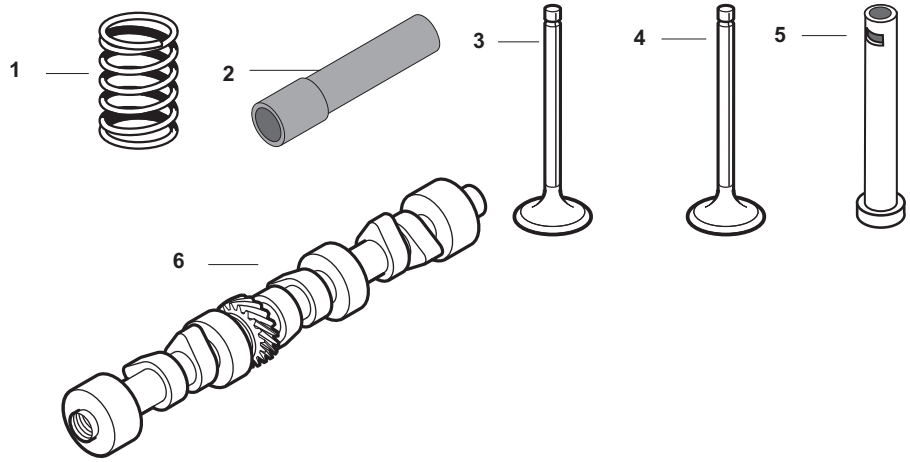

**Valves and Camshaft
(Fordson Major,
Power Major,
Super Major)**

OUR #	DESCRIPTION	EQUIVALENT	TRACTOR MODEL
1	R65708 Spring - 8 1/2 Coils - Early Type	E1ADKN6513B	Fordson Major, Power Major
1	R65709 Spring - 7 Coils - Late Type	E1ADDN6513	(Fordson Super Major 4/61-64)
2	R66779 Guide - Intake/Exhaust	E1ADDN6510A	Fordson Major, Power Major, Super Major
3	R65699 Value - Intake	E1ADDN6507	Fordson Major, Power Major, Super Major
4	R65871 Valve - Exhaust	813F6505DAA	(Fordson Major, Power Major, Super Major 1/53-64)
5	R66712 Tappet	E1ADKN6489B	Fordson Major, Power Major, Super Major
6	R61038 Camshaft w/ 1 Bolt Hole	528E6250D	(Fordson Super Major 4/61-64) Note: When replacing Cam in prior 4/57 tractor, Cam Gear and Tappets must also be replaced.

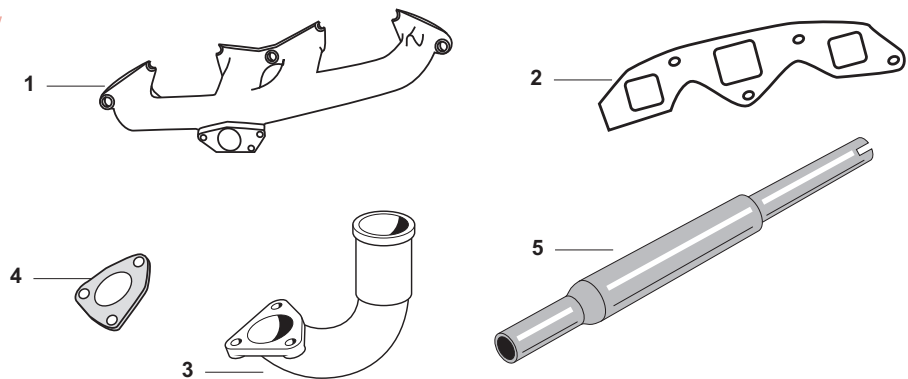

**Exhaust System
(Fordson Major,
Power Major,
Super Major)**

OUR #	DESCRIPTION	EQUIVALENT	TRACTOR MODEL
1	R61645 Manifold w/ Angled Mounting Holes		Fordson Major, Power Major, Super Major
2	R66557 Gasket - Manifold w/ Angled Mounting Holes		Fits R61645 Manifold
3	R15802 Elbow - Exhaust	E1ADKN9488	Fordson Major, Power Major, Super Major
4	R66130 Gasket - Elbow	E1ADKN9450B	Fordson Major, Power Major, Super Major
5	R06305 Muffler	E1ADDN5230A	Fordson Major, Power Major, Super Major