

CONTENTS

SECTION

Description	Page No.	Description	Page No.
ALLEN HEAD SCREWS.....	20	NUTS - METRIC - COURSE.....	14,16
BOLTS - MACHINE SCREW THREAD	17	NUTS - METRIC - FINE.....	15
BOLTS - METRIC COURSE	13,14,16	NUTS - SELF LOCKING - COURSE	14,16
BOLTS - METRIC FINE	15	NUTS - SELF LOCKING - FINE	15
BOLTS - UNC.....	11	NUTS - SELF LOCKING - UNC.....	11
BOLTS - UNF.....	12	NUTS - SELF LOCKING - UNF.....	12
BONDED SEALS	18	NUTS - SLOTTED UNF	12
CABLE TIES	25	NUTS - UNC/UNF	11,12
CASTLE NUTS - METRIC FINE	15	P.T.O. SHAFT LOCKING PINS	4
CASTLE NUTS - UNF.....	12	POP RIVET GUN.....	27
CHAIN REPAIR LINKS	22	POP RIVETS	27
CLAMPS - HOSE.....	21	ROLL PIN PUNCHES	5,8
CLAMPS - MUFFLER.....	21	ROLL PINS - INCH	5,6
CLAMPS - RUBBER LINED	24	ROLL PINS - METRIC	7,8
CLAMPS - WIRE ROPE	24	ROLL PINS - METRIC P.T.O.....	6
CLEVIS PINS - INCH.....	24	ROLLER CHAIN	28
CLEVIS PINS - METRIC.....	24	ROLLER CHAIN - BREAKER.....	29
CLEVISES - STRAIGHT.....	23	ROPE.....	25
CLEVISES - TWISTED	23	SCREWS - ALLEN HEAD.....	20
COLLARS- LOCKING - INCH.....	4	SCREWS - SHEET METAL	20
COLLARS- LOCKING - METRIC.....	4	SHAFT LOCKING PINS.....	4
CORE PLUGS	27	SHEAR BOLTS - BALER.....	28
COTTER PINS.....	3	SHEET METAL SCREWS.....	20
DAMPER - RUBBER	30	SNAP RING PLIERS - EXTERNAL	10
DISPLAY BOARD	1	SNAP RING PLIERS - INTERNAL	9
DRAWBAR HOOK.....	23	SNAP RINGS - EXTERNAL.....	10
E- CIRCLIPS - INCH.....	10	SNAP RINGS - INTERNAL.....	9
E -CIRCLIPS - METRIC.....	10	SNAPHOOKS	22
EXPANSION PLUGS	27	SPIROL PINS - INCH.....	5,6
GIB HEAD KEYS	3	SPRINGS - COMPRESSION.....	4
GRIP CLIPS.....	2	SPRINGS - TENSION.....	4
GROMMETS.....	26	TARP STRAPS - RUBBER.....	25
HOOD CATCHES	26	THIMBLE - WIRE ROPE.....	24
HOOK - DRAWBAR.....	23	THREADED ROD	17
HOOKS - GRAB.....	22	TURNBUCKLES	28
HOOKS - SLIP	22	WASHERS - ALUMINIUM.....	19
HOSE CLAMPS	21	WASHERS - CONICAL.....	19
KEY STEEL - INCH.....	3	WASHERS - COPPER.....	19
KEY STEEL - METRIC.....	3	WASHERS - FLAT	17
LOCKING PINS	4	WASHERS - LOCK.....	17
LYNCH PIN/GRIP CLIP PACKAGE	2	WASHERS - REPAIR.....	17
LYNCH PINS.....	2	WASHERS - SHAKEPROOF - EXTENNAL ..	18
MUFFLER CLAMPS	21	WASHERS - SHAKEPROOF - INTERNAL...18	
NUTS - CASTLE -UNF	12	WASHERS - STARLOCK.....	18
NUTS - HALF LOCKING - UNC.....	11	WASHERS - VALCANIVED FIBER.....	18
NUTS - HALF LOCKING - UNF.....	12	WOODRUFF KEYS	3

All parts shown in this catalog are aftermarket products and are not manufactured by the original equipment manufacturers. Any OEM part numbers shown are for reference only.

While every effort was made to ensure that the information compiled in this catalog is correct, we cannot be held responsible for any errors. Illustrations and technical information is for guidance only and we reserve the right to make modifications and substitutions without prior notice. We request that customers verify that the correct part has been purchased before fitting to a tractor. Normally a visual check against the part removed is all that is necessary. The need to carry out these checks is because of the on-going upgrades and modifications which are carried out by the original tractor manufacturer. If the component is a gear or a shaft, then check the number of teeth or splines. If a clutch assembly, check the dimensions and whether the clutch is a dual or split torque. These simple and quick checks may save many hours of frustration and expense.

2 FASTENERS & HARDWARE

What do the catalog symbols mean?



Product supplied in clear clam pack for display

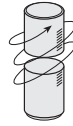

Product available in a twistpak



A selection of product in a resealable black plastic box

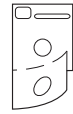

Product available in tear-off format



A larger selection of product in a resealable black plastic box



Product available in dispenser kits for use on display stands



A broad selection of product in a large, sturdy metal box



Assorted sizes in a bundle



A small resealable tub



Product available in a sturdy cardboard display box



A large resealable tub

Display

- S.25806** Display Stand with Drawer and perforated back panel (7ft x 4ft x 20")
- S.25828** Stand only
- S.25826** Drawer only
- S.05804** Hook - Peg Board - 4"
- S.05805** Hook - Peg Board - 6"

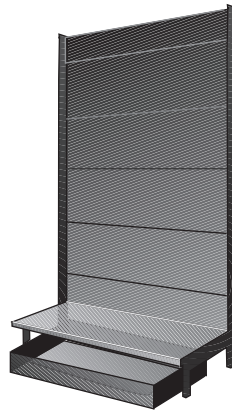

Change Inches to Millimeters:
Multiply Inches by 25.4

Change Millimeters to Inches:
Divide Millimeter by 25.4

Lynch Pins

	A	B	C
S.03545	3/16"	1 1/8"	1 3/8"
S.00037	1/4"	1 7/16"	1 3/4"
S.00038	5/16"	1 7/16"	1 3/4"
S.00036	.354"	1 7/16"	1 3/4"
S.03546	3/8"	1 7/16"	1 3/4"
S.00039*	7/16"	1 13/32"	1 3/4"
H.1924	7/16"	1 5/8"	2"
S.00040	7/16"	17/16"	2"

Heavy Duty/Black

Cat 3

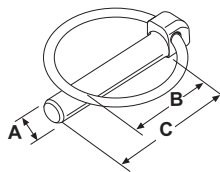

*Most Popular Size

Lynch Pin & Chain Assembly w/ Cotter Key

	A	Chain Length
S.00151	7/16"	10 1/2"

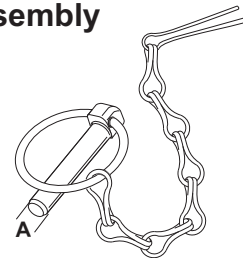

Lynch Pins - Overlock

	A	B	C
S.00041	7/16"	1 3/8"	1 1/2"

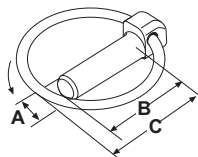

Lynch Pin & Chain Assembly w/ 'S' Hook -

Attaches Cat 1 Top Link Pin

	A	Chain Length
S.00146	1/4"	10 1/2"
S.00148	7/16"	10 1/2"

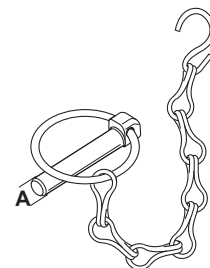

Safety Lynch Pins

(Ring snaps into Pin for positive lock)

	A	B	C	Qty
S.04581	7/16"	1 3/4"	1 7/8"	1
S.04582	7/16"	1 3/4"	1 7/8"	144

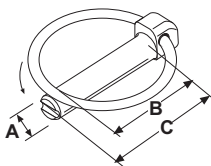

'S' Hook (only) -

Attaches Cat 2 Top Link Pin

S.01050

Lynch Pin & Chain Assembly w/ Lift Arm Bracket

	A	Chain Length	Mounting Holes
S.00030	7/16"	4"	1/4"

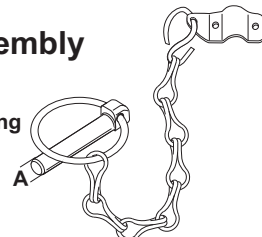

Lynch Pins

	A	B	Pin Head
S.33013	7/16"	2 3/4"	2 1/8"
S.33014	5/8"	2"	2 1/8"

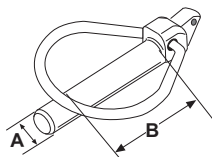

Lynch Pins - Oversize

	A	B	C
S.08460	7/16"	2 3/8"	2 3/4"

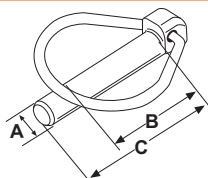

Pipe Lynch Pin

	A	Length
S.12799	3/8"	2 3/8"
S.12794	1/4"	1 9/16"

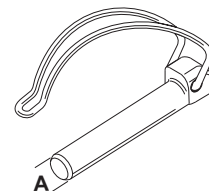

Grip Clips

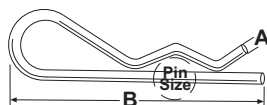

	A	Pin Size	B
S.00008	5/64"	1/4" - 7/16"	1 5/8"
S.00009	3/32"	5/16" - 1/2"	1 11/16"
S.00010	1/8"	3/8" - 11/16"	2 1/2"
S.00012	5/32"	1/2" - 7/8"	3"
S.00011	11/64"	3/8" - 11/16"	4 1/8"
S.00013	3/16"	5/8" - 1 1/16"	4"
S.00014	15/64"	3/4" - 1 1/4"	4 1/2"
S.00015	1/4"	1" - 1 1/2"	6"



	S.02250	S.04575	S.02255	S.68000
25pcs	25pcs	14pcs	12pcs	356pcs
	2	-	-	100
	4	-	-	60
	5	4	4	60
	10	8	8	100
	-	-	-	-
	2	2	-	20
	2	-	-	10
	-	-	-	6

Lynch Pins/Grip Clips

(50 pcs per pack, order in multiples of 10 packs)

S.13447

Contains: Grip Clips

- 5/64" S.00008 x 5
- 1/8" S.00010 x 10
- 5/32" S.00012 x 10
- 3/16" S.00013 x 5

Lynch Pins

- 1/4" S.00037 x 5
- 3/8" S.03546 x 5
- 7/16" S.00039 x 10

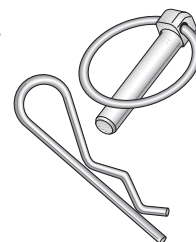

2 FASTENERS & HARDWARE

Cotter Pins

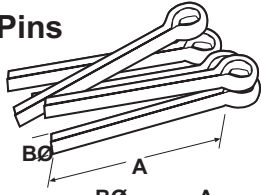

			INCH			
	BØ	A	50pcs	55pcs	290pcs	510pcs
S.01516	1/16"	x 1 1/2"	10	10	50	-
S.01495	3/32"	x 3/4"	-	10	-	50
S.01496	3/32"	x 1"	-	-	50	50
S.01497	3/32"	x 1 1/2"	8	5	50	20
S.01498	1/8"	x 1"	-	10	50	50
S.01499	1/8"	x 1 1/4"	-	-	-	50
S.01500	1/8"	x 1 1/2"	10	5	50	50
S.01501	5/32"	x 1 1/2"	8	10	-	20
S.01502	3/16"	x 1 1/2"	-	-	-	60
S.01503	3/16"	x 2"	6	5	20	60
S.01504	3/16"	x 3"	-	-	-	-
S.01505	1/4"	x 1 1/2"	-	-	-	30
S.01506	1/4"	x 2"	-	-	10	30
S.01507	1/4"	x 3"	4	-	5	-
S.01508	5/16"	x 2"	-	-	-	20
S.01509	5/16"	x 2 1/2"	-	-	-	20
S.01510	5/16"	x 3"	4	-	5	-

Woodruff Keys

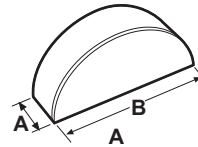

			INCH	
	A	B	184pcs	
S.02904	3/32"	x 1/2"	10	
S.02905	1/8"	x 1/2"	10	
S.02906	1/8"	x 5/8"	10	
S.02907	1/8"	x 3/4"	10	
S.02908	5/32"	x 3/4"	10	
S.02909	5/32"	x 7/8"	10	
S.02910	3/16"	x 5/8"	10	
S.02911	3/16"	x 3/4"	10	
S.02912	3/16"	x 7/8"	10	
S.02913	3/16"	x 1"	10	
S.02914	1/4"	x 3/4"	10	
S.02915	1/4"	x 7/8"	10	
S.02916	1/4"	x 1"	10	
S.02917	1/4"	x 1 1/8"	10	
S.02918	1/4"	x 1 1/4"	5	
S.02919	1/4"	x 1 1/2"	4	
S.02920	5/16"	x 1"	10	
S.02921	5/16"	x 1 1/8"	10	
S.02922	5/16"	x 1 1/4"	5	
S.65093	5/16"	x 1 1/2"	-	
S.02923	3/8"	x 1 1/4"	5	
S.02924	3/8"	x 1 3/8"	5	

Key Steel

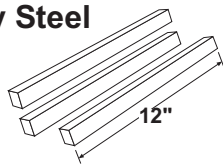

			INCH	
			19 pcs	10pcs
S.01350	3/16"	x 3/16"	4	1
S.01351	1/4"	x 1/4"	4	1
S.01352	5/16"	x 5/16"	4	1
S.01353	3/8"	x 3/8"	4	1
S.01354	7/16"	x 7/16"	1	1
S.01355	1/2"	x 1/2"	1	2
S.01357	3/4"	x 3/4"	1	3

Gib Head Keys

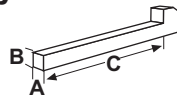

				METRIC	
	A mm	B mm	C mm	40pcs	35pcs
S.11162	6	6	40	5	-
S.11163	6	6	60	5	-
	8	7	40	5	-
	8	7	50	5	-
	8	7	60	5	-
	8	7	80	5	-
	10	8	40	5	-
	10	8	50	5	-
	10	8	60	-	5
	10	8	80	-	5
	12	8	40	-	5
	12	8	60	-	5
	12	8	80	-	5
	12	8	100	-	5
	14	9	80	-	5
	14	9	120	-	-

Woodruff Keys

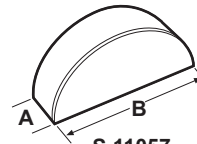

			METRIC	
	A mm	B mm	95pcs	
S.11057	3	x 5	10	
S.11058	4	x 5	10	
S.11059	4	x 6.5	10	
S.11060	5	x 9	10	
S.11061	6	x 9	10	
S.11062	6	x 10	10	
S.11063	6	x 11	10	
S.11064	8	x 11	10	
S.11065	8	x 13	5	
S.11066	10	x 11	5	
S.11067	10	x 13	5	

Key Steel

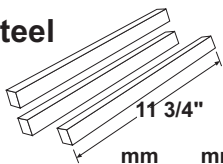

			METRIC	
	mm	mm	9pcs	
S.03481	4	x 4	1	
S.03482	5	x 5	1	
S.03483	6	x 6	1	
S.03484	7	x 8	-	
S.03485	8	x 10	1	
S.08394	10	x 12	1	
S.03486	12	x 12	1	
S.03487	14	x 14	1	
S.03488	16	x 16	1	
S.03489	18	x 18	1	

Gib Head Keys

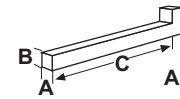

				INCH	
	A	B	C	54pcs	
S.03690	3/16"	3/16"	2 1/2"	10	
S.03691	1/4"	3/16"	2 1/2"	1	
S.03692	1/4"	1/4"	2 1/2"	-	
S.03693	5/16"	1/4"	2 1/2"	1	
S.03694	5/16"	5/16"	3"	5	
S.03695	3/8"	5/16"	3"	5	
S.03696	3/8"	3/8"	3"	5	
S.03697	7/16"	7/16"	3 1/2"	5	
S.03698	1/2"	1/2"	3 1/2"	2	

P.T.O. Shaft Locking Pins

INCH

Ideal for securing shafts of up to 2" / 50mm diameter.
Clip locks firmly over nose end of pin, securely retaining assembly in position on shaft.

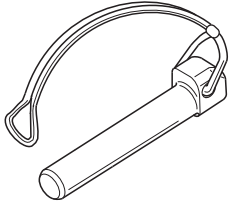

S.00271	A= 1/4"	B=2"	C=1 1/2"
S.00266	A=5/16"	B=2 1/4"	C=1 3/8"
S.00273	A=3/8"	B=2 1/4"	C=1 1/2"
S.00272	A=7/16"	B=3 1/2"	C=2 1/8"
S.00276*	A=5/16"	B=2 1/4"	C=1 5/8"



2	S.11881
2	S.02266
2	S.02273
2	S.11882

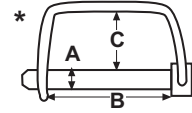
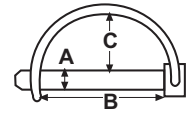

Shaft Locking Collars

INCH

	A	B	C
S.00090	3/16"	1/2"	3/16"
S.00091	1/4"	1/2"	9/32"
S.00092	5/16"	5/8"	5/16"
S.00093	3/8"	3/4"	3/8"
S.00094	7/16"	7/8"	7/16"
S.00095	1/2"	1"	7/16"
S.00096	5/8"	1 1/8"	1/2"
S.00097	3/4"	1 1/4"	9/16"
S.00098	7/8"	1 1/2"	9/16"
S.00099	1"	1 5/8"	5/8"
S.00100	1 1/8"	1 3/4"	13/16"
S.00101	1 1/4"	2"	7/8"
S.00102	1 1/2"	2 1/4"	1"
S.04444	1 3/8"	2 1/8"	7/8"
S.00103	1 3/4"	2 3/4"	7/8"
S.00104	2"	3"	1 1/8"

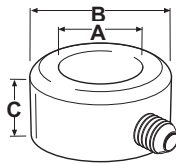

Shaft Locking Collars

METRIC

	A mm	B mm	C mm
S.11012	10	20	10
S.11013	12	22	12
S.11014	15	25	12
S.11015	20	32	14
S.11016	22	36	14
S.11017	25	40	16
S.11018	30	45	16
S.11019	35	56	16
S.11020	40	63	18
S.11021	45	70	18
S.11022	50	80	18
S.11023	60	90	20

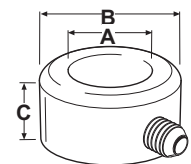

Tension Spring

INCH

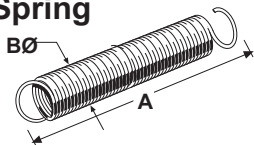

	A ins	B Ø ins	Wire Ø ins	S.11103		S.12999	
				77pcs	147pcs		
S.11092	3 1/2"	1/2"	1/16"	10	15		
S.11093	2 3/8"	11/32"	3/64"	10	20		
S.11094	3 1/2"	19/32"	3/64"	5	10		
S.11095	5 7/8"	9/16"	5/64"	4	8		
S.11096	2"	1/4"	1/32"	10	20		
S.11097	5 3/4"	3/16"	1/64"	5	10		
S.11098	3"	3/8"	3/64"	10	20		
S.11099	1 3/8"	9/32"	3/64"	10	20		
S.11100	4 1/8"	3/4"	5/64"	4	6		
S.11101	5 1/8"	1/2"	3/64"	5	10		
S.11102	2 5/32"	19/32"	5/64"	4	8		

Compression Spring

INCH

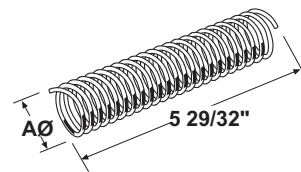

	AØ ins	Wire Ø ins	S.11870
			45pcs
S.11861	5/16"	.036"	5
S.11862	13/32"	.048"	5
S.11863	1/2"	.056"	5
S.11864	1/2"	.064"	5
S.11865	5/8"	.072"	5
S.11866	5/8"	.080"	5
S.11867	3/4"	.092"	5
S.11868	3/4"	.104"	5
S.11869	1"	.128"	5

2 FASTENERS & HARDWARE

Roll Pins - Bulk

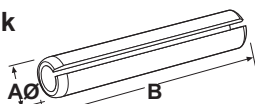

INCH

AØ	B	AØ	B
S.01100	1/16" x 5/8"	S.01129	1/4" x 1 1/2"
S.01101	1/16" x 3/4"	S.01130	1/4" x 1 5/8"
S.01102	1/16" x 1"	S.01131	1/4" x 1 3/4"
S.01103	5/64" x 5/8"	S.01132	1/4" x 1 7/8"
S.01104	5/64" x 3/4"	S.01133	1/4" x 2"
S.01105	5/64" x 1"	S.01134	1/4" x 2 1/4"
S.01106	3/32" x 5/8"	S.01135	1/4" x 2 1/2"
S.01107	3/32" x 3/4"	S.01136	5/16" x 1"
S.01108	3/32" x 1"	S.01137	5/16" x 1 1/4"
S.01152	1/8" x 7/16"	S.01138	5/16" x 1 1/2"
S.01109	1/8" x 5/8"	S.01139	5/16" x 1 3/4"
S.01110	1/8" x 3/4"	S.01140	5/16" x 2"
S.01151	1/8" x 7/8"	S.01141	5/16" x 2 1/4"
S.01111	1/8" x 1"	S.01142	5/16" x 2 1/2"
S.01112	5/32" x 5/8"	S.01143	5/16" x 2 3/4"
S.01113	5/32" x 3/4"	S.01144	5/16" x 3"
S.01114	5/32" x 1"	S.01145	3/8" x 1 1/2"
S.01166	5/32" x 1 1/4"	S.01146	3/8" x 1 3/4"
S.01168	5/32" x 1 3/4"	S.01147	3/8" x 2"
S.01167	3/16" x 1 1/2"	S.01148	3/8" x 2 1/4"
S.01173	3/16" x 5/8"	S.01149	3/8" x 2 1/2"
S.01115	3/16" x 3/4"	S.01150	3/8" x 3"
S.01116	3/16" x 7/8"	S.01153	7/16" x 1 1/2"
S.01117	3/16" x 1"	S.01154	7/16" x 1 3/4"
S.01118	3/16" x 1 1/4"	S.01155	7/16" x 2"
S.01119	3/16" x 1 1/2"	S.01156	7/16" x 2 1/4"
S.01120	3/16" x 1 3/4"	S.01157	7/16" x 2 1/2"
S.01121	3/16" x 2"	S.01158	7/16" x 3"
S.01122	7/32" x 3/4"	S.01160	1/2" x 1 1/2"
S.01123	7/32" x 1"	S.01161	1/2" x 1 3/4"
S.01124	7/32" x 1 1/4"	S.01162	1/2" x 2"
S.01125	7/32" x 1 1/2"	S.01163	1/2" x 2 1/4"
S.01126	1/4" x 1"	S.01164	1/2" x 2 1/2"
S.01127	1/4" x 1 1/4"	S.01165	1/2" x 3"
S.01128	1/4" x 1 3/8"	S.01172	1/2" x 3 1/2"

Spirol Pins - Bulk

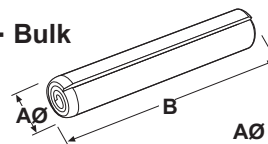

INCH

Total Shear Strength	
Ø	lbs
1/8	2,100
3/16	4,400
1/4	7,700
5/16	11,500
3/8	17,600
7/16	22,500
1/2	30,000
5/32	3,000

AØ	B
S.02788	1/8" x 1"
S.02789	3/16" x 1"
S.02790	3/16" x 1 7/8"
S.02791	1/4" x 1"
S.02792	1/4" x 1 1/2"
S.02793	1/4" x 2"
S.02794	5/16" x 1 1/2"
S.02795	5/16" x 2"
S.02796	5/16" x 2 3/4"
S.02797	3/8" x 1 1/2"
S.02798	3/8" x 2"
S.02799	3/8" x 3"
S.02800	7/16" x 1 1/2"
S.02801	7/16" x 2"
S.02802	7/16" x 3"
S.02803	1/2" x 2"
S.02804	1/2" x 3"

High Quality Roll Pin Punches

Long Shanks, 6 Sided Handle Grip, Dimpled Tip for Centring on Roll Pin



S.06397

9pcs

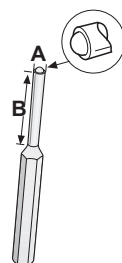

AØ	B
S.06355	1/8" 2.1/8"
S.06356	5/32" 2.1/8"
S.06357	3/16" 2.1/8"
S.06358	7/32" 2.1/8"
S.06359	1/4" 2.1/8"
S.06360	5/16" 2.1/8"
S.06361	3/8" 2.5/8"
S.06362	7/16" 2.5/8"
S.06363	1/2" 2.5/8"

1
1
1
1
1
1
1
1
1

Roll Pin

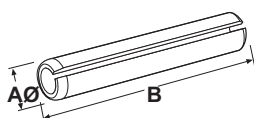

Total Shear Strength	
Ø	lbs
1/16	425
5/64	610
3/32	950
1/8	1,900
5/32	3,000
3/16	4,400
7/32	5,700
1/4	7,700
5/16	11,500
3/8	17,800
7/16	20,000
1/2	23,000

Additional shear strength can be obtained by inserting a second and smaller pin inside the first. To make insertion possible the hole size should be made slightly larger. The above table shows the Roll Pins that can be paired and drill size to be used.

Inner		Outer		Drill Size ins	Total Shear Strength lbs
S.01103	5/64 x 5/8	S.01109	1/8 x 5/8	.138	2,590
S.01104	5/64 x 3/4	S.01110	1/8 x 3/4	.138	2,590
S.01105	5/64 x 1	S.01111	1/8 x 1	.138	2,590
S.01106	3/32 x 5/8	S.01112	5/32 x 3/8	.161	3,960
S.01107	3/32 x 3/4	S.01113	5/32 x 3/4	.161	3,960
S.01108	3/32 x 1	S.01114	5/32 x 1	.161	3,960
S.01110	1/8 x 3/4	S.01122	7/32 x 3/4	.224	7,680
S.01111	1/8 x 1	S.01123	7/32 x 1	.224	7,680
S.01114	5/32 x 1	S.01126	1/4 x 1	.256	10,700
S.01117	3/16 x 1	S.01136	5/16 x 1	.319	16,000
S.01118	3/16 x 1 1/4	S.01137	5/16 x 1 1/4	.319	16,000
S.01119	3/16 x 1 1/2	S.01138	5/16 x 1 1/2	.319	16,000
S.01120	3/16 x 1 3/4	S.01139	5/16 x 1 3/4	.319	16,000
S.01121	3/16 x 2	S.01140	5/16 x 2	.319	16,000
S.01125	7/32 x 1 1/2	S.01145	3/8 x 1 1/2	.382	23,500
S.01138	5/16 x 1 1/2	S.01160	1/2 x 1 1/2	.512	36,600
S.01139	5/16 x 1 3/4	S.01161	1/2 x 1 1/4	.512	36,600
S.01140	5/16 x 2	S.01162	1/2 x 2	.512	36,000
S.01141	5/16 x 2 1/4	S.01163	1/2 x 2 1/4	.512	36,000
S.01142	5/16 x 2 1/2	S.01164	1/2 x 2 1/2	.512	36,000
S.01144	5/16 x 3	S.01165	1/2 x 3	.512	36,000

Roll Pins

INCH

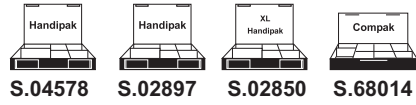
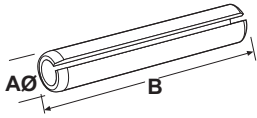

	AØ	B	S.04578 24pcs	S.02897 172pcs	S.02850 70pcs	S.68014 346pcs
S.01102	1/16"	x 1"	2	10	-	-
S.01105	5/64"	x 1"	2	-	-	10
S.01108	3/32"	x 1"	2	-	-	10
S.01109	1/8"	x 5/8"	-	10	-	-
S.01111	1/8"	x 1"	2	10	10	10
S.01114	5/32"	x 1"	2	-	-	10
S.01115	3/16"	x 3/4"	-	10	-	10
S.01117	3/16"	x 1"	-	10	-	10
S.01118	3/16"	x 1 1/4"	-	-	-	2
S.01119	3/16"	x 1 1/2"	-	10	-	10
S.01120	3/16"	x 1 3/4"	-	-	-	2
S.01121	3/16"	x 2"	2	10	10	10
S.01123	7/32"	x 1"	-	-	-	10
S.01124	7/32"	x 1 1/4"	-	-	-	2
S.01125	7/32"	x 1 1/2"	2	-	-	10
S.01126	1/4"	x 1"	-	10	-	10
S.01127	1/4"	x 1 1/4"	-	-	-	4
S.01129	1/4"	x 1 1/2"	-	10	-	10
S.01131	1/4"	x 1 3/4"	-	10	-	10
S.01133	1/4"	x 2"	-	10	-	10
S.01134	1/4"	x 2 1/4"	-	-	-	10
S.01135	1/4"	x 2 1/2"	2	-	10	10
S.01136	5/16"	x 1"	-	10	-	10
S.01137	5/16"	x 1 1/4"	-	-	-	2
S.01138	5/16"	x 1 1/2"	-	9	-	10
S.01139	5/16"	x 1 3/4"	-	7	-	10
S.01140	5/16"	x 2"	-	6	-	10
S.01141	5/16"	x 2 1/4"	-	-	-	10
S.01142	5/16"	x 2 1/2"	-	-	-	10
S.01144	5/16"	x 3"	2	-	10	10
S.01145	3/8"	x 1 1/2"	-	7	-	10
S.01146	3/8"	x 1 3/4"	-	5	-	10
S.01147	3/8"	x 2"	-	5	-	10
S.01148	3/8"	x 2 1/4"	-	-	-	10
S.01149	3/8"	x 2 1/2"	-	-	-	10
S.01150	3/8"	x 3"	2	-	10	10
S.01158	7/16"	x 3"	2	-	10	-
S.01160	1/2"	x 1 1/2"	-	5	-	10
S.01161	1/2"	x 1 3/4"	-	4	-	10
S.01162	1/2"	x 2"	-	4	-	2
S.01163	1/2"	x 2 1/4"	-	-	-	10
S.01164	1/2"	x 2 1/2"	-	-	-	2
S.01165	1/2"	x 3"	2	-	10	10

Roll Pins

INCH

Contains 1 of each popular size

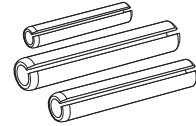

Roll Pin Combination Pack

INCH METRIC

Contains a selection of 24 of the most popular sizes.

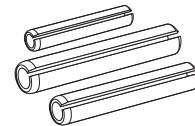

Roll Pins - Metric PTO Yokes

INCH METRIC

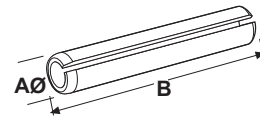

	AØ	B	S.06574 21pcs	S.06531 100pcs
S.01207	8mm	x 50mm	4	20
S.01228	8mm	x 55mm	-	10
S.01230	8mm	x 70mm	-	10
S.01235	10mm	x 65mm	10	20
S.01236	10mm	x 70mm	-	20
S.01237	10mm	x 80mm	6	10
S.01238	10mm	x 90mm	-	6
S.01172	1/2"	x 3 1/2"	2	4

Spirol Pins

INCH

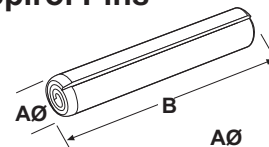

	AØ	B	S.02805 120pcs
S.02788	1/8"	x 1"	10
S.02789	3/16"	x 1"	10
S.02790	3/16"	x 2"	10
S.02791	1/4"	x 1"	10
S.02792	1/4"	x 1 1/2"	10
S.02793	1/4"	x 2"	10
S.02794	5/16"	x 1 1/2"	9
S.02795	5/16"	x 2"	6
S.02796	5/16"	x 2 3/4"	5
S.02797	3/8"	x 1 1/2"	7
S.02798	3/8"	x 2"	5
S.02799	3/8"	x 3"	5
S.02800	7/16"	x 1 1/2"	5
S.02801	7/16"	x 2"	5
S.02802	7/16"	x 3"	5
S.02803	1/2"	x 2"	4
S.02804	1/2"	x 3"	4

2 FASTENERS & HARDWARE

Roll Pins

METRIC

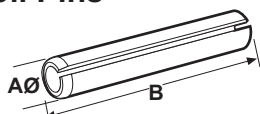

	AØ mm	B mm	AØ mm	B mm
S.01241	2	x 22	S.01207	8 x 50
S.11611	2	x 30	S.01228	8 x 55
S.55129	2	x 40	S.01229	8 x 60
S.55130	2.5	x 30	S.11628	8 x 65
S.55131	3	x 10	S.01230	8 x 70
S.01218	3	x 20	S.55147	8 x 75
S.01219	3	x 22	S.01231	8 x 80
S.01200	3	x 26	S.55148	8 x 90
S.11612	3	x 30	S.11629	8 x 100
S.01201	3	x 32	S.11630	9 x 50
S.11613	3	x 36	S.11631	9 x 60
S.01202	3	x 40	S.11632	9 x 70
S.12242	3.5	x 24	S.11633	9 x 80
S.55132	3.5	x 40	S.55149	9 x 90
S.01208	4	x 10	S.55150	10 x 20
S.01209	4	x 20	S.01232	10 x 40
S.01222	4	x 24	S.55151	10 x 45
S.01210	4	x 30	S.01233	10 x 50
S.01223	4	x 36	S.55152	10 x 55
S.01211	4	x 40	S.01234	10 x 60
S.01212	4	x 45	S.01235	10 x 65
S.01224	4	x 50	S.01236	10 x 70
S.11614	4	x 60	S.01237	10 x 80
S.55133	5	x 10	S.01238	10 x 90
S.55134	5	x 20	S.01239	10 x 100
S.01220	5	x 24	S.11634	10 x 120
S.55135	5	x 28	S.11476	11 x 60
S.01203	5	x 30	S.11477	11 x 70
S.55136	5	x 36	S.11478	11 x 80
S.01204	5	x 40	S.11479	11 x 90
S.01205	5	x 45	S.11480	11 x 100
S.01221	5	x 50	S.55153	12 x 45
S.55137	5	x 55	S.21266	12 x 50
S.11615	5	x 60	S.21257	12 x 60
S.11616	5	x 70	S.11481	12 x 70
S.11617	5	x 80	S.21259	12 x 80
S.11618	6	x 24	S.11482	12 x 90
S.01213	6	x 26	S.01243	12 x 100
S.01225	6	x 30	S.01244	12 x 120
S.01214	6	x 32	S.11483	13 x 50
S.01226	6	x 36	S.11484	13 x 60
S.01215	6	x 40	S.11485	13 x 70
S.01216	6	x 45	S.11486	13 x 80
S.01217	6	x 50	S.11487	13 x 90
S.11619	6	x 60	S.11488	13 x 100
S.11712	6	x 70	S.55154	13 x 120
S.11620	6	x 80	S.11489	14 x 60
S.55138	6	x 90	S.11490	14 x 70
S.55139	6	x 100	S.11491	14 x 80
S.11621	7	x 30	S.11492	14 x 90
S.55143	7	x 36	S.21261	14 x 100
S.11622	7	x 40	S.21260	14 x 120
S.55144	7	x 45	S.11287	14 x 140
S.11623	7	x 50	S.11493	16 x 40
S.55145	7	x 55	S.11494	16 x 50
S.11624	7	x 60	S.11495	16 x 60
S.11625	7	x 70	S.11496	16 x 80
S.11626	7	x 80	S.21263	16 x 100
S.55146	7	x 90	S.21262	16 x 120
S.00248	8	x 28	S.11288	16 x 140
S.11627	8	x 30	S.11289	16 x 160
S.21267	8	x 32	S.11290	18 x 100
S.01227	8	x 40	S.11291	18 x 140
S.01206	8	x 45		

Spirol Pins

METRIC

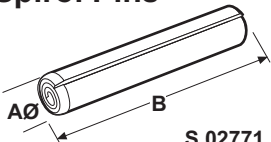

	AØ mm	B mm
S.02771	4	x 24
S.02772	4	x 30
S.02773	4	x 40
S.02774	5	x 24
S.02775	5	x 30
S.02776	5	x 50
S.02777	6	x 30
S.02778	6	x 36
S.02779	6	x 50
S.02780	8	x 40
S.02781	8	x 50
S.02782	8	x 70
S.02783	10	x 50
S.02784	10	x 60
S.02785	10	x 70
S.02786	10	x 80
S.12134	12	x 60
S.12135	12	x 80
S.12136	12	x 90
S.12137	12	x 100
S.12138	14	x 80
S.12139	14	x 90
S.12140	14	x 100

Total Shear Strength

Ø	lbs
4	3,034
5	4,496
6	6,744
8	11,914
10	18,883

Inner Roll Pin Outer Roll Pin

		Drill Size mm	Total Shear Strength Lbs	Kgs		
S.01210	4 x 30	S.01225	6 x 30	6.25	10,300	4,600
S.01223	4 x 36	S.01226	6 x 36	6.25	10,300	4,600
S.01211	4 x 40	S.01215	6 x 40	6.25	10,300	4,600
S.01212	4 x 45	S.01216	6 x 45	6.25	10,300	4,600
S.01224	4 x 50	S.01217	6 x 50	6.25	10,300	4,600
S.01204	5 x 40	S.01227	8 x 40	8.3	16,000	7,200
S.01205	5 x 45	S.01206	8 x 45	8.3	16,000	7,200
S.01221	5 x 50	S.01207	8 x 50	8.3	16,000	7,200
S.55137	5 x 55	S.01229	8 x 60	8.3	16,000	7,200
S.11615	5 x 60	S.01230	8 x 70	8.3	16,000	7,200
S.11616	5 x 70	S.01231	8 x 80	8.3	16,000	7,200
S.11617	5 x 80	S.01232	10x 40	10.3	27,300	12,390
S.11618	6 x 24	S.01233	10x 50	10.3	27,300	12,390
S.01213	6 x 26	S.11619	6 x 60	10.3	27,300	12,390
S.01225	6 x 30	S.11712	6 x 70	10.3	27,300	12,390
S.01214	6 x 32	S.01236	10x 70	10.3	27,300	12,300
S.01226	6 x 36	S.01237	10x 80	10.3	27,300	12,300
S.01215	6 x 40	S.21266	12x 50	12.5	40,124	18,200
S.01216	6 x 45	S.21257	12x 60	12.5	40,124	18,200
S.01217	6 x 50	S.11481	12x 70	12.5	40,124	18,200
S.11619	6 x 60	S.21259	12x 80	12.5	40,124	18,200
S.11712	6 x 70	S.01232	10x 70	10.3	27,300	12,390
S.11620	6 x 80	S.01236	10x 70	10.3	27,300	12,390
S.55138	6 x 90	S.01237	10x 80	10.3	27,300	12,300
S.55139	6 x 100	S.21266	12x 50	12.5	40,124	18,200
S.11621	7 x 30	S.21257	12x 60	12.5	40,124	18,200
S.55143	7 x 36	S.11481	12x 70	12.5	40,124	18,200
S.11622	7 x 40	S.21259	12x 80	12.5	40,124	18,200
S.55144	7 x 45	S.01232	10x 40	10.3	27,300	12,390
S.11623	7 x 50	S.11493	16x 40	16.5	67,820	30,762
S.55145	7 x 55	S.01233	10x 50	10.3	27,300	12,390
S.11624	7 x 60	S.11494	16x 50	16.5	67,820	30,762
S.11625	7 x 70	S.11495	16x 60	16.5	67,820	30,762
S.11626	7 x 80	S.11496	16x 80	16.5	67,820	30,762
S.55146	7 x 90	S.21263	16x 100	16.5	67,820	30,762
S.00248	8 x 28	S.21262	16x 120	16.5	67,820	30,762
S.11627	8 x 30	S.11288	16x 140	16.5	67,820	30,762
S.21267	8 x 32	S.11289	16x 160	16.5	67,820	30,762
S.01227	8 x 40	S.11290	18 x 100	18.5	87,300	39,600
S.01206	8 x 45	S.11291	18 x 140	18.5	87,300	39,600

Total Shear Strength

Ø	lbs
2	610
3	1,850
4	3,000
5	5,000
6	7,300
7	9,200
8	11,000
9	14,330
10	18,000
11	20,282
12	23,403
13	25,875
14	32,530
16	38,442
18	61,730

Additional shear strength can be obtained by inserting a second and smaller pin inside the first. To make insertion possible the hole size should be made slightly larger. The following table shows the Roll Pins that can be paired and drill size to be used.

Roll Pins

METRIC

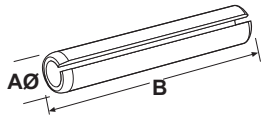

	AØ	B	S.01250 40pcs	S.01251 32pcs	S.02851 60pcs	S.02898 191pcs	S.68015 324pcs
S.01200	3	x 26	1	-	-	10	10
S.01201	3	x 32	1	-	-	-	2
S.01202	3	x 40	1	4	10	10	10
S.01203	5	x 30	1	-	-	10	2
S.01204	5	x 40	1	-	-	10	10
S.01205	5	x 45	1	-	-	10	10
S.01206	8	x 45	1	-	-	7	10
S.01207	8	x 50	1	4	-	7	2
S.01208	4	x 10	1	-	-	-	10
S.01209	4	x 20	1	-	-	10	10
S.01210	4	x 30	1	-	-	10	10
S.01211	4	x 40	1	-	-	10	2
S.01212	4	x 45	1	-	-	10	10
S.01213	6	x 26	1	-	-	-	10
S.01214	6	x 32	1	-	-	-	10
S.01215	6	x 40	1	-	-	10	10
S.01216	6	x 45	1	-	-	-	10
S.01217	6	x 50	1	4	10	9	10
S.01218	3	x 20	1	-	-	10	10
S.01219	3	x 22	1	-	-	-	10
S.01220	5	x 24	1	-	-	10	10
S.01221	5	x 50	1	4	10	-	10
S.01222	4	x 24	1	-	-	10	10
S.01223	4	x 36	1	-	-	-	10
S.01224	4	x 50	1	4	10	10	10
S.01225	6	x 30	1	-	-	10	2
S.01226	6	x 36	1	-	-	-	2
S.01227	8	x 40	1	-	-	8	10
S.01228	8	x 55	1	-	-	-	10
S.01229	8	x 60	1	-	-	-	10
S.01230	8	x 70	1	-	-	-	10
S.01231	8	x 80	1	4	10	-	10
S.01232	10	x 40	1	-	-	5	10
S.01233	10	x 50	1	-	-	5	10
S.01234	10	x 60	1	-	-	-	10
S.01235	10	x 65	1	-	-	-	10
S.01236	10	x 70	1	-	-	-	10
S.01237	10	x 80	1	4	-	-	2
S.01239	10	x 100	1	4	10	-	-

Roll Pin Combination Pack

METRIC INCH

Contains a selection of 24 of the most popular sizes.

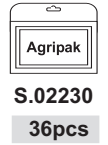
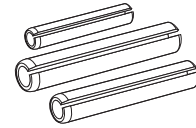

S.02230
36pcs

High Quality Roll Pin Punches

Long Shanks, 6 Sided Handle Grip, Dimpled Tip for Centring on Roll Pin

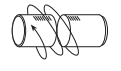
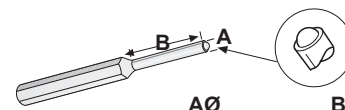

S.06397
9pcs

	AØ	B	
S.06355	1/8"	2.1/8"	1
S.06356	5/32"	2.1/8"	1
S.06357	3/16"	2.1/8"	1
S.06358	7/32"	2.1/8"	1
S.06359	1/4"	2.1/8"	1
S.06360	5/16"	2.1/8"	1
S.06361	3/8"	2.5/8"	1
S.06362	7/16"	2.5/8"	1
S.06363	1/2"	2.5/8"	1

Spirol Pins

METRIC

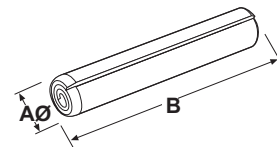

S.02787

	AØ	B	
S.02771	4	x 24	10
S.02772	4	x 30	10
S.02773	4	x 40	10
S.02774	5	x 24	10
S.02775	5	x 30	10
S.02776	5	x 50	10
S.02777	6	x 30	10
S.02778	6	x 36	10
S.02779	6	x 50	10
S.02780	8	x 40	7
S.02781	8	x 50	5
S.02782	8	x 70	5
S.02783	10	x 50	5
S.02784	10	x 60	5
S.02785	10	x 70	5
S.02786	10	x 80	5

2 FASTENERS & HARDWARE

Internal Snap Rings

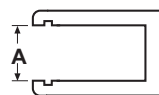

S.04577



S.68047

	A			
	ins	mm	26pcs	330pcs
S.02813	7/16"	11	1	20
S.02814	1/2"	12	1	20
S.02815	9/16"	14	1	20
S.02816	5/8"	16	1	20
S.02817	11/16"	18	1	20
S.02818	3/4"	19	1	20
S.02819	13/16"	21	1	20
S.02820	7/8"	22	1	20
S.02821	15/16"	24	1	20
S.02822	1"	25	1	20
S.02823	1 1/16"	27	1	10
S.02824	1 1/8"	29	1	10
S.02825	1 3/16"	30	1	10
S.02826	1 1/4"	32	1	10
S.02827	1 5/16"	33	1	10
S.02828	1 3/8"	35	1	10
S.02829	1 7/16"	36	1	10
S.02830	1 1/2"	38	1	10
S.02831	1 9/16"	40	1	10
S.02832	1 5/8"	41	1	10
S.02833	1 11/16"	43	1	5
S.02834	1 3/4"	44	1	5
S.02835	1 13/16"	46	1	5
S.02836	1 7/8"	48	1	5
S.02837	1 15/16"	49	1	5
S.02838	2"	51	1	5

Internal Snap Rings - Larger Sizes

S.11266	2 1/8"	54
S.11267	2 1/4"	57
S.11268	2 3/8"	60
S.11269	2 1/2"	63.5
S.11270	2 5/8"	67
S.11271	2 3/4"	70
S.11272	2 7/8"	73
S.11273	3"	76
S.11274	3 1/4"	82
S.11275	3 1/2"	90
S.11276	3 3/4"	95
S.11277	4"	100
S.11278	4 1/4"	108
S.11279	4 1/2"	115
S.11280	4 3/4"	120
S.11281	5"	127
S.11282	5 1/4"	135
S.11283	5 1/2"	140
S.11284	5 3/4"	145
S.11285	6"	150

Internal & External Snap Rings



S.68056

330pcs

ins	mm		
1/2"	12	20	20
5/8"	16	20	20
3/4"	19	20	20
7/8"	22	20	20
1"	25	20	20
1 1/8"	29	10	10
1 1/4"	32	10	10
1 3/8"	35	10	10
1 1/2"	38	10	10
1 5/8"	41	10	10
1 3/4"	44	5	5
1 7/8"	48	5	5
2"	51	5	5

Internal Snap Rings Pliers



S.06349

1

External Snap Rings

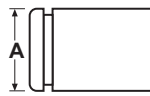

S.04576 **S.68048**

	ins	A mm	26pcs	330pcs
S.02870	7/16"	11	1	20
S.02871	1/2"	12	1	20
S.02872	9/16"	14	1	20
S.02873	5/8"	16	1	20
S.02874	11/16"	18	1	20
S.02875	3/4"	19	1	20
S.02876	13/16"	21	1	20
S.02877	7/8"	22	1	20
S.02878	15/16"	24	1	20
S.02879	1"	25	1	20
S.02880	1 1/16"	27	1	10
S.02881	1 1/8"	29	1	10
S.02882	1 3/16"	30	1	10
S.02883	1 1/4"	32	1	10
S.02884	1 5/16"	33	1	10
S.02885	1 3/8"	35	1	10
S.02886	1 7/16"	36	1	10
S.02887	1 1/2"	38	1	10
S.02888		40	1	10
S.02889	1 9/16"	41	1	10
S.02890		43	1	5
S.02891	1 11/16"	44	1	5
S.02892		46	1	5
S.02893		48	1	5
S.02894	1 7/8"	49	1	5
S.02895		51	1	5

External Snap Rings - Larger Sizes

S.11246	2 1/8"	54
S.11247	2 1/4"	57
S.11248	2 3/8"	60
S.11249	2 1/2"	63.5
S.11250	2 5/8"	67
S.11251	2 3/4"	70
S.11252	2 7/8"	73
S.11253	3"	76
S.11254	3 1/4"	82
S.11255	3 1/2"	90
S.11256	3 3/4"	95
S.11257	4"	100
S.11258	4 1/4"	108
S.11259	4 1/2"	115
S.11260	4 3/4"	120
S.11261	5"	127
S.11262	5 1/4"	135
S.11263	5 1/2"	140
S.11264	5 3/4"	145
S.11265	6"	150

E - Circlips

INCH

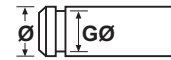
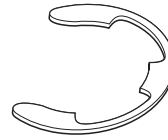

S.12095

	Ø ins	GØ ins	500pcs
S.11894	1/4"	0.210	100
S.11895	5/16"	0.250	100
S.11896	3/8"	0.303	100
S.11897	7/16"	0.343	50
S.11898	1/2"	0.396	50
S.11899	5/8"	0.485	40
S.11900	3/4"	0.580	30
S.11901	7/8"	0.675	30

METRIC

E - Circlips

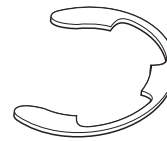

S.12096

	Ø mm	GØ mm	500pcs
	6	4.0	100
	7	5.0	100
	8	6.0	100
	9.5	7.0	50
	10.5	8.0	50
	12	9.0	40
	13	10.0	30
	15.5	12.0	30

External Snap Ring Pliers



S.06350

1

2 FASTENERS & HARDWARE

Bolts & Setscrews Grade 5

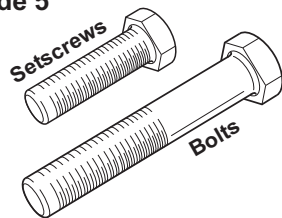

Bolts	Setscrews	UNC
-	S.08786	1/4 x 1/2
-	S.08787	1/4 x 5/8
-	S.08788	1/4 x 3/4
-	S.08789	1/4 x 7/8
-	S.04919	1/4 x 1
S.08790	-	1/4 x 1 1/4
S.53754	S.04920	1/4 x 1 1/2
S.51800	-	1/4 x 1 3/4
S.53755	S.04921	1/4 x 2
S.51801	-	1/4 x 3
-	S.08791	5/16 x 1/2
-	S.08792	5/16 x 5/8
-	S.08793	5/16 x 3/4
-	S.08794	5/16 x 7/8
-	S.04922	5/16 x 1
S.08795	-	5/16 x 1 1/4
S.53756	S.04923	5/16 x 1 1/2
S.51802	-	5/16 x 1 3/4
S.53757	S.04924	5/16 x 2
S.51803	-	5/16 x 2 1/4
S.04925	-	5/16 x 2 1/2
S.51804	-	5/16 x 3 1/4
S.53758	-	5/16 x 3 1/2
S.53759	-	5/16 x 4
-	S.08796	3/8 x 1/2
-	S.08797	3/8 x 5/8
-	S.08798	3/8 x 3/4
-	S.08799	3/8 x 7/8
-	S.04926	3/8 x 1
-	S.08800	3/8 x 1 1/4
S.53760	S.04927	3/8 x 1 1/2
S.51805	-	3/8 x 1 3/4
S.53761	S.04928	3/8 x 2
S.51806	-	3/8 x 2 1/4
S.04929	-	3/8 x 2 1/2
S.51807	-	3/8 x 2 3/4
S.04930	-	3/8 x 3
S.53762	-	3/8 x 3 1/2
S.53763	-	3/8 x 4
S.53764	-	3/8 x 4 1/2
S.53765	-	3/8 x 5
-	S.08801	7/16 x 3/4
-	S.08802	7/16 x 7/8
-	S.08803	7/16 x 1
-	S.08804	7/16 x 1 1/4
S.53766	S.04931	7/16 x 1 1/2
S.51808	-	7/16 x 1 3/4
S.53767	S.04932	7/16 x 2
S.53768	-	7/16 x 2 1/4
S.04933	-	7/16 x 2 1/2
S.53769	-	7/16 x 2 3/4
S.04934	-	7/16 x 3
S.53770	-	7/16 x 3 1/2
-	S.08805	1/2 x 3/4
-	S.08806	1/2 x 7/8
-	S.08807	1/2 x 1
-	S.08938	1/2 x 1 1/4

UNC

Bolts	Setscrews	UNC
-	S.04935	1/2 x 1 1/2
S.08939	-	1/2 x 1 3/4
S.53771	S.04936	1/2 x 2
S.51809	-	1/2 x 2 1/4
S.04937	-	1/2 x 2 1/2
S.51810	-	1/2 x 2 3/4
S.04938	-	1/2 x 3
S.51811	-	1/2 x 3 1/4
S.53772	-	1/2 x 3 1/2
S.04939	-	1/2 x 4
S.53773	-	1/2 x 4 1/2
S.51813	-	1/2 x 5
S.53774	-	1/2 x 6
-	S.08940	9/16 x 1
-	S.08941	9/16 x 1 1/4
-	S.08942	9/16 x 1 1/2
-	S.51816	9/16 x 1 3/4
S.51817	-	9/16 x 2
S.51818	-	9/16 x 2 1/2
S.53776	-	9/16 x 3
-	S.08943	5/8 x 1
-	S.08944	5/8 x 1 1/4
-	S.04851	5/8 x 1 1/2
-	S.08945	5/8 x 1 3/4
S.53777	S.04940	5/8 x 2
S.51819	-	5/8 x 2 1/4
S.04941	-	5/8 x 2 1/2
S.51820	-	5/8 x 2 3/4
S.04942	-	5/8 x 3
S.51821	-	5/8 x 3 1/4
S.51822	-	5/8 x 3 1/2
S.04943	-	5/8 x 4
S.51824	-	5/8 x 4 1/2
S.51825	-	5/8 x 5
S.53778	-	5/8 x 6
S.53779	-	5/8 x 7
S.53780	-	5/8 x 8
-	S.08946	3/4 x 1 1/2
-	S.08947	3/4 x 1 3/4
S.04853	-	3/4 x 2
S.51826	-	3/4 x 2 1/4
S.51827	-	3/4 x 2 1/2
S.51828	-	3/4 x 2 3/4
S.04944	-	3/4 x 3
S.51829	-	3/4 x 3 1/4
S.51830	-	3/4 x 3 1/2
S.04945	-	3/4 x 4
S.51831	-	3/4 x 4 1/2
S.04946	-	3/4 x 5
S.04947	-	3/4 x 6
S.53781	-	3/4 x 7
S.53782	-	3/4 x 8
-	S.51832	7/8 x 2
-	S.51242	7/8 x 2 1/2
S.51833	-	7/8 x 3
S.51834	-	7/8 x 3 1/2
S.51835	-	7/8 x 4
S.53783	-	7/8 x 5
-	S.51836	1 x 2
-	S.51837	1 x 2 1/2
S.51838	-	1 x 3
S.51839	-	1 x 3 1/2
S.51840	-	1 x 4
S.19307	-	1 x 5
S.19308	-	1 x 5 1/2
S.53784	-	1 x 6
S.19309	-	1 x 6 1/2

UNC

Hexagon Nuts Grade 5

UNC



S.53832	3/16"
S.01821	1/4"
S.01823	5/16"
S.01825	3/8"
S.01827	7/16"
S.01829	1/2"
S.01048	9/16"
S.01010	5/8"
S.01027	3/4"
S.01061	7/8"
S.51882	1"
S.01016	1 1/8"

Hexagon Lock Half Nuts Grade 5

UNC

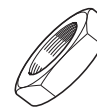

S.01833	5/16"
S.01835	3/8"
S.01008	3/4"
S.01007	7/8"
S.01039	1"
S.01003	1 1/8"

Self Locking Nuts - Nylon Ring Grade 5

UNC



S.03593	7/32"
S.03586	1/4"
S.03588	5/16"
S.04963	3/8"
S.04964	7/16"
S.04965	1/2"
S.04966	5/8"
S.04967	3/4"
S.04860	7/8"
S.04861	1"

Bolts & Setscrews Grade 5

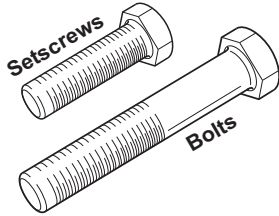

Bolts	Setscrews	UNF
-	S.08606	1/4 x 1/2
-	S.08752	1/4 x 5/8
-	S.08753	1/4 x 3/4
-	S.04890	1/4 x 1
S.08756	-	1/4 x 1 1/4
-	S.04891	1/4 x 1 1/2
S.51850	-	1/4 x 1 3/4
S.53786	S.04892	1/4 x 2
S.08607	-	1/4 x 2 1/4
S.05123	-	1/4 x 2 1/2
S.05124	S.08608	1/4 x 3
S.53787	-	1/4 x 4
-	S.08609	5/16 x 1/2
-	S.08759	5/16 x 5/8
-	S.08760	5/16 x 3/4
-	S.04893	5/16 x 1
S.53788	S.04894	5/16 x 1 1/2
S.51851	-	5/16 x 1 3/4
S.11561	S.04895	5/16 x 2
S.53789	-	5/16 x 2 1/4
S.04896	-	5/16 x 2 1/2
S.05125	-	5/16 x 3
S.53790	-	5/16 x 4
-	S.08764	3/8 x 5/8
-	S.08765	3/8 x 3/4
-	S.08766	3/8 x 7/8
-	S.04897	3/8 x 1
S.08767	-	3/8 x 1 1/4
S.53792	S.04898	3/8 x 1 1/2
S.53793	S.04899	3/8 x 2
S.51853	-	3/8 x 2 1/4
S.04900	-	3/8 x 2 1/2
S.04901	-	3/8 x 3
S.05126	-	3/8 x 3 1/2
S.05127	-	3/8 x 4
-	S.08769	7/16 x 3/4
-	S.08613	7/16 x 1
-	S.08772	7/16 x 1 1/4
-	S.04902	7/16 x 1 1/2
S.14780	-	7/16 x 1 3/4
-	S.04903	7/16 x 2
S.53797	-	7/16 x 2 1/4
S.04904	-	7/16 x 2 1/2
S.01075	-	7/16 x 2 3/4
S.04905	-	7/16 x 3
S.05128	-	7/16 x 3 1/2
S.05129	-	7/16 x 4

UNF

Bolts	Setscrews	UNF
S.51854	-	7/16 x 5
-	S.08616	1/2 x 1
-	S.08776	1/2 x 1 1/4
-	S.04906	1/2 x 1 1/2
-	S.08777	1/2 x 1 3/4
S.53798	S.04907	1/2 x 2
S.51855	-	1/2 x 2 1/4
S.04908	-	1/2 x 1 1/2
S.51856	-	1/2 x 2 3/4
S.04909	-	1/2 x 3
S.05130	-	1/2 x 3 1/2
S.04910	-	1/2 x 4
S.05131	-	1/2 x 4 1/2
S.04850	-	1/2 x 5
S.05132	-	1/2 x 6
-	S.51857	9/16 x 1 1/4
S.08780	-	9/16 x 2
S.51858	-	9/16 x 2 1/2
S.51859	-	9/16 x 3
S.53799	-	9/16 x 3 1/2
S.51860	-	9/16 x 4
-	S.08781	5/8 x 1
-	S.08782	5/8 x 1 1/4
-	S.08783	5/8 x 1 1/2
-	S.08784	5/8 x 1 3/4
S.53800	S.04911	5/8 x 2
S.53801	-	5/8 x 2 1/4
S.04912	-	5/8 x 2 1/2
S.51861	-	5/8 x 2 3/4
S.04913	-	5/8 x 3
S.51862	-	5/8 x 3 1/4
S.04852	-	5/8 x 3 1/2
S.04914	-	5/8 x 4
S.51863	-	5/8 x 4 1/2
S.05133	-	5/8 x 5
S.53802	-	5/8 x 5 1/2
S.08931	-	5/8 x 6
S.53803	-	5/8 x 7
S.11302	-	5/8 x 7 3/4
S.53804	-	5/8 x 8
S.11303	-	5/8 x 8 1/2
-	S.51864	3/4 x 1 1/2
-	S.51865	3/4 x 1 3/4
-	S.08593	3/4 x 2
S.51867	-	3/4 x 2 1/4
-	S.08594	3/4 x 2 1/2
S.51869	-	3/4 x 2 3/4
S.04915	-	3/4 x 3
S.51870	-	3/4 x 3 1/4
S.51871	-	3/4 x 3 1/2
S.04916	-	3/4 x 4
S.51872	-	3/4 x 4 1/2
S.04917	-	3/4 x 5
S.53805	-	3/4 x 5 1/2
S.04918	-	3/4 x 6
S.08592	-	7/8 x 4 1/2
S.54787	-	1 x 3
S.54788	-	1 x 4
S.54789	-	1 x 5

UNF

Hexagon Nuts Grade 5

UNF

S.01070	1/4"
S.01013	5/16"
S.01071	3/8"
S.01072	7/16"
S.01073	1/2"
S.01031	9/16"
S.01002	5/8"
S.01014	3/4"
S.01018	7/8"
S.01017	1"
S.01038	1 1/8"



Hexagon Lock Half Nuts Grade 5

UNF

S.01832	5/16"
S.01783	3/8"
S.01006	7/16"
S.01837	1/2"
S.01009	5/8"
S.01001	3/4"
S.01005	7/8"
S.01004	1"

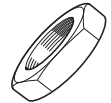

Self Locking Nuts Nylon Ring Grade 5

UNF

S.01012	1/4"
S.03587	5/16"
S.04958	3/8"
S.04959	7/16"
S.04960	1/2"
S.01025	9/16"
S.04961	5/8"
S.04962	3/4"
S.53844	7/8"

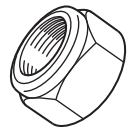

Castle Nut - UNF Fine - Full

UNF

S.08933	5/8"
S.40213	3/4"
S.12973	1"

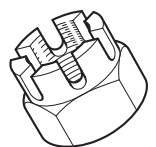

2 FASTENERS & HARDWARE

Bolts & Setscrews

Coarse
Grade 5

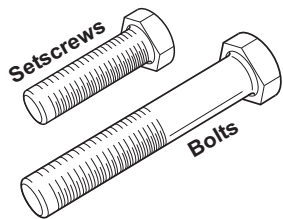

Bolts	Setscrews	Metric
-	S.08634	M4 x 0.7 x 10
-	S.08637	M4 x 0.7 x 16
-	S.08638	M4 x 0.7 x 20
-	S.08639	M4 x 0.7 x 25
-	S.08640	M4 x 0.7 x 30
-	S.08642	M4 x 0.7 x 40
S.53701	-	M4 x 0.7 x 50
-	S.06880	M5 x 0.8 x 10
-	S.06881	M5 x 0.8 x 12
-	S.06883	M5 x 0.8 x 16
-	S.06884	M5 x 0.8 x 20
-	S.06886	M5 x 0.8 x 25
-	S.06887	M5 x 0.8 x 30
-	S.06888	M5 x 0.8 x 35
-	S.06889	M5 x 0.8 x 40
S.06902	-	M5 x 0.8 x 45
-	S.06890	M5 x 0.8 x 50
S.06904	-	M5 x 0.8 x 55
-	S.08646	M5 x 0.8 x 60
S.06907	-	M5 x 0.8 x 70
-	S.08648	M6 x 1.0 x 10
-	S.06891	M6 x 1.0 x 12
-	S.06892	M6 x 1.0 x 14
-	S.06893	M6 x 1.0 x 16
-	S.05756	M6 x 1.0 x 20
-	S.06894	M6 x 1.0 x 22
-	S.06895	M6 x 1.0 x 25
-	S.05757	M6 x 1.0 x 30
-	S.06896	M6 x 1.0 x 35
-	S.05758	M6 x 1.0 x 40
S.06911	-	M6 x 1.0 x 45
S.06912	S.05759	M6 x 1.0 x 50
S.05760	-	M6 x 1.0 x 60
S.06915	-	M6 x 1.0 x 70
S.06916	-	M6 x 1.0 x 75
S.06917	-	M6 x 1.0 x 80
S.06918	-	M6 x 1.0 x 90
S.06919	-	M6 x 1.0 x 100
S.06920	-	M6 x 1.0 x 110
S.06921	-	M6 x 1.0 x 120
-	S.53707	M7 x 1.0 x 20
-	S.53708	M7 x 1.0 x 30

METRIC

Bolts	Setscrews	Metric
-	S.51600	M7 x 1.0 x 35
S.51601	-	M7 x 1.0 x 60
-	S.08649	M8 x 1.25 x 10
-	S.08652	M8 x 1.25 x 16
-	S.08654	M8 x 1.25 x 20
-	S.08621	M8 x 1.25 x 25
S.05761	-	M8 x 1.25 x 30
-	S.08657	M8 x 1.25 x 35
S.54781	S.05762	M8 x 1.25 x 40
S.53711	S.08658	M8 x 1.25 x 45
-	S.05763	M8 x 1.25 x 50
S.06925	-	M8 x 1.25 x 55
S.05764	S.53713	M8 x 1.25 x 60
S.06926	-	M8 x 1.25 x 65
S.05765	-	M8 x 1.25 x 70
-	S.08663	M8 x 1.25 x 75
S.06928	-	M8 x 1.25 x 80
S.06929	-	M8 x 1.25 x 90
S.06930	-	M8 x 1.25 x 100
S.06931	-	M8 x 1.25 x 110
S.06932	-	M8 x 1.25 x 120
S.06933	-	M8 x 1.25 x 130
S.06934	-	M8 x 1.25 x 140
S.06935	-	M8 x 1.25 x 150
-	S.08665	M10 x 1.5 x 12
-	S.08667	M10 x 1.5 x 16
-	S.08669	M10 x 1.5 x 20
-	S.08622	M10 x 1.5 x 25
-	S.05766	M10 x 1.5 x 30
-	S.08672	M10 x 1.5 x 35
S.54782	S.05767	M10 x 1.5 x 40
-	S.08673	M10 x 1.5 x 45
S.05768	S.08674	M10 x 1.5 x 50
S.05769	S.53715	M10 x 1.5 x 60
-	S.08677	M10 x 1.5 x 65
S.05770	-	M10 x 1.5 x 70
S.06940	-	M10 x 1.5 x 75
S.05771	S.53717	M10 x 1.5 x 80
S.06942	-	M10 x 1.5 x 90
S.05772	S.53718	M10 x 1.5 x 100
S.06943	-	M10 x 1.5 x 110
S.06944	-	M10 x 1.5 x 120
S.06945	-	M10 x 1.5 x 130
S.06946	-	M10 x 1.5 x 140
S.06947	-	M10 x 1.5 x 150
S.06948	-	M10 x 1.5 x 160
S.53719	-	M10 x 1.5 x 170
S.06949	-	M10 x 1.5 x 180
S.53720	-	M10 x 1.5 x 190
S.51604	-	M10 x 1.5 x 200
-	S.08683	M12 x 1.75 x 16
-	S.08684	M12 x 1.75 x 20
-	S.08623	M12 x 1.75 x 25
-	S.05773	M12 x 1.75 x 30
-	S.08687	M12 x 1.75 x 35
-	S.05774	M12 x 1.75 x 40
S.53721	S.08688	M12 x 1.75 x 45
S.05775	S.08689	M12 x 1.75 x 50
S.05776	-	M12 x 1.75 x 60
S.06952	-	M12 x 1.75 x 65
S.05777	-	M12 x 1.75 x 70

METRIC

Bolts	Setscrews	Metric
S.06953	-	M12 x 1.75 x 75
S.05778	-	M12 x 1.75 x 80
S.06954	-	M12 x 1.75 x 90
S.05779	-	M12 x 1.75 x 100
S.06955	-	M12 x 1.75 x 110
S.06956	-	M12 x 1.75 x 120
S.06957	-	M12 x 1.75 x 130
S.06958	-	M12 x 1.75 x 140
S.06959	-	M12 x 1.75 x 150
S.06960	-	M12 x 1.75 x 160
S.06961	-	M12 x 1.75 x 180
S.06962	-	M12 x 1.75 x 200
S.06963	-	M12 x 1.75 x 220
S.54784	-	M12 x 1.75 x 240
S.53724	-	M12 x 1.75 x 260
-	S.08700	M14 x 2.0 x 20
-	S.08701	M14 x 2.0 x 25
-	S.08702	M14 x 2.0 x 30
-	S.08703	M14 x 2.0 x 35
-	S.08704	M14 x 2.0 x 40
S.53725	-	M14 x 2.0 x 45
S.06965	-	M14 x 2.0 x 50
S.06966	-	M14 x 2.0 x 55
S.06967	-	M14 x 2.0 x 60
S.06968	-	M14 x 2.0 x 65
S.06969	-	M14 x 2.0 x 70
S.06970	-	M14 x 2.0 x 75
S.06971	-	M14 x 2.0 x 80
S.06972	-	M14 x 2.0 x 90
S.06973	-	M14 x 2.0 x 100
S.06974	-	M14 x 2.0 x 110
S.06975	-	M14 x 2.0 x 120
S.06976	-	M14 x 2.0 x 130
S.06977	-	M14 x 2.0 x 140
S.06978	-	M14 x 2.0 x 150
S.51605	-	M14 x 2.0 x 160
S.51606	-	M14 x 2.0 x 180
S.51607	-	M14 x 2.0 x 200
S.54785	-	M14 x 2.0 x 220
S.54786	-	M14 x 2.0 x 240
-	S.53727	M16 x 2.0 x 20
-	S.08716	M16 x 2.0 x 25
-	-	M16 x 2.0 x 30
-	S.08718	M16 x 2.0 x 35
-	S.08719	M16 x 2.0 x 40
-	S.08720	M16 x 2.0 x 45
-	S.05780	M16 x 2.0 x 50
S.06979	-	M16 x 2.0 x 55
S.06980	-	M16 x 2.0 x 60
S.06981	-	M16 x 2.0 x 65
S.53728	S.05781	M16 x 2.0 x 70
S.06983	-	M16 x 2.0 x 75
S.06984	-	M16 x 2.0 x 80
S.06985	-	M16 x 2.0 x 90
S.05782	-	M16 x 2.0 x 100
S.06986	-	M16 x 2.0 x 110
S.06987	-	M16 x 2.0 x 120
S.06988	-	M16 x 2.0 x 130
S.06989	-	M16 x 2.0 x 140
S.06990	-	M16 x 2.0 x 150
S.06991	-	M16 x 2.0 x 160
S.06993	-	M16 x 2.0 x 200

METRIC

Bolts & Setscrews METRIC

Coarse
Grade 5

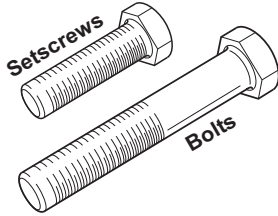

Bolts	Setscrews	Metric
S.51610	-	M16 x 2.0 x 240
S.51611	-	M16 x 2.0 x 260
S.53731	-	M16 x 2.0 x 280
-	S.08730	M18 x 2.5 x 30
-	S.53732	M18 x 2.5 x 35
-	S.08731	M18 x 2.5 x 40
-	S.08732	M18 x 2.5 x 45
-	S.08733	M18 x 2.5 x 50
-	S.08735	M18 x 2.5 x 60
-	S.08736	M18 x 2.5 x 70
S.06997	-	M18 x 2.5 x 80
S.06998	-	M18 x 2.5 x 90
S.08200	S.05783	M18 x 2.5 x 100
S.53735	-	M18 x 2.5 x 110
S.53736	-	M18 x 2.5 x 130
S.08202	-	M18 x 2.5 x 140
S.53737	-	M18 x 2.5 x 150
S.51612	-	M18 x 2.5 x 160
S.51613	-	M18 x 2.5 x 180
S.51614	-	M18 x 2.5 x 200
S.53738	-	M18 x 2.5 x 220
S.53740	-	M18 x 2.5 x 260
S.53741	-	M18 x 2.5 x 280
-	S.08741	M20 x 2.5 x 40
-	S.08743	M20 x 2.5 x 50
-	S.08745	M20 x 2.5 x 60
S.08203	-	M20 x 2.5 x 65
S.08204	-	M20 x 2.5 x 70
S.08205	-	M20 x 2.5 x 75
S.08206	-	M20 x 2.5 x 80
S.08207	-	M20 x 2.5 x 90
S.05784	S.19314	M20 x 2.5 x 100
S.05785	-	M20 x 2.5 x 110
S.08208	-	M20 x 2.5 x 120

METRIC

Bolts	Setscrews	Metric
-------	-----------	--------

S.53742	-	M20 x 2.5 x 140
S.51619	-	M20 x 2.5 x 160
S.51620	-	M20 x 2.5 x 180
S.51621	-	M20 x 2.5 x 200
S.51622	-	M20 x 2.5 x 220
S.51623	-	M20 x 2.5 x 240
S.53743	-	M20 x 2.5 x 260
S.51624	-	M20 x 2.5 x 280
S.51625	-	M20 x 2.5 x 300
-	S.51626	M22 x 2.5 x 50
-	S.51627	M22 x 2.5 x 60
S.51628	-	M22 x 2.5 x 70
S.51629	-	M22 x 2.5 x 80
S.53745	-	M22 x 2.5 x 90
S.51630	-	M22 x 2.5 x 100
S.51631	-	M22 x 2.5 x 120
S.53748	-	M22 x 2.5 x 140
S.53750	-	M22 x 2.5 x 180
-	S.51632	M24 x 3.0 x 40
-	S.51633	M24 x 3.0 x 50
-	S.51634	M24 x 3.0 x 60
-	S.51635	M24 x 3.0 x 70
S.51636	-	M24 x 3.0 x 80
S.51637	-	M24 x 3.0 x 90
S.51638	-	M24 x 3.0 x 100
S.51639	-	M24 x 3.0 x 110
S.51640	-	M24 x 3.0 x 120
S.51641	-	M24 x 3.0 x 130
S.51642	-	M24 x 3.0 x 140
S.51643	-	M24 x 3.0 x 150
S.51644	-	M24 x 3.0 x 160
S.51645	-	M24 x 3.0 x 180
S.51646	-	M24 x 3.0 x 200
S.51647	-	M24 x 3.0 x 220
S.51648	-	M24 x 3.0 x 240
S.51649	-	M24 x 3.0 x 260
S.51650	-	M27 x 3.0 x 100
S.51651	-	M27 x 3.0 x 140
S.51652	-	M27 x 3.0 x 160
S.51653	-	M27 x 3.0 x 200
S.51654	-	M27 x 3.0 x 240
S.51655	-	M27 x 3.0 x 260
-	S.51656	M30 x 3.5 x 60
-	S.51657	M30 x 3.5 x 80
S.53752	-	M30 x 3.5 x 120
S.51659	-	M30 x 3.5 x 140
S.51660	-	M30 x 3.5 x 160
S.51661	-	M30 x 3.5 x 200

Hexagon Nuts METRIC

Coarse



S.01052	M4	x 0.7
S.01053	M5	x 0.8
S.01054	M6	x 1.0
S.01059	M7	x 1.0
S.01055	M8	x 1.25
S.01056	M10	x 1.50
S.01057	M12	x 1.75
S.06811	M14	x 2.0
S.05893	M16	x 2.0
S.05894	M18	x 2.5
S.05895	M20	x 2.5
S.06812	M22	x 2.5
S.06813	M24	x 3.0
S.51881	M27	x 3.0
S.06814	M30	x 3.5
S.53825	M33	x 3.5
S.53826	M36	x 4.0

Nylon Self-Locking Nuts METRIC

Coarse
Grade 5 - Plated

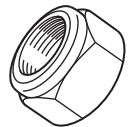

S.53833	M4	x 0.7
S.06815	M5	x 0.8
S.03589	M6	x 1.0
S.53834	M7	x 1.0
S.03590	M8	x 1.25
S.03591	M10	x 1.50
S.03592	M12	x 1.75
S.06816	M14	x 2.0
S.05896	M16	x 2.0
S.05897	M18	x 2.5
S.05898	M20	x 2.5
S.06817	M22	x 2.5
S.06818	M24	x 3.0
S.53835	M27	x 3.0
S.06819	M30	x 3.5

2 FASTENERS & HARDWARE

Bolts & Setscrews

METRIC

Fine
Grade 5
Plated

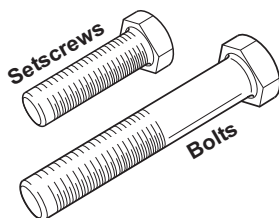

Bolts	Setscrews	Metric
-	S.53806	M8 x 1.00 x 20
-	S.53807	M8 x 1.00 x 30
-	S.54748	M8 x 1.00 x 40
S.53808	-	M8 x 1.00 x 50
-	S.53809	M10 x 1.00 x 30
S.53810	-	M10 x 1.00 x 40
S.53811	-	M10 x 1.00 x 50
S.53812	-	M10 x 1.00 x 60
-	S.51505	M10 x 1.25 x 20
-	S.51506	M10 x 1.25 x 25
-	S.51507	M10 x 1.25 x 30
-	S.51508	M10 x 1.25 x 35
-	S.51509	M10 x 1.25 x 40
S.51511	-	M10 x 1.25 x 50
S.51513	-	M10 x 1.25 x 60
S.51514	-	M10 x 1.25 x 70
S.51515	-	M10 x 1.25 x 80
S.51516	-	M10 x 1.25 x 90
S.51517	-	M10 x 1.25 x 100
-	S.53813	M12 x 1.25 x 30
-	S.53814	M12 x 1.25 x 40
S.53815	-	M12 x 1.25 x 50
S.53816	-	M12 x 1.25 x 80
-	S.51520	M12 x 1.50 x 25
-	S.51521	M12 x 1.50 x 30
-	S.51522	M12 x 1.50 x 40
S.51523	-	M12 x 1.50 x 45
S.51524	-	M12 x 1.50 x 50
S.51525	-	M12 x 1.50 x 55
S.51526	-	M12 x 1.50 x 60
S.51527	-	M12 x 1.50 x 70
S.51528	-	M12 x 1.50 x 80
S.51529	-	M12 x 1.50 x 90
S.51530	-	M12 x 1.50 x 100
S.53817	-	M12 x 1.50 x 120

Bolts	Setscrews	Metric
-	S.53818	M14 x 1.50 x 25
-	S.51531	M14 x 1.50 x 30
-	S.51532	M14 x 1.50 x 40
-	S.51533	M14 x 1.50 x 50
S.51534	-	M14 x 1.50 x 60
S.51535	-	M14 x 1.50 x 70
S.51536	-	M14 x 1.50 x 80
S.51537	-	M14 x 1.50 x 90
S.51538	-	M14 x 1.50 x 100
S.54750	-	M14 x 1.50 x 140
-	S.53819	M16 x 1.50 x 25
-	S.51541	M16 x 1.50 x 30
-	S.51542	M16 x 1.50 x 40
-	S.51543	M16 x 1.50 x 50
S.51544	-	M16 x 1.50 x 60
S.51545	-	M16 x 1.50 x 70
S.51546	-	M16 x 1.50 x 80
S.51547	-	M16 x 1.50 x 90
S.51548	-	M16 x 1.50 x 100
S.53820	-	M16 x 1.50 x 110
S.53821	-	M16 x 1.50 x 120
S.53822	-	M16 x 1.50 x 130
S.14781	-	M16 x 1.50 x 140
-	S.51549	M18 x 1.50 x 40
-	S.51550	M18 x 1.50 x 50
-	S.51551	M18 x 1.50 x 60
S.51552	-	M18 x 1.50 x 70
S.51553	-	M18 x 1.50 x 80
S.51554	-	M18 x 1.50 x 90
S.51555	-	M18 x 1.50 x 100
S.14011	-	M18 x 1.50 x 120
S.14012	-	M18 x 1.50 x 130
S.14013	-	M18 x 1.50 x 150
-	S.53824	M20 x 1.50 x 40
-	S.51566	M20 x 1.50 x 50
-	S.51557	M20 x 1.50 x 60
S.51558	-	M20 x 1.50 x 70
S.51559	-	M20 x 1.50 x 80
S.51560	-	M20 x 1.50 x 90
S.51561	-	M20 x 1.50 x 100
S.51563	-	M20 x 1.50 x 120
S.51565	-	M20 x 1.50 x 140

METRIC

Hexagon Nuts

METRIC

Fine - Grade 5 - Plated



S.51500	M8	x	1.0
S.53827	M10	x	1.0
S.51501	M10	x	1.25
S.53829	M12	x	1.25
S.51502	M12	x	1.50
S.08927	M14	x	1.5
S.11329	M16	x	1.5
S.11507	M18	x	1.5
S.51503	M20	x	1.5
S.53830	M22	x	1.5
S.53831	M24	x	1.5

Nylon Self-Locking Nuts

METRIC

Fine - Grade 5 - Plated



S.53836	M10	x	1.00
S.53837	M10	x	1.25
S.53838	M12	x	1.25
S.53839	M12	x	1.50
S.53840	M14	x	1.5
S.53841	M16	x	1.5
S.53842	M18	x	1.5
S.11497	M20	x	1.5

Castle Nut - Half - Fine

METRIC

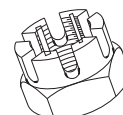

S.53862	M12	x	1.50
S.53863	M14	x	1.50
S.53864	M16	x	1.50
S.53865	M18	x	1.50
S.53866	M20	x	1.50

Castle Nut - Full - Fine

METRIC

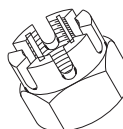



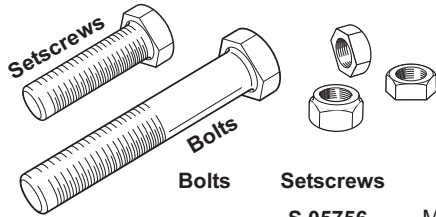

S.53854	M12	x	1.50
S.53855	M14	x	1.50
S.53856	M16	x	1.50
S.53857	M18	x	1.50
S.53858	M20	x	1.50
S.53859	M22	x	1.50
S.53860	M24	x	1.50
S.53861	M30	x	1.50

METRIC

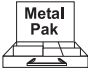
**Nuts, Bolts & Setscrews
Coarse - Combination Packs**

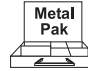

				Bolts	Setscrews	Hexagon Nuts	Hexagon Nuts	Self Locking Nuts
								
				S.12750	S.12751	S.12752	S.06781	S.06782
				400pcs	92pcs	805pcs	160pcs	160pcs
Bolts	Setscrews	METRIC						
-	S.05756	M6 x 20	-	-	-	-	-	-
-	S.06895	M6 x 25	30	-	-	-	-	-
-	S.05757	M6 x 30	-	-	-	-	-	-
-	S.05758	M6 x 40	20	-	-	-	-	-
-	S.05759	M6 x 50	20	-	-	-	-	-
S.05760	-	M6 x 60	-	-	-	-	-	-
-	S.08621	M8 x 25	20	-	-	-	-	-
S.05761	-	M8 x 30	20	-	-	-	-	-
-	S.05762	M8 x 40	15	-	-	-	-	-
-	S.05763	M8 x 50	15	-	-	-	-	-
S.05764	-	M8 x 60	-	-	-	-	-	-
S.05765	-	M8 x 70	-	-	-	-	-	-
-	S.08622	M10 x 25	15	-	-	-	-	-
-	S.05766	M10 x 30	-	-	-	-	-	-
-	S.05767	M10 x 40	15	-	-	-	-	-
S.05768	-	M10 x 50	15	-	-	-	-	-
S.05769	-	M10 x 60	15	-	-	-	-	-
S.05770	-	M10 x 70	-	-	-	-	-	-
S.05771	-	M10 x 80	-	-	-	-	-	-
-	S.05773	M12 x 30	-	15	-	-	-	-
-	S.05774	M12 x 40	-	15	-	-	-	-
S.05775	-	M12 x 50	-	10	-	-	-	-
S.05776	-	M12 x 60	-	10	-	-	-	-
S.05778	-	M12 x 80	-	8	-	-	-	-
S.06965	-	M14 x 50	-	8	-	-	-	-
S.06969	-	M14 x 70	-	8	-	-	-	-
-	S.05780	M16 x 50	-	8	-	-	-	-
-	S.05781	M16 x 70	-	5	-	-	-	-
S.06985	-	M16 x 90	-	5	-	-	-	-

Hexagon Nuts - Coarse - Grade 5

S.01052	M4 x 0.7	-	-	-	-	-
S.01053	M5 x 0.8	-	-	-	-	-
S.01054	M6 x 1.0	70	-	200	50	-
S.01055	M8 x 1.25	70	-	100	40	-
S.01056	M10 x 1.50	60	-	80	30	-
S.01057	M12 x 1.75	-	-	40	15	-
S.06811	M14 x 2.0	-	-	30	-	-
S.05893	M16 x 2.0	-	-	20	10	-
S.05894	M18 x 2.5	-	-	-	10	-
S.05895	M20 x 2.5	-	-	-	5	-

Self Locking Nuts - Coarse - Grade 5

S.03589	M6 x 1.0	-	-	100	-	50
S.03590	M8 x 1.25	-	-	100	-	40
S.03591	M10 x 1.50	-	-	60	-	30
S.03592	M12 x 1.75	-	-	40	-	15
S.06816	M14 x 2.0	-	-	20	-	-
S.05896	M16 x 2.0	-	-	15	-	10
S.05897	M18 x 2.5	-	-	-	-	10
S.05898	M20 x 2.5	-	-	-	-	5

2 FASTENERS & HARDWARE

Flat Washers



S.06780

300pcs

	Inch	Metric	
S.06833	3/16"	M5	-
S.06834	-	M6	-
S.04974	1/4"	-	50
S.04863	-	M7	-
S.04975	5/16"	M8	50
S.04976	3/8"	M10	50
S.04977	7/16"	M11	50
S.04978	1/2"	M12	50
S.06838	9/16"	M14	-
S.04979	5/8"	M16	30
S.06840	11/16"	M18	-
S.04980	3/4"	M20	20
S.06842	7/8"	M22	-
S.06843	-	M24	-
S.06844	1"	M27	-

METRIC
INCH

Repair Washers

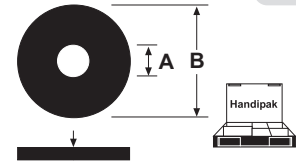
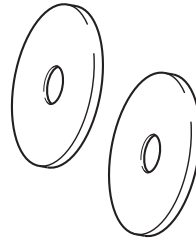

.053"

AØ

BØ



S.14248

475pcs

S.12391	1/4"	x	1"	50
S.12392	1/4"	x	1.1/4"	50
S.12393	1/4"	x	1.1/2"	50
S.12394	5/16"	x	1"	50
S.12395	5/16"	x	1.1/4"	50
S.12396	5/16"	x	1.1/2"	50
S.12397	5/16"	x	2"	25
S.12398	3/8"	x	1"	25
S.12399	3/8"	x	1.1/4"	50
S.12400	3/8"	x	1.1/2"	50
S.12401	3/8"	x	2"	25

INCH

Lock Washers



S.11841

200pcs

	Inch	Metric	
S.54282	5/32"	M4	-
S.06820	3/16"	M5	-
S.01064	1/4"	-	-
S.06284	-	M6	25
S.01065	5/16"	M8	50
S.01066	3/8"	M10	50
S.01067	7/16"	M11	-
S.06827	-	M12	25
S.01068	1/2"	-	-
S.06821	9/16"	M14	10
S.01033	5/8"	M16	10
S.06822	11/16"	M18	10
S.01032	3/4"	M20	10
S.01034	7/8"	M22	5
S.06830	-	M24	5
S.01035	1"	-	-
S.06831	-	M27	-
S.01036	1 1/8"	M30	-

METRIC
INCH

Threaded Rod

Metric Coarse - 1 Meter/39"

S.01290	M6 x 1
S.01291	M8 x 1.25
S.01292	M10 x 1.50
S.01293	M12 x 1.75
S.08321	M14 x 2.0
S.01294	M16 x 2.0

UNC - 3 Feet

UNF - 3 Feet

S.03475	1/4"	S.01270	1/4"
S.03476	5/16"	S.01271	5/16"
S.03477	3/8"	S.01272	3/8"
S.03478	7/16"	S.01273	7/16"
S.03479	1/2"	S.01274	1/2"
S.03480	5/8"	S.01275	5/8"
S.04667	3/4"	S.01276	3/4"
S.03498	7/8"	S.01277	7/8"
S.51243	1"		

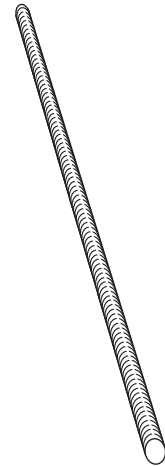

METRIC
INCH

Setscrews and Nuts - 3/16"

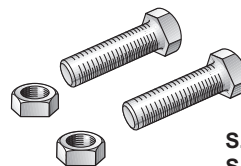

S.11555

1200pcs

S.11556	2BA x 1"	100
S.11557	2BA x 1.1/2"	100
S.11558	2BA x 2"	50
S.11559	2BA x 2.1/2"	50
S.11560	2BA Nuts	500
S.11826	Flat Washers	200
S.11827	Spring Washers	200

INCH

Bonded Seals

INCH

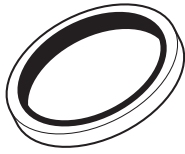

	BSP	Thread Ø Inch	14pcs	14pcs	120pcs	260pcs
S.02807	1/4"	1/2"	2	2	20	30
S.02808	3/8"	-	5	-	40	70
S.02809	1/2"	13/16"	5	-	20	70
S.02810	5/8"	7/8"	1	2	10	70
S.02811	3/4"	1"	1	-	10	20
S.04587	-	9/16"	-	5	10	-
S.01968	-	3/4"	-	5	10	-

Bonded Seals

METRIC



	Fits Bolt Sizes	145pcs
S.05685	M8	10
S.05686	M10	10
S.05687	M12	15
S.05688	M14	25
S.05689	M16	25
S.05690	M18	25
S.05691	M20	15
S.05692	M22	20

External Shakeproof Washers

INCH

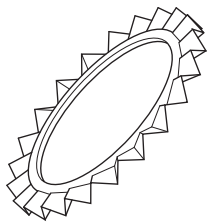

S.12184

120pcs

1/4"	20
5/16"	20
3/8"	20
7/16"	20
1/2"	15
5/8"	15
3/4"	10

Internal Shakeproof Washers

INCH

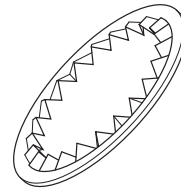

S.12185

120pcs

1/4"	20
5/16"	20
3/8"	20
7/16"	20
1/2"	15
5/8"	15
3/4"	10

Vulcanised Fiber Washers

INCH

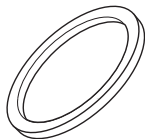

S.06375

140pcs

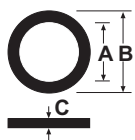

A ins	B ins	C ins	140pcs
1/4"	7/16"	3/64"	15
5/16"	1/2"	3/64"	15
3/8"	5/8"	3/64"	15
7/16"	11/16"	3/64"	15
1/2"	13/16"	3/64"	15
9/16"	7/8"	3/64"	15
5/8"	7/8"	3/64"	15
3/4"	1.1/8"	3/64"	15
7/8"	1.1/4"	3/64"	10
1"	1.3/8"	3/64"	10

Starlock Washers
Finish: Blue Varnish

METRIC
INCH

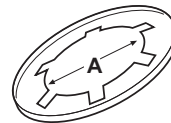

S.14215

780pcs

A ins	A mm	780pcs
1/8"	3.2	100
5/32"	4	100
3/16"	4.8	100
7/32"	5.5	100
1/4"	6.3	100
5/16"	8	100
3/8"	9.5	100
7/16"	11.1	40
1/2"	12.7	40

2 FASTENERS & HARDWARE

Copper Washers

METRIC

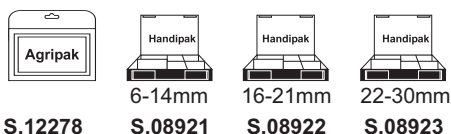
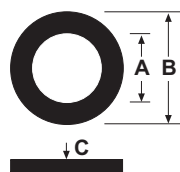
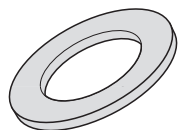

	A mm	B mm	C mm	S.12278 90pcs	S.08921 400pcs	S.08922 240pcs	S.08923 120pcs
S.08830	6	10	1	10	50	-	-
S.08832	8	12	1	10	50	-	-
S.08833	8	14	1	-	50	-	-
S.08834	10	14	1	-	50	-	-
S.08835	10	16	1	10	-	-	-
S.12279	10	20	2	-	-	-	-
S.08836	12	16	1.5	-	50	-	-
S.08837	12	18	1.5	10	50	-	-
S.08838	14	18	1.5	-	50	-	-
S.08839	14	20	1.5	10	50	-	-
S.08840	16	20	1.5	-	-	30	-
S.08841	16	22	1.5	-	-	30	-
S.08842	17	21	1.5	-	-	30	-
S.08843	18	22	1.5	-	-	30	-
S.08844	18	24	1.5	10	-	30	-
S.08845	20	24	1.5	-	-	30	-
S.08846	20	26	1.5	10	-	30	-
S.08847	21	26	1.5	-	-	30	-
S.08848	22	27	1.5	-	-	-	15
S.08849	22	29	1.5	-	-	-	15
S.08850	24	29	2	-	-	-	15
S.08851	26	31	2	10	-	-	15
S.08852	26	34	2	-	-	-	15
S.08853	27	32	2	-	-	-	15
S.08854	28	33	2	-	-	-	15
S.08855	30	36	2	10	-	-	15

Copper Washers

INCH

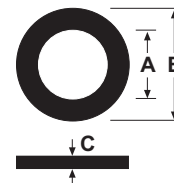
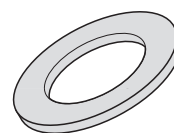

	Bolt Ø ins	A ins	B ins	C ins	500pcs
S.06364	3/16"	1/4"	1/2"	.0359	100
S.06365	1/4"	17/64"	35/64"	.0359	100
S.06366	5/16"	11/32"	9/16"	.0359	100
S.11112	-	13/32"	11/16"	.060	-
S.06367	3/8"	13/32"	11/16"	.0478	50
S.06368	7/16"	29/64"	29/32"	.0478	30
S.06369	1/2"	17/32"	27/32"	.0478	30
S.06370	9/16"	19/32"	61/64"	.0478	30
S.06371	-	0.395"	0.830"	.0747	30
S.06372	-	0.570"	0.820"	.0538	30

Aluminium Washers

INCH

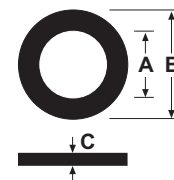
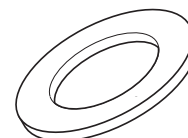

	Bolt Ø ins	A ins	B ins	C ins	480pcs
S.11224	3/16"	1/4"	1/2"	.0359	100
S.11225	1/4"	17/64"	35/64"	.0359	100
S.11226	5/16"	11/32"	9/16"	.0359	100
S.11227	3/8"	13/32"	11/16"	.0478	30
S.11228	7/16"	29/64"	29/32"	.0478	30
S.11229	1/2"	17/32"	27/32"	.0478	30
S.11230	9/16"	19/32"	61/64"	.0478	30
S.11231	-	0.395"	0.830"	.0747	30
S.11232	-	0.570"	0.820"	.0538	30
S.11113	-	5/16"	7/16"	.038	-

Conical Spring Washers

METRIC

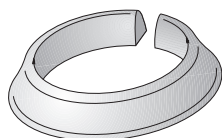

	Ø
S.51237	M12
S.51238	M14
S.51239	M16
S.51240	M18
S.51245	M20
S.51246	M22

Sheet Metal Screws - Zinc Plated

INCH



Loose Part Number	ins	Handipak	
		S.02860 325 pcs	S.12214 410 pcs
S.02852	No.4 x 1/2"	50	-
S.12199	No.4 x 3/4"	-	50
S.12200	No.4 x 1"	-	50
S.02853	No.6 x 1/2"	50	-
S.02854	No.6 x 3/4"	50	-
S.12201	No.6 x 1"	-	50
S.12202	No.6 x 1.1/2"	-	50
S.02855	No.8 x 1/2"	50	-
S.02856	No.8 x 3/4"	50	-
S.12203	No.8 x 1"	-	50
S.12204	No.8 x 1.1/2"	-	20
S.12205	No.8 x 1.3/4"	-	20
S.02857	No.10 x 3/4"	25	-
S.02858	No.10 x 1"	25	-
S.12206	No.10 x 1.1/2"	-	20
S.12207	No.10 x 2"	-	20
S.02859	No.12 x 1"	25	-
S.12208	No.12 x 1.1/2"	-	20
S.12209	No.12 x 2"	-	20
S.12210	No.14 x 3/4"	-	10
S.12211	No.14 x 1"	-	10
S.12212	No.14 x 1.1/2"	-	10
S.12213	No.14 x 2"	-	10

Sheet Metal Screws - Countersunk - Zinc Plated

INCH



Loose Part Number	ins	Handipak	
		S.12334 325 pcs	S.12335 400 pcs
S.12311	No.4 x 1/2"	50	-
S.12312	No.4 x 3/4"	-	50
S.12313	No.4 x 1"	-	50
S.12314	No.6 x 1/2"	50	-
S.12315	No.6 x 3/4"	50	-
S.12316	No.6 x 1"	-	50
S.12317	No.6 x 1.1/4"	-	50
S.12318	No.8 x 1/2"	50	-
S.12319	No.8 x 3/4"	50	-
S.12320	No.8 x 1"	-	50
S.12321	No.8 x 1.1/2"	-	20
S.12322	No.8 x 1.3/4"	-	20
S.12323	No.10 x 3/4"	25	-
S.12324	No.10 x 1"	25	-
S.12325	No.10 x 1.1/2"	-	20
S.12326	No.10 x 2"	-	20
S.12327	No.12 x 1"	25	-
S.12328	No.12 x 1.1/2"	-	20
S.12329	No.12 x 2"	-	20
S.12331	No.14 x 1"	-	10
S.12332	No.14 x 1.1/2"	-	10
S.12333	No.14 x 2"	-	10

Allen Head Cap Screws

UNC

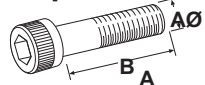

Loose Part Number	A	B	Handipak	
			S.11836 100 pcs	
S.11667	3/16"	x 3/4"	20	-
S.11668	1/4"	x 1/2"	-	-
S.11669	1/4"	x 3/4"	20	-
S.11671	5/16"	x 3/4"	-	-
S.11672	5/16"	x 1"	20	-
S.11674	5/16"	x 2"	10	-
S.11677	3/8"	x 1"	-	-
S.11678	3/8"	x 1 1/2"	10	-
S.11680	3/8"	x 2 1/2"	10	-
S.11682	1/2"	x 1 1/2"	5	-
S.11684	1/2"	x 3"	5	-

Allen Head Cap Screws

UNF

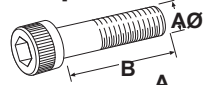

Loose Part Number	A	B	Handipak	
			S.11835 100 pcs	
S.11686	3/16"	x 3/4"	20	-
S.11688	1/4"	x 3/4"	20	-
S.11689	1/4"	x 1"	20	-
S.11691	5/16"	x 1"	10	-
S.11692	5/16"	x 1 1/2"	10	-
S.11695	3/8"	x 1"	-	-
S.11704	5/16"	x 2"	10	-
S.11696	3/8"	x 1 1/2"	5	-
S.11698	3/8"	x 2 1/2"	5	-

Allen Head Cap Screws

METRIC

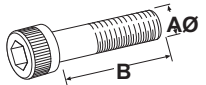

Loose Part Number	mm	mm	Handipak	
			S.11837 160 pcs	S.11838 120 pcs
S.11646	5	x 10	20	-
S.11647	5	x 16	20	-
S.11648	5	x 25	20	-
S.11650	6	x 16	20	-
S.11651	6	x 20	20	-
S.11730	6	x 25	20	-
S.11652	6	x 30	20	-
S.11654	8	x 16	20	-
S.11655	8	x 20	-	20
S.11732	8	x 25	-	20
S.11656	8	x 30	-	20
S.11657	8	x 40	-	20
S.11660	10	x 20	-	10
S.11661	10	x 25	-	10
S.11662	10	x 30	-	10
S.11733	10	x 35	-	10

Allen Screws

METRIC



Loose Part Number	A	B	Handipak	
			S.02939 220 pcs	
S.02926	4"	x 6"	20	-
S.02927	4"	x 12"	20	-
S.02928	5"	x 10"	20	-
S.02929	5"	x 16"	20	-
S.02930	6"	x 12"	20	-
S.02931	6"	x 20"	20	-
S.02932	8"	x 12"	20	-
S.02933	8"	x 16"	20	-
S.02934	8"	x 20"	20	-
S.02935	10"	x 12"	10	-
S.02936	10"	x 20"	10	-
S.02937	12"	x 12"	10	-
S.02938	12"	x 20"	10	-

Allen Screws

UNC



Loose Part Number	A	B	Handipak	
			S.02955 260 pcs	
S.02940	3/16"	x 1/2"	20	-
S.02941	3/16"	x 3/4"	20	-
S.02942	1/4"	x 1/4"	20	-
S.02943	1/4"	x 1/2"	20	-
S.02944	1/4"	x 3/4"	20	-
S.02945	1/4"	x 1"	20	-
S.02946	5/16"	x 1/2"	20	-
S.02947	5/16"	x 3/4"	20	-
S.02948	5/16"	x 1"	20	-
S.02949	3/8"	x 3/8"	20	-
S.02950	3/8"	x 1/2"	20	-
S.02951	3/8"	x 3/4"	10	-
S.02952	3/8"	x 1"	10	-
S.02953	1/2"	x 1/2"	10	-
S.02954	1/2"	x 3/4"	10	-

2 FASTENERS & HARDWARE

Hose Clamps

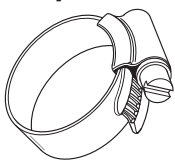

S.02315

120 pcs

		min-max Ø mm	
S.04322	3/8" - 1/2"	8 - 14	20
S.04323	7/16" - 5/8"	11 - 17	10
S.04324	1/2" - 3/4"	13 - 20	10
S.04325	5/8" - 15/16"	15 - 24	10
S.04326	3/4" - 1 3/16"	19 - 28	10
S.04327	7/8" - 1 1/4"	22 - 32	10
S.04328	1" - 1 1/2"	26 - 38	10
S.04329	1 1/8" - 1 5/8"	32 - 44	10
S.04330	1 1/2" - 2"	38 - 50	10
S.04331	1 3/4" - 2 1/4"	44 - 56	10
S.04439	2" - 2 1/2"	50 - 65	10
S.03359	2 1/2" - 3"	58 - 75	
S.04332	2 3/4" - 3 1/4"	68 - 85	
S.04333	3" - 3 3/4"	77 - 95	
S.04334	3 7/16" - 4 1/2"	87 - 112	
S.04335	3 1/2" - 4 3/4"	90 - 120	
S.04336	4 1/16" - 5 7/16"	104 - 138	
S.04337	4 3/4" - 5 1/2"	120 - 140	
S.04338	5 1/8" - 6 1/2"	130 - 165	
S.05805	6" Pegboard Hooks		11

Mini Hose Clamps

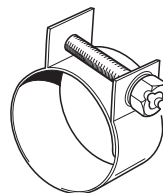

S.11721

100 pcs

		min-max Ø	
S.11466	1/4" - 5/16"	6 - 8 mm	10
S.11467	17/64" - 11/32"	7 - 9 mm	10
S.11468	5/16" - 25/64"	8 - 10 mm	10
S.11469	11/32" - 7/16"	9 - 11 mm	10
S.11470	11/32" - 15/32"	9 - 12 mm	10
S.11471	25/64" - 1/2"	10 - 13 mm	10
S.11472	7/16" - 9/16"	11 - 14 mm	10
S.11473	15/32" - 37/64"	12 - 15 mm	10
S.11474	1/2" - 5/8"	13 - 16 mm	10
S.11475	9/16" - 21/32"	14 - 17 mm	10

Nylon Hose Clamps

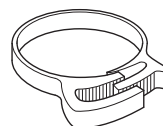

S.14374

125 pcs

		min-max Ø	
S.14375	5/16" - 3/8"		20
S.14376	13/32" - 1/2"		20
S.14377	15/32" - 19/32"		15
S.14378	19/32" - 23/32"		15
S.14379	23/32" - 7/8"		15
S.14380	29/32" - 1 1/32"		15
S.14381	1 1/16" - 1 7/32"		10
S.14382	1 9/32" - 1 7/16"		5
S.14383	1 1/2" - 1 21/32"		5
S.14384	1 3/4" - 1 29/32"		5

Large Hose Clamps

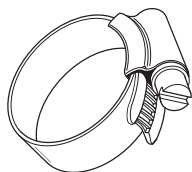

	ins	mm
S.04333	3" - 3 3/4"	77 - 95
S.04334	3 7/16" - 4 1/2"	87 - 112
S.04332	2 3/4" - 3 1/4"	68 - 85
S.04336	4 1/16" - 5 7/16"	104 - 138
S.04337	4 3/4" - 5 1/2"	120 - 140
S.04338	5 1/8" - 6 1/2"	130 - 165

Muffler Clamps

S.08872	1 1/8"	S.08880	2"
S.08873	1 1/4"	S.06314	2 1/8"
S.08874	1 3/8"	S.06315	2 1/4"
S.08875	1 1/2"	S.08881	2 3/8"
S.08876	1 5/8"	S.08882	2 1/2"
S.08877	1 11/16"	S.08883	2 5/8"
S.08878	1 3/4"		
S.08879	1 7/8"		

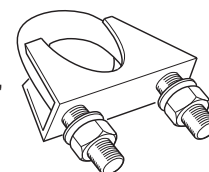

Snaphooks
Zinc Plated, Mild Steel

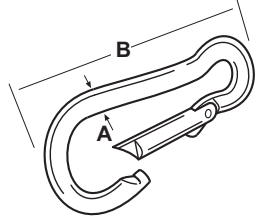

	A Ø in	B in	S.11091 17pcs
S.04270	5/32"	1 9/16"	-
S.04271	3/16"	2"	-
S.04440	1/4"	2 3/8"	5
S.04272	9/32"	2 3/4"	-
S.04441	5/16"	3 1/8"	5
S.04273	11/32"	3 9/16"	-
S.04442	3/8"	3 15/16"	4
S.04443	7/16"	4 11/16"	3
S.04274	1/2"	5 1/2"	-
S.04275	9/16"	6 1/4"	-
S.05804	4" Hook	-	4

Chain Quick Repair Links
Zinc Plated, Mild Steel

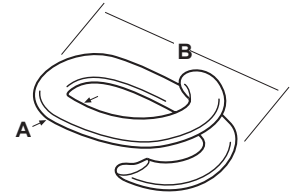

	A Ø in	B in
S.01477	1/8"	1"
S.01478	3/16"	1 1/4"
S.01479	1/4"	1 1/2"
S.01480	5/16"	2"
S.01481	3/8"	2"

Snaphooks with Safety Lock
Zinc Plated, Mild Steel

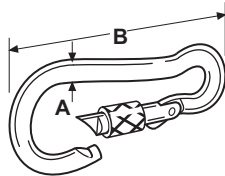

	A Ø	B
S.11816	9/32"	2 3/4"
S.11817	5/16"	3"
S.11819	3/8"	3 3/4"
S.11820	7/16"	4 1/2"

Kwik Links

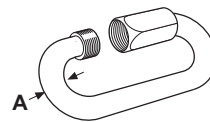

	A in	S.02319 15pcs
S.02848	3/16"	-
S.02849	1/8"	-
S.02840	1/4"	3
S.02841	5/16"	4
S.02842	3/8"	4
S.02843	1/2"	2
S.02844	9/16"	1
S.02845	5/8"	1
S.05804	4" Hook	6

Slip Hooks
Forged, Zinc Plated, Mild Steel

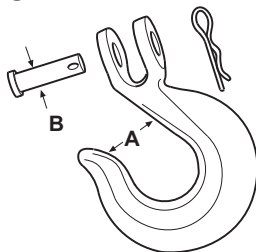

	A	B Ø
S.01467	1"	7/16"
S.01459	1 1/4"	3/8"

Grab Hooks
Forged, Zinc Plated, Mild Steel

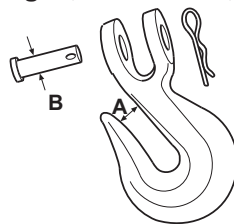

	A	B Ø
S.01453	3/8"	1/4"
S.01458	7/16"	5/16"
S.01451	1/2"	3/8"

Eye Hooks
Forged, Zinc Plated, Mild Steel

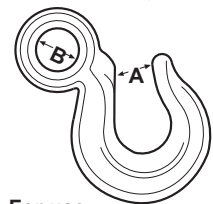

For use with chain Ø

	Ø	A	B Ø
S.01484	1/4"	7/8"	7/16"
S.01485	5/16"	1"	9/16"
S.01486	3/8"	1 1/4"	5/8"
S.01487	1/2"	1 9/16"	7/8"

2 FASTENERS & HARDWARE

Screw Type 'D' Clevis

Commercial Type Galvanised Mild Steel

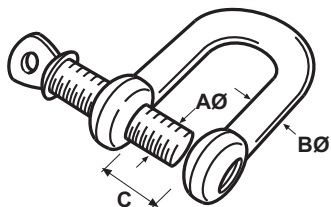

**INCH
METRIC**



S.02769

53pcs

	AØ		BØ		C		Rec Max Load kg
	ins	mm	ins	mm	ins	mm	
S.02764	1/4"	6	1/4"	6	1/2"	13	100
S.02765	5/16"	8	5/16"	8	5/8"	16	120
S.02766	3/8"	10	3/8"	10	3/4"	18	150
S.02767	7/16"	11	7/16"	11	13/16"	21	250
S.02768	1/2"	13	1/2"	13	1"	26	400
S.04179	5/8"	16	5/8"	16	1 3/16"	31	900
S.04664	3/4"	19	3/4"	19	1 1/2"	39	1000
S.04665	7/8"	22	7/8"	22	1 5/8"	42	1270
S.04666	1"	25	1"	25	2"	51	2000
S.05805	6" Hook						

10
10
10
10
5
2
2
2
2
9

Twist Clevis

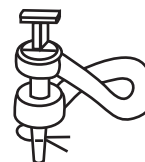

S.61369 5/8" Pin, 3/4" Clevis
S.52657 3/4" Pin, 7/8" Clevis

Straight Clevis

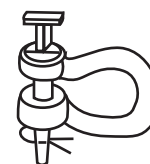

S.52656 3/4" Pin, 7/8" Clevis

'D' Clevis Sets

Commercial Type Zinc Plated Mild Steel

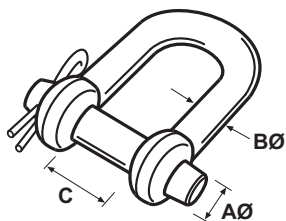

**INCH
METRIC**

	AØ		BØ		C	
	ins	mm	ins	mm	ins	mm
S.01410	1/4"	6	1/4"	6	1/2"	13
S.01412	5/16"	8	5/16"	8	1/2"	13
S.01415	5/16"	8	5/16"	8	5/8"	16
S.01420	3/8"	9.5	3/8"	9.5	3/4"	19
S.01425	7/16"	11	7/16"	11	7/8"	22
S.01430	1/2"	13	1/2"	13	1"	25
S.01400	3/4"	19	3/4"	19	1 15/16"	49
S.00229	3/4"	19	9/16"	14	13/16"	21

Bow Clevis

Commercial Type Galvanised Mild Steel

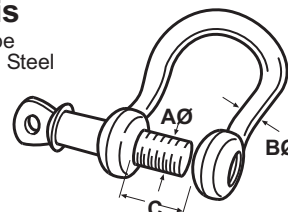

**INCH
METRIC**

	AØ		BØ		C	
	ins	mm	ins	mm	ins	mm
S.04867	1/4"	6	1/4"	6	7/16"	11
S.04868	5/16"	8	5/16"	8	9/16"	14
S.04869	3/8"	10	3/8"	10	3/4"	19
S.04870	7/16"	11	7/16"	11	13/16"	21
S.04871	1/2"	13	1/2"	13	13/16"	21
S.04872	5/8"	16	5/8"	16	1 5/16"	33
S.04873	3/4"	19	3/4"	19	1 9/16"	40
S.04874	7/8"	22	7/8"	22	1 3/4"	45
S.04875	1"	25	1"	25	2"	51

Drawbar Hook

Includes 3/4" Pin
Fits Drawbars up to 1 1/4" Thick

S.52090

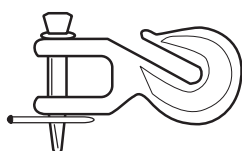

Clevis Pins

INCH

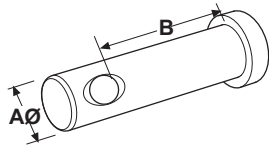

S.03425

80pcs

	AØ ins	B mm	
S.01440	1/4"	1"	10
S.01469	5/16"	9/32"	10
S.00060	5/16"	15/16"	-
S.01406	5/16"	1 1/8"	-
S.01441	5/16"	1 5/16"	10
S.00061	3/8"	15/16"	-
S.01468	3/8"	1 3/32"	10
S.01439	3/8"	1 5/16"	-
S.01442	3/8"	1 1/2"	10
S.01448	7/16"	1 5/16"	10
S.01443	7/16"	1 3/4"	10
S.01790	1/2"	15/16"	-
S.01444	1/2"	2"	10
S.01445	1/2"	2 9/32"	-
S.01640	5/8"	2 29/32"	-
S.01446	3/4"	2 15/16"	-

Wire Rope Clamps

**INCH
METRIC**

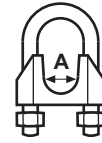
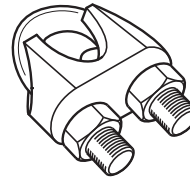

	A	
	ins	mm
S.01370	1/8"	3
S.01371	3/16"	4
S.01372	1/4"	6
S.01373	5/16"	8
S.01374	3/8"	10
S.01375	7/16"	11
S.01376	1/2"	12
S.01377	9/16"	14
S.01378	5/8"	16
S.01379	3/4"	19
S.08591	1"	25

Clevis Pins

METRIC

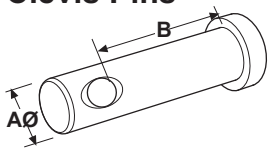

S.19794

105 pcs

	AØ mm	B mm	
S.19785	4	22	15
SA.19786	5	22	15
S.19787	6	22	15
S.19788	7	24	15
S.19789	8	24	15
S.19790	9	30	15
S.19791	10	35	15
S.04463	15.7	45	-

Rubber Lined Clamps

For securing cables and light pipework

INCH

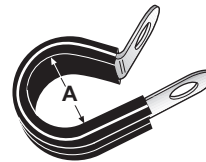

S.12182

76pcs

	AØ	
S.12141	1/8"	-
S.12142	3/16"	8
S.12143	1/4"	10
S.12144	5/16"	8
S.12145	3/8"	8
S.12146	7/16"	10
S.12147	1/2"	8
S.12148	9/16"	8
S.12149	5/8"	8
S.12150	11/16"	-
S.12151	3/4"	8
S.12152	13/16"	-
S.12153	7/8"	-

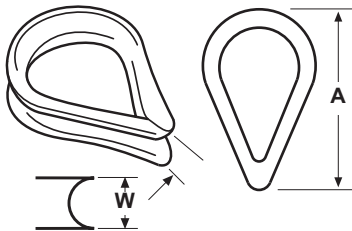

Wire Rope Thimbles

INCH

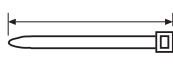
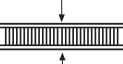
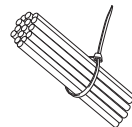

	W	A
S.08588	1/8"	1 3/16"
S.08589	3/16"	1 13/32"
S.08590	7/32"	1 9/16"
S.01391	1/4"	1 3/4"
S.01392	5/16"	2"
S.01393	3/8"	2 1/2"
S.01394	1/2"	3"
S.01395	9/16"	3 1/4"
S.01396	5/8"	3 1/2"

2 FASTENERS & HARDWARE

Cable Ties					 S.12163 350pcs
	ins	ins	ins		
S.05976 Non Releasable	3 3/4"	3/32"	5/8"	S.06323 100pcs	-
S.05977 Non Releasable	7 7/8"	3/16"	2"	S.06324 50pcs	100
S.05978 Non Releasable	4 3/4"	3/16"	1 3/32"	S.06325 50pcs	100
S.05979 Non Releasable	10 5/8"	3/16"	2 7/8"	S.06326 50pcs	100
S.05980 Non Releasable	10 5/8"	11/32"	2 3/4"	S.06327 25pcs	-
S.05981 Non Releasable	21 1/4"	1/2"	6"	S.06328 10pcs	-
S.05982 Releasable	13 3/16"	5/16"	4 1/4"	S.06329 10pcs	-
S.05983 Releasable	30 5/16"	11/32"	8 7/16"	S.06330 10pcs	-
S.08462 Non Releasable	15 3/16"	5/16"	4 1/4"	S.08463 10pcs	50

Cable Ties Various Colors

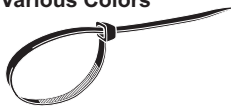

S.22720 3/32" - 8" **600pcs**

Cable Ties Various Colors

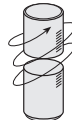
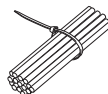

S.56697 3/16" - 1/2" **700pcs**

Adhesive Cable Clips

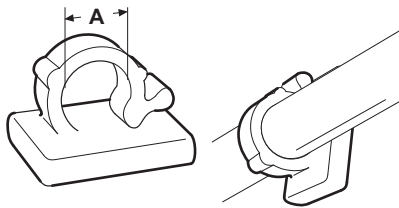

	AØ	
S.11311	1/8"	15pcs
S.11312	1/4"	15pcs
S.11313	11/32"	15pcs
S.11314	23/32"	12pcs

Rubber Straps

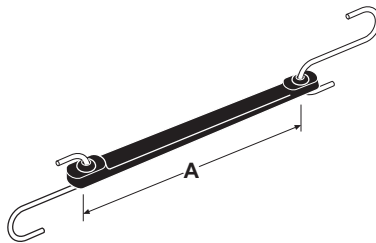

	A
S.08906	9"
S.08907	15"
S.08908	22"

Polypropylene Rope - Orange 700ft per Reel

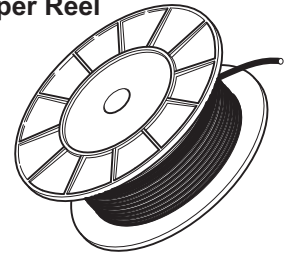

	Ø
S.08525	1/4"
S.08526	5/16"
S.08527	3/8"

Hood Catches

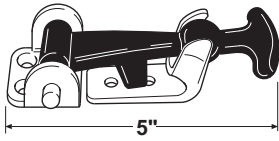

S.08390

S.08385 Complete Hood Catch **2pcs**



S.08391

S.08386 Catch only **2pcs**

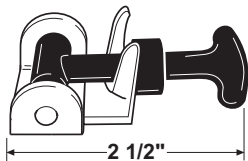

S.11071

S.11068 Complete Hood Catch **2pcs**



S.11072

Catch only **2pcs**

Open & Blind Grommets

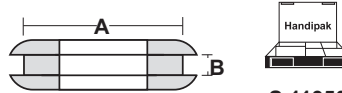
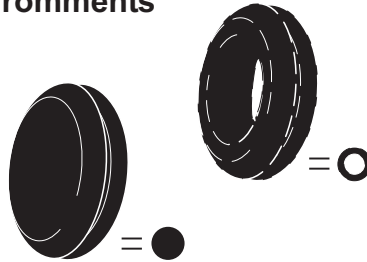

S.11350

270pcs

	A ins	B ins		
S.11331	1/4"	x 1/16"	○	20
S.11341	1/4"	x 1/16"	●	10
S.11332	5/16"	x 1/16"	○	20
S.11342	5/16"	x 1/16"	●	10
S.11333	3/8"	x 1/16"	○	20
S.11343	3/8"	x 1/16"	●	10
S.11334	7/16"	x 1/16"	○	20
S.11344	7/16"	x 1/16"	●	10
S.11335	1/2"	x 1/16"	○	20
S.11345	1/2"	x 1/16"	●	10
S.11336	5/8"	x 1/16"	○	20
S.11346	5/8"	x 1/16"	●	10
S.11337	11/16"	x 1/16"	○	20
S.11338	0.787"	x 1/16"	○	20
S.11347	0.787"	x 1/16"	●	10
S.11339	7/8"	x 1/16"	○	10
S.11348	7/8"	x 1/16"	●	10
S.11340	1"	x 1/16"	○	10
S.11349	1"	x 1/16"	●	10

Eyelet/Grommet Kit

(For do-it-yourself repair of canvas and nylon sheeting)



S.11201

Ø 3/8" **10pcs**

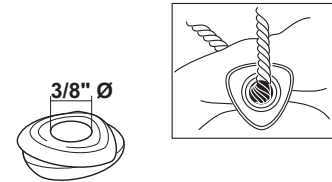

For Plastic:

- Fold to double thickness
- Use rubber washer
- Tap Grommet together

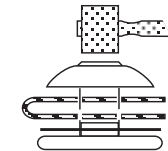

For Heavy Canvas:

- Single Thickness
- Cut Hole
- Do not use rubber washer
- Tap Grommet together through hole in canvas

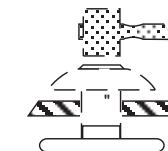

For Lightweight Canvas & Nylon:

- Fold to double thickness
- Cut hole
- Do not use rubber washer
- Tap Grommet together through hole in material

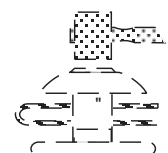

2 FASTENERS & HARDWARE

Hand Riveting Gun - Rivets 1/8", 5/32" & 3/16" Ø

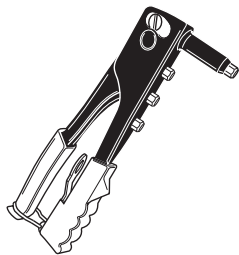

S.04801

1

Industrial Type Riveter

Supplied with 4 interchangeable nozzles - 3/32" already installed.

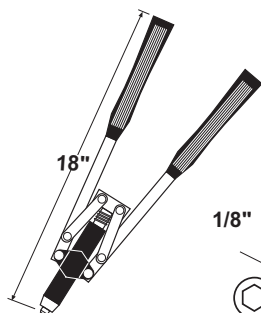

1/8" 5/32" 3/16"

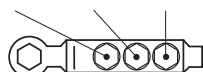

S.11892

Pop Rivets - Aluminium Head Steel Mandrel

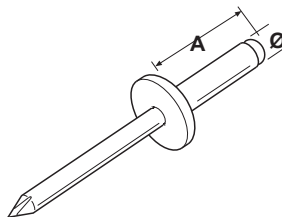

S.11465
295pcs



Ø ins		A ins			
1/8"	- Short	13/64"	-	100	S.08400
1/8"	- Medium	5/16"	50	100	S.08401
1/8"	- Long	1/2"	50	100	S.08402
5/32"	- Short	15/64"	-	100	S.08403
5/32"	- Medium	3/8"	50	100	S.08404
5/32"	- Long	39/64"	50	100	S.08405
3/16"	- Short	5/16"	25	100	S.08406
3/16"	- Medium	1/2"	25	100	S.08407
3/16"	- Long	3/4"	25	100	S.08408

Large Flange

3/16"	3/8"	10	50	S.11463
3/16"	15/16"	10	25	S.11464

Core/Expansion/Frost Plugs

A comprehensive selection of mild steel and stainless steel core/expansion plugs. Suitable for use on engines as fitted to Ford & MF as well as numerous other applications.

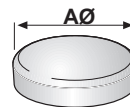

Cup Type



S.08466

Loose Part Number	AØ			Replaces	
	ins	mm			120pcs
S.08529	3/4"	19.44	Mild Steel	Ford 376099S (83417040)	-
S.08444	7/8"	22.27	Mild Steel	Ford 380391S	8
S.08448	1"	25.78	Mild Steel	Perkins 0650 576	8
S.12688	1 5/32"	29.00	Stainless Steel	Ford 390624S (83957021)	-
S.08449	1 1/4"	32.18	Mild Steel	MF 735865M1 Perkins 0650563	8
S.08451	1 3/8"	35.36	Mild Steel	MF 376190X1 Perkins 0650618	8
S.08450	1 1/2"	38.48	Mild Steel	MF 735869M1 Perkins 0650577	8
S.08446	1 1/2"	38.53	Mild Steel	Ford 376042S (83957023)	8
S.14458	1 1/2"	38.53	Stainless Steel	Ford 376042S (83957023)	-
S.08445	1 9/16"	39.95	Mild Steel	Ford 376808S36 (83957024)	8
S.14534	1 5/8"	41.27	Mild Steel	Ford 353000S	-
S.14452	1 5/8"	41.27	Stainless Steel		-
S.12868	1 5/8"	41.27	Mild Steel	Ford 35300S Perkins 32416112/4	-
S.08447	1 3/4"	44.75	Mild Steel	Ford 376043S (83957025)	8
S.14459	1 3/4"	44.75	Stainless Steel	Ford 376043S (83957025)	-
S.00538	1 3/4"	44.75	Mild Steel	MF 195644M1 (Flat Type)	-
S.08530	2 3/16"	55.90	Mild Steel	Ford 376809S36 (E9NN6L692AA)	-
S.08531	2 3/16"	55.90	Stainless Steel	Ford 376809S36 (E9NN6L692AA)	-

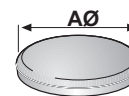

Flat Type

Mild Steel Turnbuckles - Metric Threads

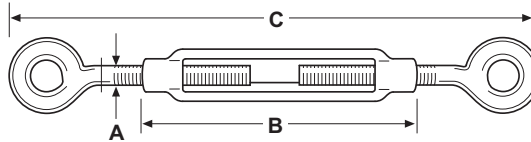

METRIC

Galvanized

	A mm	B mm	C Min mm	C Max mm
S.11073	6	80	143	203
S.11074	8	100	168	244
S.11075	10	120	213	296
S.11076	12	140	244	340
S.21040	14	160	275	395
S.11077	16	185	324	461
S.21041	18	205	350	500
S.21042	20	225	385	545
S.21043	22	240	410	585

METRIC

Galvanized

	A mm	B mm	C Min mm	C Max mm
S.21060	6	80	152	213
S.21061	8	100	181	257
S.21063	12	140	254	359
S.21064	14	160	298	419
S.21065	16	185	346	486
S.21066	18	205	381	530
S.21068	22	240	451	625

METRIC

Galvanized

	A mm	B mm	C Min mm	C Max mm
S.11078	6	80	137	197
S.11079	8	100	166	241
S.11080	10	120	200	286
S.11082	16	185	321	461
S.21051	18	205	355	505
S.21052	20	225	390	550
S.21053	22	240	420	595

METRIC

**Galvanized Turnbuckle
Self Color Thread**

	A mm	B mm	C Min mm	C Max mm
S.11083	6	80	143	191
S.11085	10	120	213	276
S.11086	12	140	244	328
S.11087	16	185	315	450
S.11088	20	225	400	560
S.11089	22	240	425	595
S.11090	24	265	515	671

Baler Shear Bolts

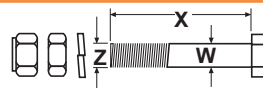
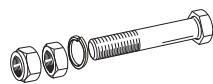

Fits	Replaces	W	X	Z	Qty
S.03611 Massey Ferguson 15, 20	Flywheel MF 781 842 M1 + 353 916X1	5/16"	2 1/2"	5/16"UNF	10
S.03612 Massey Ferguson 124, 128	Flywheel MF 354 615X1 + 583 038X1	5/16"	2 1/2"	5/16"UNC	10
S.04652 John Deere 342, 346, 456, 466	Flywheel D 17882	5/16"	2 1/4"	5/16"UNC	10
S.04653 John Deere 224T	Flywheel DC 17881	17/64"	2 1/4"	1/4"UNC	10
S.03609 International Harvester 46, 47, 430, 440	Flywheel IH 735 986 R11, 772 336 R91	5/16"	2"	5/16"UNF	10
S.11208 Lely Model Roterra 540RPM	Power Harrow 911300124	17/64"	2 1/8"	M7 x 1.00	10
S.03600 Welger RP12(Round Bale Baler)	- 0901 10 6200	5/16"	2"	5/16"UNC	10
S.03600 New Holland 65E, 68, S.68, 78, S.78, S.268, 274, 276, 278, 286	Flywheel NH 39716	5/16"	2"	5/16"UNC	10
S.03602 New Holland 68, 78, 278, S.78, S.68	FDrive Twister Feed Roll NH 51430, 151203	1/4"	1 1/2"	1/4"UNC	10
S.03608 New Holland 65E, S.268, 274, 276, 286, 352, 354, 357, 707	Corn Picker NH 58118	3/16"	1 1/2"	No.12 UNC	10

2 FASTENERS & HARDWARE

Roller Chain and Chain Repair Kits Imported - 16.25 ft Long

B.S. Simplex Chain No.	Sparex Part No.	Diagram Dimensions					Connecting Link	Offset Link	Repair Kit
		ins	A Pitch mm	ins	B mm	C mm			
ASA 35-1	S.27317	3/8	9.52	3/16	4.68	3.55	S.27296	S.27501	S.14492
ASA 40-1	S.27318	1/2	12.70	5/16	7.85	3.98	S.27297	S.27502	S.14493
ASA 50-1	S.19760	5/8	15.87	3/8	9.52	5.08	S.27298	S.27503	S.14494
ASA 60-1	S.14579	3/4	19.05	1/2	12.70	5.95	S.27299	S.27504	S.14495
ASA 60H-1	S.14580	3/4	19.05	1/2	12.70	5.95	S.27313	S.27505	S.14521
ASA 80-1	S.14581	1	25.40	5/8	15.87	7.92	S.27314	S.27506	S.14496
ASA 80-1H	S.27316	1	25.40	5/8	15.87	7.92	S.27315	S.27507	S.20004*

Repair Kits Contain: 1 Inner Link, 2 Connecting Links (Spring Clip Type), 1 Offset Link, 2 Spare Spring Clips

*S.20004 Contains: 2 Connecting Links (Spring Clip Type), 1 Offset Link

Roller Chain Breakers

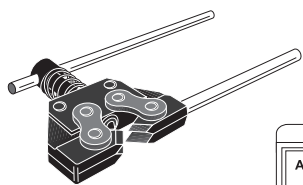

To fit chains with pitch from 3/8" to 5/8" (no. 25-50) **S.14004**
1 pc

To fit chains with pitch from 3/4" to 1.1/4" (no. 60-100) **S.14005**
1 pc

Rubber Damper - Bolt to Bolt Type

Sparex No.	Dia/mm	Height/mm	Size/mm	Thread/mm
S.55400	15	15	M4	12
S.55401	20	10	M6	15
S.55402	20	15	M6	15
S.55403	20	20	M6	15
S.55405	25	20	M6	18
S.55406	25	30	M6	18
S.55407	30	15	M8	20
S.55408	30	20	M8	20
S.55409	30	30	M8	20
S.55410	40	30	M8	23
S.55411	40	40	M8	23
S.55412	50	20	M10	28
S.55413	50	30	M10	28
S.55414	50	40	M10	28
S.55415	50	45	M10	28
S.55417	60	35	M10	28
S.55418	60	40	M10	28
S.55420	75	40	M12	37
S.55421	75	50	M12	37
S.55423	100	60	M16	45

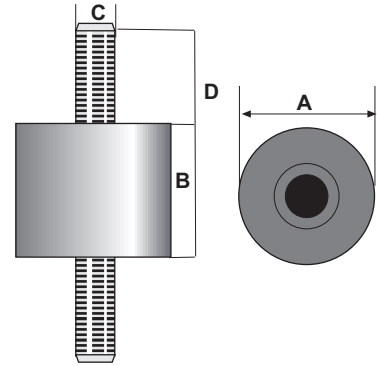

Rubber Damper - Bolt to Taper Type

Sparex No.	Dia/mm	Height/mm	Size/mm	Thread/mm
S.55430	25	20	M6	18
S.55431	30	20	M8	20
S.55432	30	30	M8	20
S.55433	30	40	M8	20
S.55434	40	30	M8	23
S.55435	40	40	M8	23
S.55436	50	20	M10	28
S.55437	50	30	M10	28
S.55438	50	40	M10	28
S.55441	60	35	M10	28
S.55442	60	40	M10	28
S.55443	75	40	M12	37
S.55443	75	40	M12	37

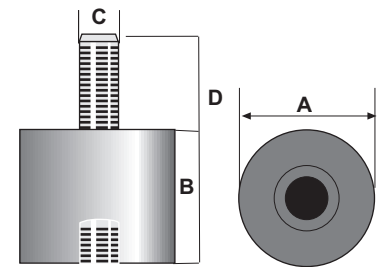

Rubber Damper - Taper to Taper Type

Sparex No.	Dia/mm	Height/mm	Size/mm
S.55451	25	20	M6
S.55452	30	30	M8
S.55453	40	30	M8
S.55454	40	40	M8
S.55455	50	30	M10
S.55456	50	40	M10

