

Tractor Model to Engine Index

Model	Engine	Cyl.	Page
770	AD3.49	3	29
780	AD3.55	3	30
880	AD3.55	3	30
885	AD3.55	3	30
990	AD4.49	4	31
995	AD4.55	4	32
996	AD4.55	4	32
1190	AD3.55	3	30
1194	AD3.55	3	30
1200	AD4.55	4	32
1210	AD4.55	4	32
1212	AD4.55	4	32
1290	AD4.49	4	31
1290	AD4.55	4	32
1294	AD4.55	4	32
1390	AD4.55	4	32
1390T	AD4.55T	4	33
1394	AD4.55	4	32
1394	AD4.55T	4	33
1410	AD4.55T	4	33
1412	AD4.55T	4	33
1490	AD4.55T	4	33
1494	AD4.55T	4	33
1594	AD6.329T	6	35
1690	AD6.329	6	34
1694	AD6.329T	6	35
1690T	AD6.329T	6	35

Case IH

David Brown

Deutz

Fendt

Fiatagri

Ford

John Deere

M F

Renault

Zetor



Gaskets for Crankshaft			
Models	Remarks	Replaces	Sparex
770, 780, 880, 990, 995, 996, 1200, 1210, 1212, 1410, 1412	1 pair	K914404	S.57563
855, 990, 995, 996, 1190, 1194, 1210, 1212, 1290, 1294, 1390, 1394, 1410, 1412, 1490, 1494	1 pair	K950938	S.57564
1594, 1690, 1694, 1690 Turbo	single	K220569	S.57565

S.57570

S.57571



Exhaust Manifold Gaskets			
Models	Remarks	Replaces	Sparex
990, 995, 996, 1200, 1210, 1212, 1290, 1294, 1390, 1394, 1410, 1412, 1490, 1494	Manifold Gasket Set	K907343 K907344	S.57844
770, 780, 880, 885, 1190, 1194, 1594, 1690		K912441	S.57570
850, 880, 900, 950, 990, 995, 996, 1200, 1210, 1212, 1290, 1294, 1390		K957520	S.57571





Description	Remarks	Replaces	Sparex
1 Piston and Liner Set (per Cyl.)		Order components	
2 Liner	Semi Finished	K964857	S.57504
3 Piston		K949721	S.57505
4 Ring Set		K261069	S.57508

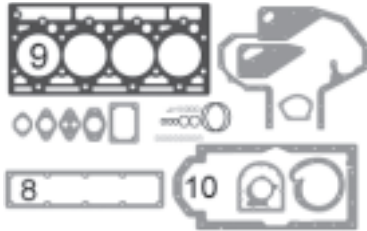

6 Top Gasket Set		K262754	S.57549
7 Bottom Gasket Set		K262764	S.57559
8 Rocker Cover Gasket		K907338	S.57556
9 Head Gasket		K956672	S.57553
10 Sump Gasket		K262733	S.57566

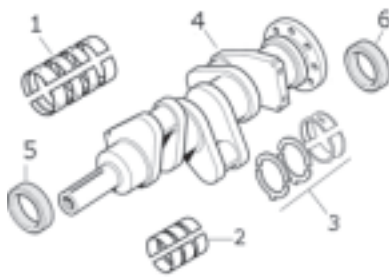

1 Main Bearings (1 set)	Standard 0,010"	K928540 K928557	S.57526 S.57529
2 Conrod Bearings (1 set)	Standard 0,010"	K207436 K207497	S.57517 S.57518
3 Thrust Washers (1 set)	Standard 0,005"	K928542 K928560	S.57537 S.57538
4 Crankshaft			
5 Front Oil Seal		K628127	S.57541
6 Rear Oil Seal		K262783	S.57543



1 Conrod			
1 Conrod			
2 Small End Bush		K31669	S.57548
3 Conrod Bolt			
4 Conrod Nut			

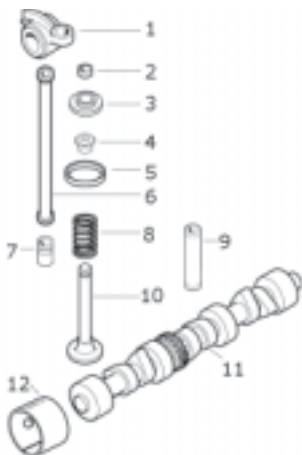

1 Rocker Arm			
1 Rocker Arm Shaft			
2 Collet		K943439	S.41413
3 Top Retainer			
3 Bottom Retainer			
4 Valve Stem Seal			
5 Inlet Valve Insert			
5 Exhaust Valve Insert			
6 Push Rod			
6 Push Rod Tube			
7 Tappet/Cam Follower			
8 Inner Valve Spring		K921435	S.57502
8 Outer Valve Spring		K921436	S.57503
9 Inlet/Exhaust Valve Guide			
10 Inlet Valve		K928622	S.57500
10 Exhaust Valve		K928622	S.57500
11 Camshaft			
12 Camshaft Bush			



13 Oil Pump			
14 Fuel Pump		K311938	S.63033
15 Water Pump		K911964	S.57757

Models: 780, 880, 885, 1190, 1194

Case IH

David Brown

Deutz

Fendt

Fiatagri

Ford

John Deere

M F

Renault

Zetor

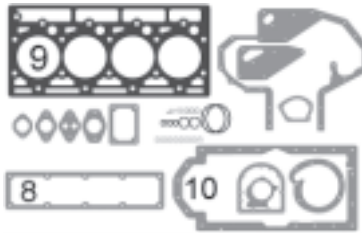

Description	Remarks	Replaces	Sparex
1 Piston and Liner Set (per Cyl.)		Order components	
2 Liner	Semi Finished	K964857	S.57504
3 Piston		K949474	S.57506
4 Ring Set		K261069	S.57508

6 Top Gasket Set		K262754	S.57549
7 Bottom Gasket Set		K262764	S.57559
8 Rocker Cover Gasket		K907338	S.57556
9 Head Gasket		K956672	S.57553
10 Sump Gasket		K262733	S.57566

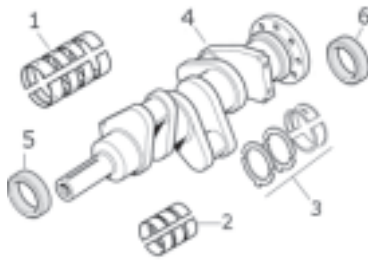

1 Main Bearings (1 set)	Standard	K928540	S.57526
	0,010"	K928557	S.57529
2 Conrod Bearings (1 set)	Standard	K207436	S.57517
	0,010"	K207497	S.57518
3 Thrust Washers (1 set)	Standard	K928542	S.57537
	0,005"	K928560	S.57538
4 Crankshaft			
5 Front Oil Seal		K628127	S.57541
6 Rear Oil Seal		K262783	S.57543



1 Conrod			
1 Conrod			
2 Small End Bush		K31669	S.57548
3 Conrod Bolt			
4 Conrod Nut			

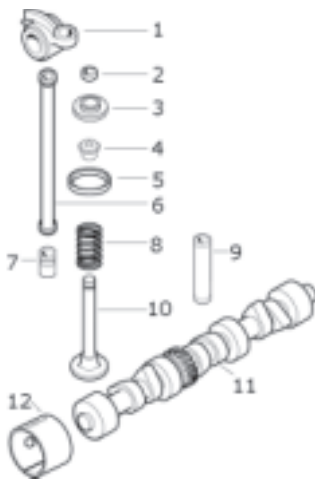

1 Rocker Arm			
1 Rocker Arm Shaft			
2 Collet		K943439	S.41413
3 Top Retainer			
3 Bottom Retainer			
4 Valve Stem Seal			
5 Inlet Valve Insert			
5 Exhaust Valve Insert			
6 Push Rod			
6 Push Rod Tube			
7 Tappet/Cam Follow er			
8 Inner Valve Spring		K921435	S.57502
8 Outer Valve Spring		K921436	S.57503
9 Inlet/Exhaust Valve Guide			
10 Inlet Valve		K928622	S.57500
10 Exhaust Valve		K928622	S.57500
11 Camshaft			
12 Camshaft Bush			



13 Oil Pump			
14 Fuel Pump		K311938	S.63033
15 Water Pump		K911964	S.57757

Models: 990, 1290 >11052360



Description	Remarks	Replaces	Sparex
1 Piston and Liner Set (per Cyl.)		Order components	
2 Liner	Semi Finished	K964857	S.57504
3 Piston		K949721	S.57505
4 Ring Set		K261069	S.57508

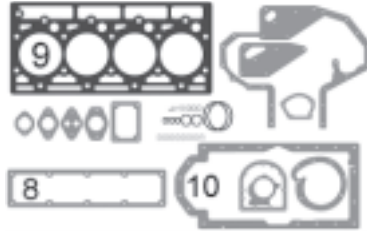

6 Top Gasket Set		K262752	S.57551
7 Bottom Gasket Set		K262765	S.57561
8 Rocker Cover Gasket		K905229	S.57557
9 Head Gasket		K262750	S.57554
10 Sump Gasket		K918684	S.57567

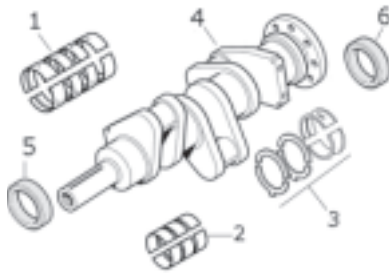

1 Main Bearings (1 set)	Standard	K928541	S.57527
	0,010"	K928554	S.57530
2 Conrod Bearings (1 set)	Standard	K207436	S.57520
	0,010"	K207497	S.57521
3 Thrust Washers (1 set)	Standard	K928542	S.57537
	0,005"	K928560	S.57538
4 Crankshaft			
5 Front Oil Seal		K628127	S.57541
6 Rear Oil Seal		K262783	S.57543



1 Conrod			
1 Conrod			
2 Small End Bush		K31669	S.57548
3 Conrod Bolt			
4 Conrod Nut			

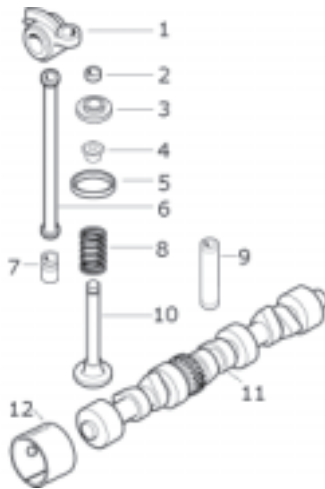

1 Rocker Arm			
1 Rocker Arm Shaft			
2 Collet		K943439	S.41413
3 Top Retainer			
3 Bottom Retainer			
4 Valve Stem Seal			
5 Inlet Valve Insert			
5 Exhaust Valve Insert			
6 Push Rod			
6 Push Rod Tube			
7 Tappet/Cam Follower			
8 Inner Valve Spring		K921435	S.57502
8 Outer Valve Spring		K921436	S.57503
9 Inlet/Exhaust Valve Guide			
10 Inlet Valve		K928622	S.57500
10 Exhaust Valve		K928622	S.57500
11 Camshaft			
12 Camshaft Bush			



13 Oil Pump			
14 Fuel Pump		K944997	S.63034
15 Water Pump			

Models: 995, 996, 1290 <11052360, 1390, 1200, 1210, 1212, 1294, 1394

Case IH

David Brown

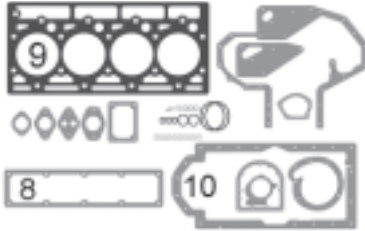

Description	Remarks	Replaces	Sparex
1 Piston and Liner Set (per Cyl.)		Order components	
2 Liner	Semi Finished	K964857	S.57504
3 Piston		K949474	S.57506
4 Ring Set		K261069	S.57508
6 Top Gasket Set		K262752	S.57551
7 Bottom Gasket Set		K262765	S.57561
8 Rocker Cover Gasket		K905229	S.57557
9 Head Gasket		K262750	S.57554
10 Sump Gasket		K918684	S.57567

Deutz

Fendt

Fiatagri

Ford

John Deere

M F

Renault

Zetor

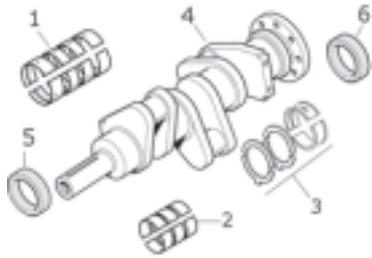

1 Main Bearings (1 set)	Standard 0,010"	K928541	S.57527
2 Conrod Bearings (1 set)	Standard 0,010"	K207436	S.57520
3 Thrust Washers (1 set)	Standard 0,005"	K928542	S.57537
4 Crankshaft		K210100	S.57959
5 Front Oil Seal		K628127	S.57541
6 Rear Oil Seal		K262783	S.57543



1 Conrod			
1 Conrod			
2 Small End Bush		K31669	S.57548
3 Conrod Bolt			
4 Conrod Nut			

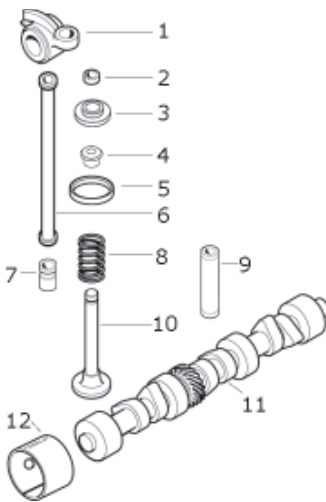

1 Rocker Arm			
1 Rocker Arm Shaft			
2 Collet		K943439	S.41413
3 Top Retainer			
4 Valve Stem Seal			
5 Inlet Valve Insert			
6 Push Rod			
6 Push Rod Tube			
7 Tappet/Cam Follow er			
8 Inner Valve Spring		K921435	S.57502
8 Outer Valve Spring		K921436	S.57503
9 Inlet/Exhaust Valve Guide			
10 Inlet Valve		K928622	S.57500
10 Exhaust Valve		K928622	S.57500
11 Camshaft			
12 Camshaft Bush			



13 Oil Pump			
14 Fuel Pump		K944997	S.63034
15 Water Pump			

David Brown

AD4.55T

Cyl. 4

Bore 99,47

Height 212,72

Pin 31,75

Height 105,68

Rings 4

Additional information
Semi Finished Liner

Models: 1390T, 1490, 1410, 1412, 1494

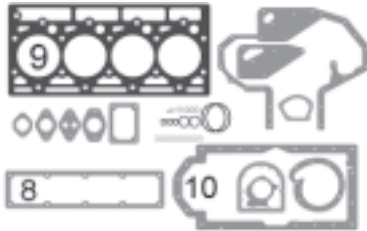

Description	Remarks	Replaces	Sparex
1 Piston and Liner Set (per Cyl.)		Order components	
2 Liner	Semi Finished	K964857	S.57504
3 Piston		K944573	S.57507
4 Ring Set		K261069	S.57508
6 Top Gasket Set		K262752	S.57551
7 Bottom Gasket Set		K262765	S.57561
8 Rocker Cover Gasket		K905229	S.57557
9 Head Gasket		K262750	S.57554
10 Sump Gasket		K918684	S.57567
11 Timing Cover Gasket			
12 Timing Cover Gasket			

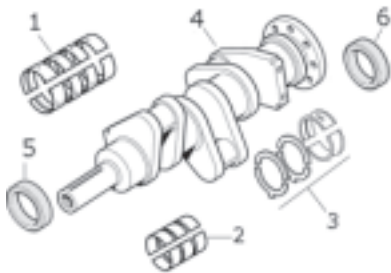

1 Main Bearings (1 set)	Standard		S.75991
	0,010"		S.75992
2 Conrod Bearings (1 set)	Standard	K929148	S.57799
	0,010"		S.75989
3 Thrust Washers (1 set)	Standard	K928542	S.57537
	0,005"	K928560	S.57538
4 Crankshaft			
5 Front Oil Seal		K628127	S.57541
6 Rear Oil Seal		K262784	S.57542



1 Conrod			
1 Conrod			
2 Small End Bush		K31669	S.57548
3 Conrod Bolt			
4 Conrod Nut			

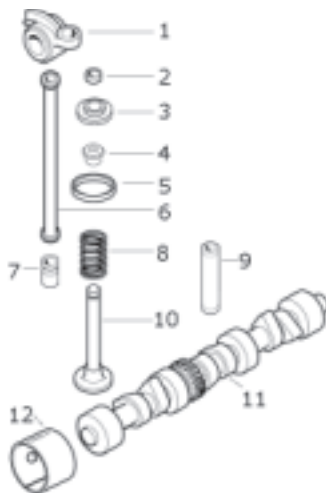

1 Rocker Arm			
1 Rocker Arm Shaft			
2 Collet		K943439	S.41413
3 Top Retainer			
3 Bottom Retainer			
4 Valve Stem Seal			
5 Inlet Valve Insert			
5 Exhaust Valve Insert			
6 Push Rod			
6 Push Rod Tube			
7 Tappet/Cam Follower			
8 Inner Valve Spring		K921435	S.57502
8 Outer Valve Spring		K921436	S.57503
9 Inlet/Exhaust Valve Guide			
10 Inlet Valve		K928622	S.57500
10 Exhaust Valve		K950100	S.57501
11 Camshaft			
12 Camshaft Bush			



13 Oil Pump			
14 Fuel Pump		K944997	S.63034
15 Water Pump			

Sparex

Case IH

David Brown

Deutz

Fendt

Fiataagri

Ford

John Deere

M F

Renault

Zetor

Case IH

David Brown

Deutz

Fendt

Fiatagri

Ford

John Deere

M F

Renault

Zetor



Description	Remarks	Replaces	Sparex
1 Piston and Liner Set (per Cyl.)		Order components	
2 Liner	Semi Finished	K964857	S.57504
3 Piston		K206954	S.57840
4 Ring Set		K261069	S.57508

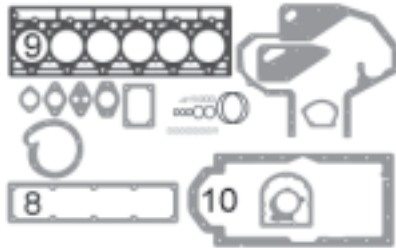

6 Top Gasket Set		K262766	S.57552
7 Bottom Gasket Set		K262747	S.57562
8 Rocker Cover Gasket		K918689	S.57558
9 Head Gasket		K952527	S.57555
10 Sump Gasket		K918684	S.57567

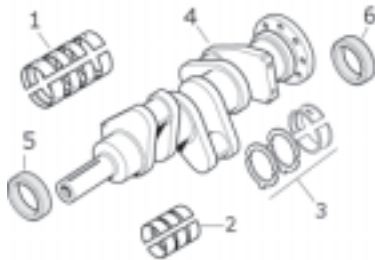

1 Main Bearings (1 set)	Standard		
	0,010"		
2 Conrod Bearings (1 set)	Standard	K207436	S.57523
	0,010"	K207497	S.57524
3 Thrust Washers (1 set)	Standard	K928542	S.57537
	0,005"	K928560	S.57538
4 Crankshaft			
5 Front Oil Seal		K628127	S.57541
6 Rear Oil Seal		K262708	S.57544



1 Conrod			
1 Conrod			
2 Small End Bush		K31669	S.57548
3 Conrod Bolt			
4 Conrod Nut			

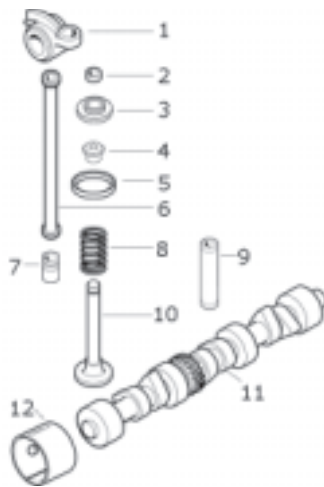

1 Rocker Arm			
1 Rocker Arm Shaft			
2 Collet		K943439	S.41413
3 Top Retainer			
3 Bottom Retainer			
4 Valve Stem Seal			
5 Inlet Valve Insert			
5 Exhaust Valve Insert			
6 Push Rod			
6 Push Rod Tube			
7 Tappet/Cam Follow er			
8 Inner Valve Spring		K921435	S.57502
8 Outer Valve Spring		K921436	S.57503
9 Inlet/Exhaust Valve Guide			
10 Inlet Valve		K928622	S.57500
10 Exhaust Valve		K928622	S.57500
11 Camshaft			
12 Camshaft Bush			



13 Oil Pump			
14 Fuel Pump		K944997	S.63034
15 Water Pump		K200759	S.57759

David Brown

AD6.329T

Cyl. 6

Bore 99,47

Height 212,72

Pin 31,75

Height 105,58

Rings 4

Additional information
Semi Finished Liner

Models: 1690T, 1594, 1694

Sparex

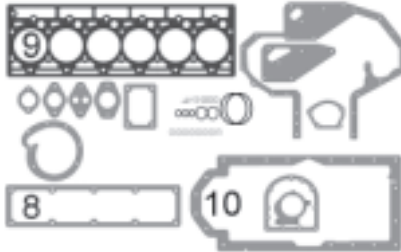

Description	Remarks	Replaces	Sparex
1 Piston and Liner Set (per Cyl.)		Order components	
2 Liner	Models 1594 / 1694	K964857	S.57504
3 Piston		K206954	S.57840
4 Ring Set	Semi Finished Liner	K261069	S.57508
5 Liner Seal			
1 Piston and Liner Set (per Cyl.)		Order componets	
2 Liner	Models 1690 / 1690T	K964857	S.57504
3 Piston		K944573	S.57507
4 Ring Set	Semi Finished Liner	K261069	S.57508
5 Liner Seal			
6 Top Gasket Set		K262766	S.57552
7 Bottom Gasket Set		K262747	S.57562
8 Rocker Cover Gasket		K918689	S.57558
9 Head Gasket		K952527	S.57555
10 Sump Gasket		K918684	S.57567
11 Timing Cover Gasket			
12 Timing Cover Gasket			

Case IH

David Brown

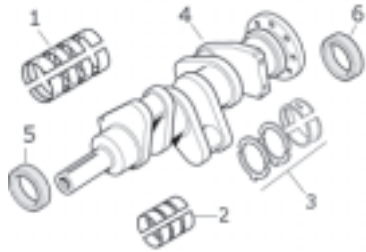

1 Main Bearings (1 set)	Standard		
	0,010"		
2 Conrod Bearings (1 set)	Standard	K207436	S.57523
	0,010"	K207497	S.57524
3 Thrust Washers (1 set)	Standard	K928542	S.57537
	0,005"	K928560	S.57538
4 Crankshaft			
5 Front Oil Seal		K628127	S.57541
6 Rear Oil Seal		K262708	S.57544

Deutz

Fendt



1 Conrod			
1 Conrod			
2 Small End Bush		K31669	S.57548
3 Conrod Bolt			
4 Conrod Nut			

Fiatagri

Ford

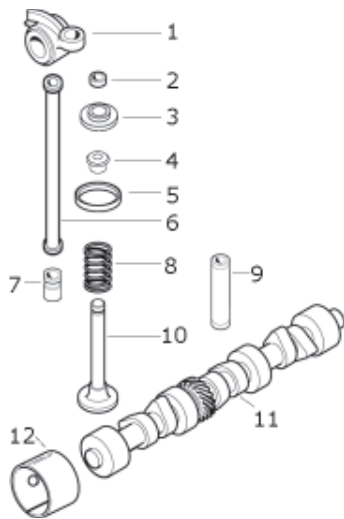

1 Rocker Arm			
1 Rocker Arm Shaft			
2 Collet		K943439	S.41413
3 Top Retainer			
3 Bottom Retainer			
4 Valve Stem Seal			
5 Inlet Valve Insert			
5 Exhaust Valve Insert			
6 Push Rod			
6 Push Rod Tube			
7 Tappet/Cam Follow er			
8 Inner Valve Spring		K921435	S.57502
8 Outer Valve Spring		K921436	S.57503
9 Inlet/Exhaust Valve Guide			
10 Inlet Valve		K928622	S.57500
10 Exhaust Valve		K950100	S.57501
11 Camshaft			
12 Camshaft Bush			

John Deere

M F

Renault



13 Oil Pump			
14 Fuel Pump			
15 Water Pump			

Zetor