

Applications	OEM Ref.	Description	Sparex No.
(780 6039>), (880 Live Drive 25306>, Non Live Drive 2984>), 885, (Selectamatic 990 15240>), 990, 995, 996, 1190, 1194, (1200 11930>), 1210, 1212, 1290, 1294, 1390, 1394, 1410, 1412, 1394, 1490, 1494, 1594, 1690 Turbo, 1694	K928622	Valve - Inlet	S.57500 1
(780 6039>), (880 Live Drive 25306>, Non Live Drive 2984>), 885, (Selectamatic 990 15240>), 990, 995, 996, 1190, 1194, (1200 11930>), 1210, 1212, 1290, 1294, 1390, 1394	K928622	Valve - Exhaust	S.57500 2
1410, 1412, 1394, 1490, 1494, 1594, 1690 Turbo, 1694	K950100	Valve - Exhaust	S.57501 2
(780 5584>), (880 Live Drive 25306>, Non Live Drive 2984>), 885, 990, 995, 996, 1190, 1194, (1200 4913>), 1210, 1212, 1290, 1294, 1390, 1394, 1410, 1412, 1490, 1494, 1594, 1690, 1690 Turbo, 1694	K921435	Valve Spring - Inner	S.57502 3
	K921436	Valve Spring - Outer	S.57503 4
(780 5584>), (880 Live Drive 25306>, Non Live Drive 2984>), 885, 990, 995, 996, 1190, 1194, (1200 4913>), 1210, 1212, 1290, 1294, 1390, 1394, 1410, 1412, 1490, 1494, 1594, 1690, 1690 Turbo, 1694	K943439	Valve - Collet	S.41413 5
770, 780, 880, 885, 990, 995, 996, 1190, 1194, 1200, 1210, 1212, 1290, 1294, 1390, 1394, 1490, 1494, 1594, 1690, 1690 Turbo, 1694	K907344	Gasket - Exhaust Manifold	S.57572 6
990, 995, 996, 1200, 1210, 1212, 1290, 1294, 1390, 1394, 1410, 1412, 1490, 1494	K907343 + K907344 x 2	Gasket Set - Exhaust Manifold	S.57844 7
770, 780, 850, 880, 885, 890, 950, 990, 995, 996, 1200, 1210, 1212, 1410, 1412	K200831	Thermostat (77°C - 81°C) (170°F - 179°F)	S.63105 8
1190, 1194, 1290, 1294, 1390, 1394, 1490, 1494, 1594, 1690, 1690 Turbo, 1694	K208039	Thermostat (82°C - 87°C) (180°F - 189°F)	S.40085 8
770, 780, 850, 880, 885, 890, 950, 990, 995, 996, 1200, 1210, 1212, 1410, 1412	K910411	Gasket - Thermostat	S.57583 9
1190, 1194, 1290, 1294, 1390, 1394, 1490, 1494, 1594, 1690, 1690 Turbo, 1694	K200225	Gasket - Thermostat	S.57711 9
770, 780, 880, (885>100009), Selectamatic 990, (990>11070000), (995, 996>11070000), 1200, (1210, 1212>11150001)	K300297	Switch - Temperature Sender	S.57592 10
(990 11070001>), (995, 996 11070001>), 1410, 1412	K952332	Switch - Temperature Sender	S.41104 10
1190, 1194, 1290, 1294, 1390, 1394, 1490, 1494, 1594, 1690, 1690 Turbo	K311943	Switch - Temperature Sender	S.57593 10
770, 780, 850, 880, 885, 890, 950, 990, 995, 996, 1190, 1194, 1200, 1210, 1212, 1290, 1294, 1390, 1394, 1410, 1412, 1490, 1494, 1594, 1690, 1690 Turbo, 1694	238-5138	O'Ring (³ / ₃₂ "x2 ¹ / ₈ ")	S.10359 11
990, 995, 996, 1200, 1210, 1212, 1290, 1294, 1390, 1394, 1410, 1412, 1490, 1494	K907343	Gasket - Exhaust Manifold	S.57573 12

Please see Index for alternative O.E. part numbers.

These parts are Sparex parts and are not manufactured by the Original Equipment Manufacturer. Original Manufacturer' name, part numbers and descriptions are quoted for reference purposes only and are not intended to indicate or suggest that our replacement parts are made by the OEM.

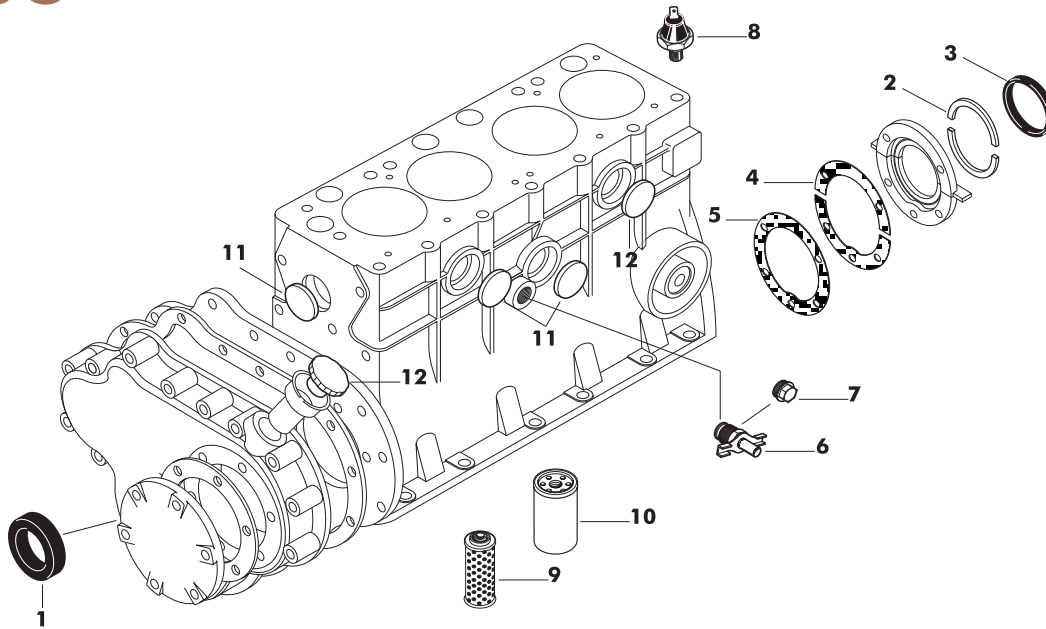

Sparex No.	Description	OEM Ref.	Applications
1	S.57541 Seal - Timing Cover (2 ¹ / ₈ "x2 ⁷ / ₈ "x ³ / ₈ ")	K628127	770, 780, 880, 885, 990, 995, 996, 1190, 1194, 1200, 1210, 1212, 1290, 1294, 1390, 1394, 1410, 1412, 1490, 1494, 1594, 1690, 1690 Turbo, 1694
2	S.57543 Rope Seal (Top & Lower)	K262783	770, 780, 880, 885, 990, 995, 996, 1190, 1194, 1200, 1210, 1212, 1290, 1294, 1390, 1394
2	S.57542 Rope Seal (Top & Lower)	K262784	1410, 1412, 1490, 1494
3	S.57544 Seal - Rear Main	K262708	1594, 1690, 1690 Turbo, 1694
4	S.57563 Gasket - Rear Main	K914404	770, 780, 880, (990>E43943), (995>E43943), (996>E57526), 1200, (1210>E455009), (1212>E20681), (1410, 1412>E120366)
4	S.57564 Gasket - Rear Main	K950938	885, (990>E43943), (995>E43943), (996>E57526), 1190, 1194, (1210>E455009), (1212>E20681), 1290, 1294, 1390, 1394, (1410, 1412>E120366), 1490, 1494
5	S.57565 Gasket - Rear Main	K200569	1594, 1690, 1690 Turbo, 1694
6	S.8440 Drain Tap (¹ / ₄ " BSP)	K622060	770, 780, 880, (885>E41055), Selectamatic 990, (990>E48463), (995>E7448), 1200, (1210, 1212>E27162Simms), (1410, 1412>E121789)
7	S.63080 Drain Plug (¹ / ₄ " BSP)	K19581	(885 E1056>), (990 E48464>), (995 E7449>), (996 E60665>), 1190, 1194, (1210, 1212 E27163 Simms>, 29321 Bosch>, 20682>), (1410, 1412 E121790>), 1290, 1294, 1390, 1394, 1490, 1494, 1594, 1690, 1690 Turbo, 1694
8	S.57588 Switch - Oil Pressure	K311686	770, 780, 850, 880, 885, 890, 950, 990, 995, 996, 1190, 1194, 1200, 1210, 1212, 1290, 1294, 1390, 1394, 1410, 1412, 1490, 1494, 159, 1690, 1690 Turbo, 1694
9	S.76287 Filter - Oil	K902125	(770 1965>1970), (780 1967>1971), 850, (880 530001>563379), 885, 890, 950, 990, 995, 996, 1200, 1210, 1212, 1410, 1412
10	S.76285 Filter - Oil (Spin On Type)	K200037	1190, 1194, 1290, 1294, 1390, 1394, 1490, 1494, 1594, 1690, 1690 Turbo, 1694
11	S.8447 Core Plug (44.75mm - 1 ³ / ₄ ") Cup Type (Mild Steel)	41-1628	770, 780, 880, 885, 990, 995, 996, 1190, 1194, 1200, 1210, 1212, 1290, 1294, 1390, 1394, 1410, 1412, 1490, 1494, 1594, 1690, 1690 Turbo, 1694
	S.14459 Core Plug (44.75mm - 1 ³ / ₄ ") Cup Type (Stainless Steel)		
12	S.57568 Cap - Oil Filler	K948427	990, 995, 996, 1194, 1200, 1210, 1212, 1290, 1294, 1390, 1394, 1410, 1412, 1490, 1494, 1594, 1690, 1690 Turbo, 1694

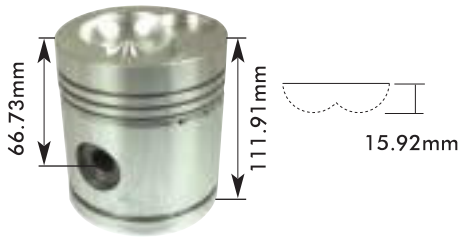

S.57505
Bore - 100.05mm



S.56934
Bore - 92.08mm

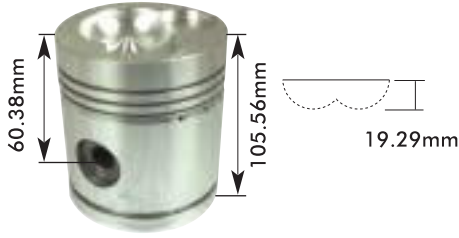

S.57506
Bore - 100.05mm



S.57507
Bore - 100.05mm



In line with historical automotive industry best practice, Sparex recommends the fitment of complete sets of engine rebuild kits in order to achieve optimal results and engine performance

Applications	Liner - Semi Finished	Piston (Standard)	Ring Set (Standard)	Piston (0.020")	Ring Set (0.020")	Piston (0.040")	Ring Set (0.040")	Piston Ring Kit (Standard)
3 Cylinder								
770 AD3/49A	S.57504 K964857	S.57505 K949721	S.57508 K261069	S.57511 K949722	S.57509 K261070	S.57514 K949723	S.57510 K261071	
780, 880, 885 AD3/55	S.57504 K964857	S.57506 K949474	S.57508 K261069	S.57512 K949719	S.57509 K261070	S.57515 K949720	S.57510 K261071	S.57712
1190, 1194 AD3/55	S.57504 K964857	S.57506 K949474	S.57508 K261069	S.57512 K949719	S.57509 K261070	S.57515 K949720	S.57510 K261071	S.57712
4 Cylinder								
30D, 880, 900 Impletmatic 950 (3 ⁵ / ₈ " Bore)	S.61562 K902001 *Including Liner Seals	S.22421 K900800	S.56850 K67922					
Impletmatic 990 (Red) AD4/47	S.61564 K906859 *Including Liner Seals	S.56934 K902667	S.56850 K67922					S.61567
990 AD4/49	S.57504 K964857	S.57505 K949721	S.57508 K261069	S.57511 K949722	S.57509 K261070	S.57514 K949723	S.57510 K261071	
995, 996 AD4/55	S.57504 K964857	S.57506 K949474	S.57508 K261069	S.57512 K949719	S.57509 K261070	S.57515 K949720	S.57510 K261071	S.57712
1200 AD4/55	S.57504 K964857	S.57506 K949474	S.57508 K261069	S.57512 K949719	S.57509 K261070	S.57515 K949720	S.57510 K261071	S.57712
1210, 1212 AD4/55	S.57504 K964857	S.57506 K949474	S.57508 K261069	S.57512 K949719	S.57509 K261070	S.57515 K949720	S.57510 K261071	S.57712

Please see Index for O.E. part numbers.

These parts are Sparex parts and are not manufactured by the Original Equipment Manufacturer. Original Manufacturer' name, part numbers and descriptions are quoted for reference purposes only and are not intended to indicate or suggest that our replacement parts are made by the OEM.



S.57504



S.61564



S.61562

Ring Set S.57508

- Chrome Plated 2.38\$ 1st
- Taper Faced 2.38\$ 2nd
- Taper Faced 2.38\$ 3rd
- Doubled Bevelled 4.76\$ 4th



Liner Seal for S.61562 and S.61564 Liner also available separate under S.7748 (K66385)

Applications	Liner - Semi Finished)	Piston (Standard)	Ring Set (Standard)	Piston (0.020")	Ring Set (0.020")	Piston (0.040")	Ring Set (0.040")	Piston Ring Kit (Standard)
(1290>11052360) AD4/49	S.57504 K964857	S.57505 K949721	S.57508 K261069	S.57511 K949722	S.57509 K261070	S.57514 K949723	S.57510 K261071	
(1290 11052361 >) AD4/55	S.57504 K964857	S.57506 K949474	S.57508 K261069	S.57512 K949719	S.57509 K261070	S.57515 K949720	S.57510 K261071	S.57712
1294 AD4/55	S.57504 K964857	S.57506 K949474	S.57508 K261069	S.57512 K949719	S.57509 K261070	S.57515 K949720	S.57510 K261071	S.57712
1390 AD4/55	S.57504 K964857	S.57506 K949474	S.57508 K261069	S.57512 K949719	S.57509 K261070	S.57515 K949720	S.57510 K261071	S.57712
1394 AD4/55T	S.57504 K964857	S.57840 K944573	S.57508 K261069	S.57838 K946354	S.57509 K261070	S.57839 K946356	S.57510 K261071	
1410, 1412 AD4/55T	S.57504 K964857	S.57840 K944573	S.57508 K261069	S.57838 K946354	S.57509 K261070	S.57839 K946356	S.57510 K261071	
1490, 1494 AD4/55T	S.57504 K964857	S.57840 K944573	S.57508 K261069	S.57838 K946354	S.57509 K261070	S.57839 K946356	S.57510 K261071	
6 Cylinder								
1594 AD3/329T	S.57504 K964857	S.57840 K206954	S.57508 K261069	S.57838 K206974	S.57509 K261070	S.57839 K946356	S.57510 K261071	
1690 AD3/329	S.57504 K964857	S.57840 K944573	S.57508 K261069	S.57838 K946354	S.57509 K261070	S.57839 K946356	S.57510 K261071	
1690 Turbo AD3/329T	S.57504 K964857	S.57840 K944573	S.57508 K261069	S.57838 K946354	S.57509 K261070	S.57839 K946356	S.57510 K261071	
1694 AD3/329T	S.57504 K964857	S.57840 K944573	S.57508 K261069	S.57838 K206974	S.57509 K261070	S.57839 K946356	S.57510 K261071	



Applications

Engine Overhaul Kit
(Un-Finished Liner)

Valve Train Kit

(780 3039>)
(880 Live Drive 25306>), (880 Non-Live Drive 2984>)
885

- S.57905**
 1 x S.57541 F/C Oil Seal
 1 x S.57543 R/C Rope Seal
 3 x S.57548 Conrod Bush
 3 x S.57506 Piston
 3 x S.57508 Ring Set
 3 x S.57504 Unfinished Liner
 1 x S.57549 Top Gasket Set
 1 x S.57563 Bottom Gasket Set
 1 x S.57564 Rear Main Gasket

- S.57900**
 3 x S.57500 Inlet Valve
 3 x S.57500 Exhaust Valve
 3 x S.57502 Inlet Spring
 3 x S.57503 Exhaust Spring
 12 x S.41413 Collet

(990 15240>)
Synchromatic 990

- S.57907**
 1 x S.57541 F/C Oil Seal
 1 x S.57543 R/C Rope Seal
 4 x S.57548 Conrod Bush
 4 x S.57505 Piston
 4 x S.57508 Ring Set
 4 x S.57504 Unfinished Liner
 1 x S.57551 Top Gasket Set
 1 x S.57561 Bottom Gasket Set
 1 x S.57563 Rear Main Gasket
 1 x S.57564 Rear Main Gasket

- S.57901**
 4 x S.57500 Inlet Valve
 4 x S.57500 Exhaust Valve
 4 x S.57502 Inlet Spring
 4 x S.57503 Exhaust Spring
 16 x S.41413 Collet

(1200 11930>)
995, 996, 1210, 1212

- S.57908**
 1 x S.57541 F/C Oil Seal
 1 x S.57543 R/C Rope Seal
 4 x S.57548 Conrod Bush
 4 x S.57506 Piston
 4 x S.57508 Ring Set
 4 x S.57504 Unfinished Liner
 1 x S.57551 Top Gasket Set
 1 x S.57561 Bottom Gasket Set
 1 x S.57563 Rear Main Gasket
 1 x S.57564 Rear Main Gasket

- S.57901**
 4 x S.57500 Inlet Valve
 4 x S.57500 Exhaust Valve
 4 x S.57502 Inlet Spring
 4 x S.57503 Exhaust Spring
 16 x S.41413 Collet

Please see Index for alternative O.E. part numbers.

These parts are Sparex parts and are not manufactured by the Original Equipment Manufacturer. Original Manufacturer' name, part numbers and descriptions are quoted for reference purposes only and are not intended to indicate or suggest that our replacement parts are made by the OEM.



Applications

Engine Overhaul Kit
(Un-Finished Liner)

Valve Train Kit

(1290>11052360)

- S.57910**
 1 x S.57541 F/C Oil Seal
 1 x S.57543 R/C Rope Seal
 4 x S.57548 Conrod Bush
 4 x S.57505 Piston
 4 x S.57508 Ring Set
 4 x S.57504 Unfinished Liner
 1 x S.57870 Top Gasket Set
 1 x S.57561 Bottom Gasket Set
 1 x S.57564 Rear Main Gasket

- S.57901**
 4 x S.57500 Inlet Valve
 4 x S.57500 Exhaust Valve
 4 x S.57502 Inlet Spring
 4 x S.57503 Exhaust Spring
 16 x S.41413 Collet

(1290 11052361>), 1294, 1390

- S.57911**
 1 x S.57541 F/C Oil Seal
 1 x S.57543 R/C Rope Seal
 4 x S.57548 Conrod Bush
 4 x S.57506 Piston
 4 x S.57508 Ring Set
 4 x S.57504 Unfinished Liner
 1 x S.57870 Top Gasket Set
 1 x S.57561 Bottom Gasket Set
 1 x S.57564 Rear Main Gasket

- S.57901**
 4 x S.57500 Inlet Valve
 4 x S.57500 Exhaust Valve
 4 x S.57502 Inlet Spring
 4 x S.57503 Exhaust Spring
 16 x S.41413 Collet

1394, 1490, 1494

- S.57912**
 1 x S.57541 F/C Oil Seal
 1 x S.57542 R/C Rope Seal
 1 x S.57543 R/C Rope Seal
 4 x S.57548 Conrod Bush
 4 x S.57840 Piston
 4 x S.57508 Ring Set
 4 x S.57504 Unfinished Liner
 1 x S.57870 Top Gasket Set
 1 x S.57561 Bottom Gasket Set
 1 x S.57564 Rear Main Gasket

- S.57902**
 4 x S.57500 Inlet Valve
 4 x S.57501 Exhaust Valve
 4 x S.57502 Inlet Spring
 4 x S.57503 Exhaust Spring
 16 x S.41413 Collet

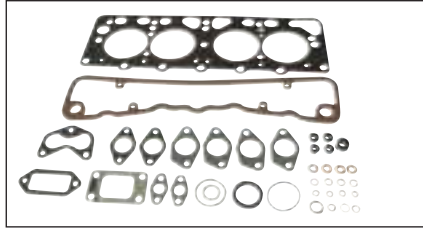

Top Gasket Set



Bottom Gasket Set

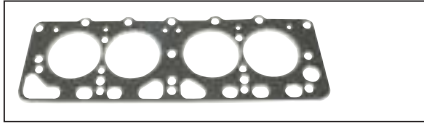

Cylinder Head Gasket



Rocker Cover Gasket

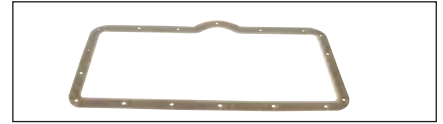

Oil Pan Gasket

Applications	Top Gasket Set	Cylinder Head Gasket	Rocker Cover Gasket	Bottom Gasket Set	Oil Pan Gasket
3 Cylinder					
770 AD3/49A	S.57549 K262754	S.57553 K956672	S.57556 K907338	S.57559 K262764	S.57566 K262733
780 AD3/55	S.57549 K262754	S.57553 K956672	S.57556 K907338	S.57559 K262764	S.57566 K262733
880 AD3/55A	S.57549 K262754	S.57553 K956672	S.57556 K907338	S.57559 K262764	S.57566 K262733
885 AD3/55	S.57549 K262754	S.57553 K956672	S.57556 K907338	S.57559 K262764	S.57566 K262733
1190 AD3/55	S.57550 K260287	S.57553 K956672	S.57556 K907338	S.57560 K260286	S.57566 K262733
1194 AD3/55	S.57550 K260287	S.57553 K956672	S.57556 K907338	S.57560 K260286	S.57566 K262733
4 Cylinder					
Implementac 880, Implementac 950		S.57423		S.57424	
Impletmatic 990 AD4/47	S.56935 K961001		S.57557 K905229	S.56936	
990 AD4/49	S.57551 K262752 K262767	S.57554 K262750	S.57557 K905229	S.57561 K262765	S.57567 K918684
995 AD4/55	S.57551 K262752	S.57554 K262750	S.57557 K905229	S.57561 K262765	S.57567 K918684
996 AD4/55	S.57551 K262752	S.57554 K262750	S.57557 K905229	S.57561 K262765	S.57567 K918684
1200 AD4/55	S.57551 K262752	S.57554 K262750	S.57557 K905229	S.57561 K262765	S.57567 K918684
1210 AD4/55	S.57551 K262752	S.57554 K262750	S.57557 K905229	S.57561 K262765	S.57567 K918684
1212 AD4/55	S.57551 K262752	S.57554 K262750	S.57557 K905229	S.57561 K262765	S.57567 K918684
1290 AD4/49 AD4/55	S.57551 K262752	S.57554 K262750	S.57557 K905229	S.57561 K262765	S.57567 K918684
1294 AD4/55	S.57551 K262752	S.57554 K262750	S.57557 K905229	S.57561 K262765	S.57567 K918684

Please see Index for alternative O.E. part numbers.

These parts are Sparex parts and are not manufactured by the Original Equipment Manufacturer. Original Manufacturer' name, part numbers and descriptions are quoted for reference purposes only and are not intended to indicate or suggest that our replacement parts are made by the OEM.

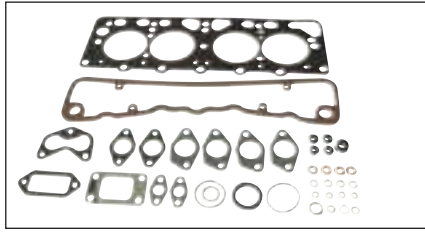

Top Gasket Set

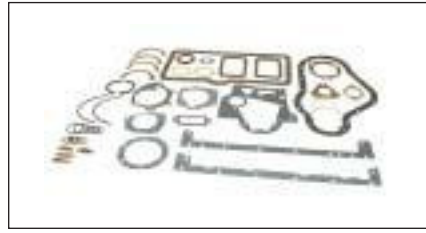

Bottom Gasket Set

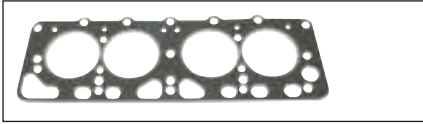

Cylinder Head Gasket



Rocker Cover Gasket

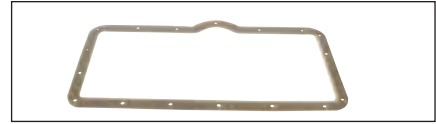

Oil Pan Gasket

Applications	Top Gasket Set	Cylinder Head Gasket	Rocker Cover Gasket	Bottom Gasket Set	Oil Pan Gasket
1390 AD4/55	S.57551 K262752	S.57554 K262750	S.57557 K905229	S.57561 K262765	S.57567 K918684
1394 AD4/55T	S.57551 K262752	S.57554 K262750	S.57557 K905229	S.57561 K262765	S.57567 K918684
1410 AD4/55T	S.57551 K262752	S.57554 K262750	S.57557 K905229	S.57561 K262765	S.57567 K918684
1412 AD4/55T	S.57551 K262752	S.57554 K262750	S.57557 K905229	S.57561 K262765	S.57567 K918684
1490 AD4/55T	S.57551 K262752	S.57554 K262750	S.57557 K905229	S.57561 K262765	S.57567 K918684
1494 AD4/55T	S.57551 K262752	S.57554 K262750	S.57557 K905229	S.57561 K262765	S.57567 K918684
6 Cylinder					
1594 AD6/329T	S.57552 K262766	S.57555 K952527 (x2)	S.57558 K918689 (x2)	S.57562 K262747	S.57567 K918684
1690 AD6/329	S.57552 K262766	S.57555 K952527 (x2)	S.57558 K918689 (x2)	S.57562 K262747	S.57567 K918684
1690 Turbo AD6/329T	S.57552 K262766	S.57555 K952527 (x2)	S.57558 K918689 (x2)	S.57562 K262747	S.57567 K918684
1694 AD6/329T	S.57552 K262766	S.57555 K952527 (x2)	S.57558 K918689 (x2)	S.57562 K262747	S.57567 K918684



S.14761

*For sealing flanges and gaskets on close fitting, rigid machined parts.
 *Any shape or size of gasket can be made, replacing the need for pre-cut gaskets.
 *For close fitting parts up to 0.5mm gap.
 *Resists temperatures up to 120°C.



S.14767

*A non-hardening sealant used to seal all types of pre-cut gaskets.
 *Resists temperatures up to 200°C.



S.19206

*An aerosol type gasket remover which will remove cured gasketing products. It can also be used to remove traditional paper and cork gaskets which have split on dismantling or have baked on the flange.



S.14768

*Blue silicone gasket.
 *Forms a perfect replacement gasket or dressing.
 *Resistant to high temperatures and engine fluids.
 *Non shrinking, remains flexible.



For full range of Sparex Loctite products, please refer to our Sparex Accessories Catalogue

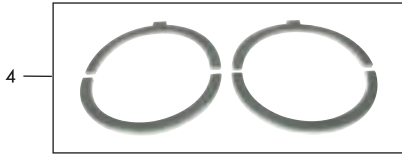
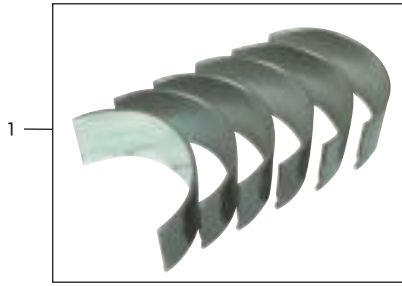

⚠ Connecting Rod Bearings and Main Bearings are supplied in Engine Set

Applications	OEM Ref.	Description	Sparex No.	
770, 780, 880, 885, 1190, 1194 (3 Cylinder Models)	K207436 (x6)	Con Rod Bearing Kit (Std.) Con Rod Bearing Kit (+ 0.010") Con Rod Bearing Kit (+ 0.020")	S.57517 S.57518 S.57519	1
Implematic 990 AD4/47 Engine	K907414	Con Rod Bearing Kit (Std.) Con Rod Bearing Kit (+ 0.010") Con Rod Bearing Kit (+ 0.020")	S.57465 S.57471 S.57472	1
990, 995, 996, 1200, 1210, 1212, 1290, 1294, 1390, 1394 (4 Cylinder Models)	K207436 (x8)	Con Rod Bearing Kit (Std.) Con Rod Bearing Kit (+ 0.010") Con Rod Bearing Kit (+ 0.020") Con Rod Bearing Kit (+ 0.030") Con Rod Bearing Kit (+ 0.040")	S.57520 S.57521 S.57522 S.57402 S.57403	1
1410, 1412, 1490, 1494 (4 Cylinder Models)	K929148 (x8)	Con Rod Bearing Kit (Std.) Con Rod Bearing Kit (+ 0.010") Con Rod Bearing Kit (+ 0.020")	S.57799 S.75989 S.75994	1
1594, 1690, 1690 Turbo, 1694 (6 Cylinder Models)	K207436 (x12)	Con Rod Bearing Kit (Std.) Con Rod Bearing Kit (+ 0.010") Con Rod Bearing Kit (+ 0.020")	S.57523 S.57524 S.57525	1
770, 780, 850, 880, 885, 890, 950, 990, 995, 996, 1190, 1194, 1200, 1210, 1212, 1290, 1294, 1390, 1394, 1410, 1412, 1490, 1494, 1594, 1690, 1690 Turbo, 1694	K31669	Small End Bush	S.57548	2
770, 780, 880, 885, 1190, 1194	K928540 (x8)	Main Bearing Kit (Std.) Main Bearing Kit (+ 0.010") Main Bearing Kit (+ 0.020")	S.57526 S.57529 S.57533	3
990 Implematic, 990, 995, 996, 1200, 1210, 1212, 1290, 1294, 1390, 1394	K928541 (x6)	Main Bearing Kit (Std.) Main Bearing Kit (+ 0.010") Main Bearing Kit (+ 0.020") Main Bearing Kit (+ 0.030")	S.57527 S.57530 S.57532 S.57404	3
1410, 1412, 1490, 1494	K928997 (x8)	Main Bearing Kit (Std.) Main Bearing Kit (+ 0.010") Main Bearing Kit (+ 0.020")	S.75991 S.75992 S.75993	3
770, 780, 880, 885, 990, 995, 996, 1190, 1194, 1200, 1210, 1212, 1290, 1294, 1390, 1394	K928542 K928543	Thrust Washer (Std.)	S.57537	4
770, 780, 880, 885, 990, 995, 996, 1190, 1194, 1200, 1210, 1212, 1290, 1294, 1390, 1394	K928560 K928561	Thrust Washer (+ 0.050")	S.57538	4
995, 996, 1200, 1210, 1212, (1290 with continuous clutch 11052410>), (1290 with independent clutch 11052360>), 1294, (1390 11120001>), 1394 Engine - AD4/55	K210100	Crankshaft (Less Bearing & Washer)	S.57959	5
990 Implematic AD4/47 Engine	K961007	Crankshaft	S.22513	5
990 Engine - AD4/49	K962224	Crankshaft (Less Bearing & Washer)	S.57960	5

Please see Index for alternative O.E. part numbers.

These parts are Sparex parts and are not manufactured by the Original Equipment Manufacturer. Original Manufacturer' name, part numbers and descriptions are quoted for reference purposes only and are not intended to indicate or suggest that our replacement parts are made by the OEM.