

80° Constant Velocity Driveline

Constant Velocity Driveline Replacement Chart

Weasler Category	Weasler Series	Replacement For
3	14	Bondioli & Pavesi 4 Series Walterscheid 2370 Series
5	44	Bondioli & Pavesi 6 Series Walterscheid 2480 Series
6	55	Bondioli & Pavesi 8 Series Walterscheid 2580 Series

Ordering Instructions for CV Driveline

Determine the overall length of the driveline in a closed position. Next select the stock number which closely corresponds with the appropriate series and length. Driveline furnished without Cross & Bearing Kit and Implement Yoke. When Cross & Bearing Kit and implement yoke are assemble, the overall length of driveline will be 48", 67" or 79".

SPECIAL ORDER PARTS

The chart lists the approximate size replacement for Constant Velocity Drivelines. These are not an exact interchange and should be used as a general replacement guide only.

Complete Drivelines

Stock Number	Series	Shaft Size	A Overall Driveline Length	Max Overall Operating Length	Tractor Yoke
14501448	14	1" x 1 1/8"	48"	67"	1 3/8" x 6
14601448	14	1" x 1 1/8"	48"	67"	1 3/8" x 21
14501467	14	1" x 1 1/8"	48"	86"	1 3/8" x 6
14601467	14	1" x 1 1/8"	48"	86"	1 3/8" x 21
14503548	35	1 11/16" x 20"	48"	67"	1 3/8" x 6
14603548	35	1 11/16" x 20"	48"	67"	1 3/8" x 21
14703548	35	1 11/16" x 20"	48"	67"	1 3/4" x 20
14503567	35	1 11/16" x 20"	67"	84"	1 3/8" x 6
14603567	35	1 11/16" x 20"	67"	84"	1 3/8" x 21
14703567	35	1 11/16" x 20"	67"	84"	1 3/4" x 20
14503579	35	1 11/16" x 20"	79"	96"	1 3/8" x 6
14603579	35	1 11/16" x 20"	79"	96"	1 3/8" x 21
14703579	35	1 11/16" x 20"	79"	96"	1 3/8" x 20
14504448	44	1 11/16" x 20"	48"	67"	1 3/8" x 6
14604448	44	1 11/16" x 20"	48"	67"	1 3/8" x 21
14704448	44	1 11/16" x 20"	48"	67"	1 3/4" x 20
14504467	44	1 11/16" x 20"	67"	84"	1 3/8" x 6
14604467	44	1 11/16" x 20"	67"	84"	1 3/8" x 21
14704467	44	1 11/16" x 20"	67"	84"	1 3/4" x 20
14504479	44	1 11/16" x 20"	79"	96"	1 3/8" x 6
14604479	44	1 11/16" x 20"	79"	96"	1 3/8" x 21
14704479	44	1 11/16" x 20"	79"	96"	1 3/4" x 20
14505548	55	1 11/16" x 20"	48"	67"	1 3/8" x 6
14605548	55	1 11/16" x 20"	48"	67"	1 3/8" x 21
14705548	55	1 11/16" x 20"	48"	67"	1 3/4" x 20
14505567	55	1 11/16" x 20"	67"	84"	1 3/8" x 6
14605567	55	1 11/16" x 20"	67"	84"	1 3/8" x 21
14705567	55	1 11/16" x 20"	67"	84"	1 3/4" x 20
14505579	55	1 11/16" x 20"	79"	96"	1 3/8" x 6
14605579	55	1 11/16" x 20"	79"	96"	1 3/8" x 21
14705579	55	1 11/16" x 20"	79"	96"	1 3/4" x 20

**80° Constant Velocity Driveline**

**Tractor Yokes  
Safety Slide Lock**

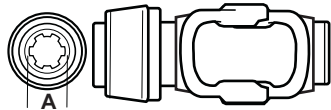

Stock Number	Series	A Bore
107-3506	35/44	1 3/8" x 6
107-3521	35/44	1 3/8" x 21
107-5506	55	1 3/8" x 6
107-3506	35/44	1 3/8" x 6

**Shaft  
1 11/16" x 20 Spline  
Induction Hardened**

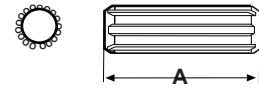

Stock Number	Series	Length
404-2720	35/44/55	3'

**Spring-Lok**

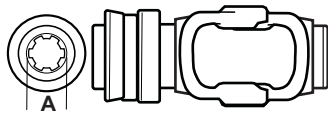

Stock Number	Series	A Bore
108-1406	14	1 3/8" x 6
108-1421	14	1 3/8" x 21

**Center Housing**

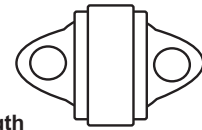

Stock Number	Series	Length
550-1430	14	
550-3545	35/44	
550-5556	55	

**Quick  
Disconnect**

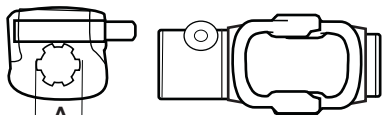

Stock Number	Series	A Bore
109-3506	35/44	1 3/8" x 6
109-3520	35/44	1 3/4" x 20
109-5520	55	1 3/4" x 20

**Yoke & Shaft  
Fits all Corresponding  
Series Tube Assemblies**

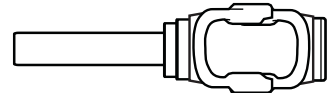

Stock Number	Series	Shaft	Length
10101400	14	1" x 1 1/8" Rect	27 1/4"
10103500	35/44	1 11/16" x 20 Spline	27"
10105500	55	1 11/16" x 20 Spline	27"

**Cross & Bearing Kit**

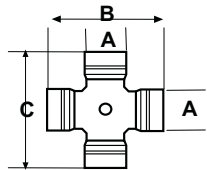

Stock Number	A	B	C	D
200-1430	1 1/8"	2 5/8"	4 1/4"	-
200-3545	1 1/4"	3 7/32"	4 5/16"	-
200-5556	1 5/16"	4 5/16"	3 47/64"	1 17/32"

**Yoke Tube & Sleeve Assembly**

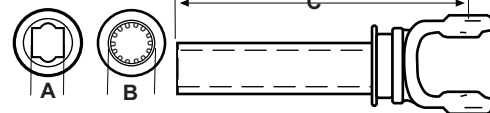

Stock Number	Series	A or B Bore	C Length
11101448	14	1" x 1 1/8" Rect	48"
11101467	14	1" x 1 1/8" Rect	67"
11103548	35	1 11/16" x 20 Spline	48"
11103579	35	1 11/16" x 20 Spline	79"
11104448	44	1 11/16" x 20 Spline	48"
11104467	44	1 11/16" x 20 Spline	67"
11104479	44	1 11/16" x 20 Spline	79"
11105548	55	1 11/16" x 20 Spline	48"
11105567	55	1 11/16" x 20 Spline	67"
11105579	55	1 11/16" x 20 Spline	79"

**Shaft  
1 x 1 1/8" Rectangular**

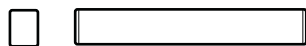

Stock Number	Series	Length
400-1618	14	6'

80° Constant Velocity Driveline

Joint & Shaft

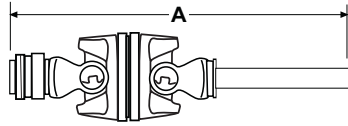

Stock Number	Series	Shaft	Length
15501406	14	1" x 1 1/8" Rect	27 1/4"
15601421	14	1" x 1 1/8" Rect	27 1/4"
15503506	35/44	1 1/16" x 20 Spline	27"
15603521	35/44	1 1/16" x 20 Spline	27"
15703520	35/44	1 1/16" x 20 Spline	27"
15505506	55	1 1/16" x 20 Spline	27"
15605521	55	1 1/16" x 20 Spline	27"
15705520	55	1 1/16" x 20 Spline	27"

Joint & Half Shaft with Guard

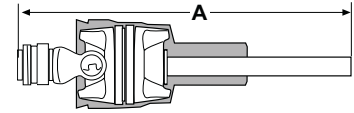

Stock Number	Series	Shaft	Length
16501406	14	1" x 1 1/8" Rect	27 1/4"
16601421	14	1" x 1 1/8" Rect	27 1/4"
16503506	35/44	1 1/16" x 20 Spline	27"
16603521	35/44	1 1/16" x 20 Spline	27"
16703520	35/44	1 1/16" x 20 Spline	27"
16505506	55	1 1/16" x 20 Spline	27"
16605521	55	1 1/16" x 20 Spline	27"
16705520	55	1 1/16" x 20 Spline	27"

Yoke, Tube & Sleeve with Guard

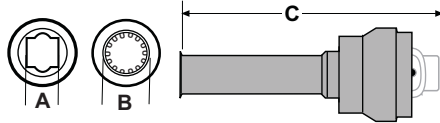

Stock Number	Series	A or B Bore	C Length
17501448	14	1" x 1 1/8" Rect	48"
17501467	14	1" x 1 1/8" Rect	67"
17503548	35	1 1/16" x 20 Spline	48"
17503567	35	1 1/16" x 20 Spline	67"
17503579	35	1 1/16" x 20 Spline	79"
17504448	44	1 1/16" x 20 Spline	48"
17504467	44	1 1/16" x 20 Spline	67"
17504479	44	1 1/16" x 20 Spline	79"
17505548	55	1 1/16" x 20 Spline	48"
17505567	55	1 1/16" x 20 Spline	67"
17505579	55	1 1/16" x 20 Spline	79"