

## 6 Series

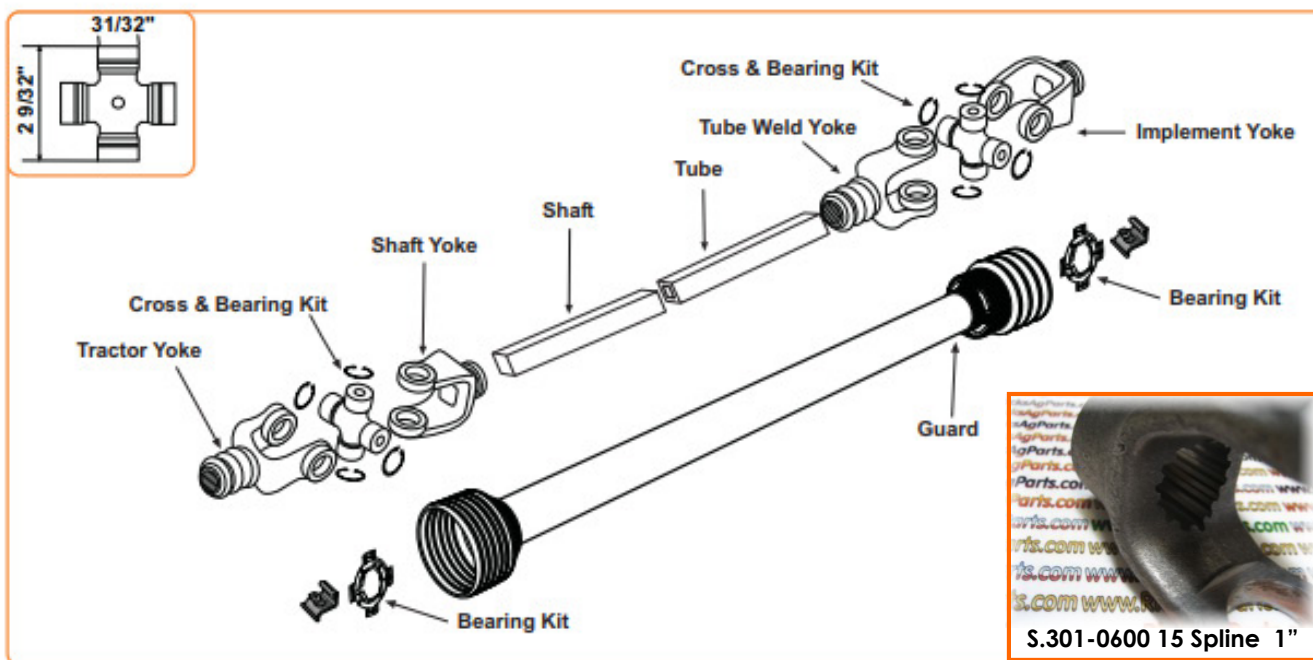

### Tractor Yoke



Stock Number	A Bore	Spline	
S.100-0606	1 3/8"	6	Spring-Lok
S.100-0621	1 3/8"	21	Spring-Lok

### Tractor Yoke Lawn & Garden



Stock Number	A Bore	Male Spline
S.106-0615	1"	15

### Tractor Yoke Quick Disconnect

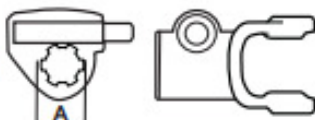

Stock Number	A Bore	Spline
S.102-0606	1 3/8"	6
S.102-0621	1 3/8"	21

### Cross & Bearing Kit Internal Lock

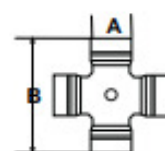

Stock Number	A	B
S.200-0600	31/32"	2 9/32"

### Tractor Yoke Lawn & Garden



Stock Number	A Bore	Spline	
S.105-0615	1"	15	Spring Lok
S.101-0615	1"	15	Auto Lok

### Shaft Weld Yoke With Bearing Groove



Stock Number	A Bore
S.300-0600	3/4" x 7/8"

**6 Series**

**Shaft**



Stock Number	Length	Diameter
S.400-1214	6'	3/4 x 7/8
S.404-1214	3'	3/4 x 7/8
S.404-1615H	3'	1 x 15 Spline

**Slip Sleeve  
With Grease Groove**

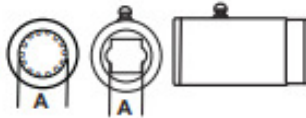

Stock Number	A Bore	Fits Tube Size
S.510-0600	3/4" x 7/8"	1 1/2" (.065 Wall)
S.510-0615	1" x 15 Spline	1 1/2" (.065 Wall)

**Tube  
1" x 1 1/8" OD**



Stock Number	Length	Fits Shaft
S.600-1618	6'	3/4" x 7/8"
S.604-1618	3'	3/4" x 7/8"

**Tube  
1 1/2" Round OD  
(.065 Wall)**



Stock Number	Length
S.602-0600	6'

**Tube Weld Yoke  
With Bearing Groove**



Stock Number	A Bore	B Bore	Fits Tube Size
S.700-0600	1" x 1 1/8"		
S.701-0600		1"	1 1/2" (.065 Wall)
S.702-0600* (*less Bearing Groove)		Solid	1 1/2" (.065 Wall)

**Implement Yoke -  
Round/Hexagon  
Bore with Keyway  
& Set Screw**

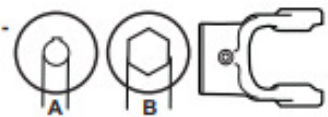

Stock Number	A Bore	B Bore	Standard Keyway
S.800-0610	5/8"	-	3/16"
S.800-0612	3/4"	-	3/16"
S.800-0613	13/16"	-	3/16"
S.800-0614	7/8"	-	3/16"
S.800-0615	15/16"	-	1/4"
S.800-0616	1"	-	1/4"
S.800-0618	1 1/8"	-	1/4"
S.800-0619	1 3/16"	-	1/4"
S.800-0620	1 1/4"	-	1/4"
S.15-5172	-	1 1/8"	-

**Spline Bore  
With 1/4" Pin Hole**



Stock Number	A Bore	Spline
S.801-0606	1 3/8"	6
S.801-0618	1 1/8"	6

**Shear Pin  
With 1/4" Pin Hole**



Stock Number	A Bore
S.802-0616	1"
S.802-0618	1 1/8"
S.802-0620	1 1/4"

**Square Bore  
With Set Screw**



Stock Number	A Bore
S.804-0612	3/4"
S.804-0614	7/8"
S.804-0616	1"
S.804-0618	1 1/8"
S.804-0620	1 1/4"

## 6 Series

### Round Bore - Double Keyway & Set Screw

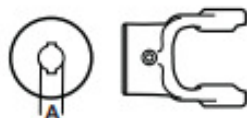

Stock Number	A Bore	Double Keyway
S.806-0612	3/4"	3/16" & 1/4"
S.806-0613	13/16"	3/16" & 1/4"
S.806-0614	7/8"	3/16" & 1/4"
S.806-0616	1"	3/16" & 1/4"
S.806-0618	1 1/8"	1/4" & 5/16"
S.806-0620	1 1/4"	1/4" & 5/16"

### Yoke & Shaft Assembly

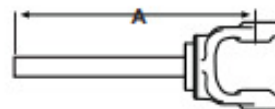

Stock Number	Shaft Size	Spline	A Length
S.10000610	1"	15	12 1/2"
S.10000648	3/4" x 7/8"		39"

### Clamp Yoke With Bolt Hole & Set Screw

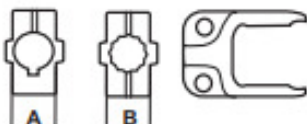

Stock Number	A Bore	B Bore	Keyway	Spline
S.807-0615		1"		15
S.807-0616	1"		1/4"	

### Yoke & Tube Assembly 1" x 1 1/8" Tube

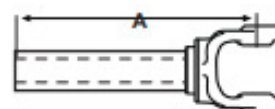

Stock Number	Fits Shaft	A Length
S.11000648	3/4" x 7/8"	38 3/4"

### Slip Sleeve Yoke

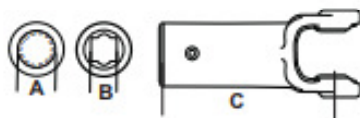

Stock Number	A Bore	B Bore	C Length
S.808-0612		3/4" Sq.	5 1/2"
S.808-0614		7/8" Sq.	5 1/2"
S.812-0615	1" x 15 Spline		
S.813-0600		3/4" x 7/8"	5 1/2"

### Universal Joint - Spring Lok to Shaft Weld Yoke



Stock Number	A Bore	B Bore
S.15060600	1 3/8" x 6"	3/4" x 7/8"

### Guard - 250 Plastic



Stock Number	Overall Length
S.59605	29 1/2"
S.59606	39 1/2"
S.59607	51 1/2"

### Universal Joint - Tube Weld Yoke to Implement Yoke - Round Bore Furnished with Keyway & Set Screw



Stock Number	A Bore	B Bore
S.15000616	1" x 1 1/8"	1"

### Bearing Kit - 250

Stock Number	Kit Contains
S.22566	2 x A=46.4mm ID Bearings, 2 x S.56509 Nipple Locks



### Universal Joint - Round To Round Furnished with Keyway & Set Screw

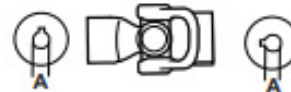

Stock Number	A Bore
S.15120612	3/4"
S.15160616	1"