



Tractor / Combine Model to Engine Index

	Model	Engine	Cyl	Page	Model	Engine	Cyl	Page	Model	Engine	Cyl	Page	Model	Engine	Cyl	Page
Case IH	TE20	80mm	4		255	AD3.152	3	182	393	A4.248	4	196	2680	AT6.354.4	6	206
	TEA20	85mm-Petr.	4	183	260	AD4.203	4	189	394F	A4.248	4	196	2685	AT6.354.4	6	206
	TED20	85mm-VO	4	183	263	AT3.152.4			397	A4.248	4	196	2720	AT6.354.4	6	206
	TEF20	20C	4	185	265	A4.236	4	192	398	AT4.236	4	194	2725	AT6.354.4	6	206
	30	A4.107	4	187	273	A4.236	4	192	399	A6.354.4	6	205	3050	A4.236	4	192
David Brown	FE35	23C	4	186	274	A4.236	4	192	500 MD	A6.354	6	201	3060	A4.248	4	196
	35	A3.152	3	181	274-4	A4.236	4	192	510 MD	A6.354	6	201	3065	AT4.236	4	194
	35X	A3.152	3	181	274S	A4.236	4	192	515 MD	A6.354	6	201	3070	AT4.236	4	194
	50B	A4.212	4	191	274SK	A4.236	4	192	520 MD	A6.354	6	201	3075	1004.4T	4	199
	65	A4.192	4	188	274-4SK	A4.236	4	192	525 MD	A6.354	6	201	3080	A6.354.4	6	205
Deutz	65	AD4.203	4	190	275	A4.236	4	192	530 MD	A6.354.4	6	205	3085	1006.60	6	207
	65	A4.203	4	189	283	A4.236	4	192	550	AD3.152	3	182	3090	A6.354.4	6	205
	765	A4.192	4	188	284	A4.236	4	192	560	AT4.236	4	194	3095	1006.60	6	207
	130	A4.107	4	187	284S-4S	A4.236	4	192	560 MD	AT6.354.4	6	206	3115	1006.60	6	207
	133	A3.144	3	180	285	A4.248	4	196	565	A4.236	4	192	3120	1006.60T	6	208
Fendt	135	A3.144	3	180	285	A4.318	4	198	565	AT6.354.4	6	206	3120T	1006.60T	6	208
	135	AD3.152	3	181	290	A4.248	4	196	575	A4.236	4	192	3125	1006.60T	6	208
	135, 35	87mm	4	184	293	A4.248	4	196	590	A4.248	4	196	3140	1006.60T	6	208
	135V	A3.152	3	181	294	A4.248	4	196	595	A4.318	4	198	3610	A6.354.4	6	205
	148	AD3.152	3	182	294-4	A4.248	4	196	595 MKII	A4.318	4	198	3630	AT6.354.4	6	206
Fiatagri	150	AD3.152	3	182	294-4S	A4.248	4	196	660 MD	AT6.354	6	206	3635	1006.60T	6	208
	152	AD3.152	3	182	294S	A4.248	4	196	665 MD	AT6.354	6	206	3645	1006.60T	6	208
	152S	AD3.152	3	182	294S-4S	A4.248	4	196	675	A4.236	4	192	3650	AT6.354.4	6	206
	152MK3	AD3.152	3	182	298	A4.318.2	4		690	A4.248	4	196	3655	1006.60T	6	208
	154-4	AD3.152	3	182	340	AD3.152	3	182	698	A4.318.2	4		4225	1004.41	4	
Ford	155	AD4.203	4	190	342	AD3.152	3	182	698T	AT4.236	4	194	4235	1004.41	4	
	158	AD4.203	4	190	350	AD3.152	3	182	699	A6.354.4	6	205	4240	1004.41	4	
	165	AD4.203	4	190	352	AT3.152.4	3		750 MD	AT6.354	6	206	4245	1004.41	4	
	165	A4.212	4	191	352	AT3.152	3		760 MD	AT6.354	6	206	4255	1004.41	4	
	168	A4.236	4	192	353	AT3.152	3		765	A4.203	4	189	4260	1006.60	6	207
John Deere	174	A4.236	4	192	354	AD3.152	3	182	765	AD4.203	4	190	4265	1004.41	4	
	174-4S	A4.236	4	192	355	AT3.152	3		820 MD	AT6.354	6	206	4270	1006.60	6	207
	175	A4.236	4	192	360	AT3.152.4	3		825 MD	AT6.354	6	206	6110	1004.41	4	
	178	A4.236	4	192	362	A4.236	4	192	830 MD	AT6.354	6	206	6130	1004.4T	4	200
	178	A4.248	4	196	362N	A4.236	4	192	835 MD	AT6.354	6	206	6140	1004.4T	4	200
M F	184	A4.236	4	192	363	AT3.152	3		840 MD	AT6.354	6	206	6150	1004.4T	4	200
	184-4	A4.236	4	192	365	A4.236	4	192	845 MD	AT6.354	6	206	6160	1006.60	6	207
	184-4S	A4.236	4	192	372	A4.236	4	192	1004	A4.318.2	4		6170	1006.60	6	207
	185	A4.248	4	196	372N	A4.236	4	192	1007	AT4.236	4	194	6180	1006.60T	6	208
	188	A4.248	4	196	373	A4.236	4	192	1014	A6.354.1	6	203	6190	1006.60T	6	208
Renault	194	A4.248	4	196	373S	A4.236	4	192	1080	A4.318	4	198	6235	1004.40T	4	200
	194-4F	A4.248	4	196	374	A4.236	4	192	1100	A6.354	6	201	6245	1004.40T	4	200
	174 V	A4.236	4	192	374S	A4.236	4	192	1105	A6.354.1	6	203	6255	1004.40T	4	200
	230	AD3.152	3	182	375	A4.236	4	192	1105	A6.354.1	6	203	6260	1006.60	6	207
	233	AD3.152	3	182	377	A4.236	4	192	1114	A6.354.4	6	205	6265	1004.40T	4	200
Zetor	234S	AD3.152	3	182	382	A4.248	4	196	1130	AT6.354.1	6	204	6270	1006.60T	6	208
	235	AD3.152	3	182	382N	A4.248	4	196	1134	AT6.354.4	6	206	6280	1006.60T	6	208
	240	AD3.152	3	182	383	A4.248	4	196	1135	AT6.354.1	6	204	6290	1006.60T	6	208
	240	A4.236	4	192	383	A4.236	4	192	1200	A6.354.1	6	203	8110	1006.60T	6	208
	245	AD3.152	3	182	383S	A4.248	4	196	1250	A6.354.4	6	205	8120	1006.60T	6	208
	250	AD3.152	3	182	384S	A4.236	4	192	2135	AD3.152	3	181	8130	1006.60T	6	208
	253	AD3.152	3	182	387	A4.236	4	192	2620	A6.354.4	6	205	8140	1006.60T	6	208
	254	AD3.152	3	182	387	A4.248	4	196	2640	A6.354.4	6	205	8150	1006.60T	6	208
	254-4	AD3.152	3	182	390	A4.248	4	196	2645	A6.354.4	6	205	8220	1006.60T	6	208
	254S	AD3.152	3	182	390T	AT4.236	4	194	2675	A6.354.4	6	205				



Case IH

David Brown

Deutz

Fendt

Fiatagri

Ford

John Deere

M F

Renault

Zetor



Piston Type

A

B

C

Liner details		Rings	Height	Pin
Piston	Combustion chamber		mm	mm
S.40403	A	5	108,04	31,75
S.40404	A	5	108,09	31,75
S.40405	B	5	109,37	31,75
S.40406	C	4	109,25	31,75
S.40407	C	4	127,28	34,93
S.40408	C	3	116,13	34,93
S.40409	C	5	120,65	34,93
S.40410	C	5	121,10	34,93
S.40411	C	4	120,69	34,93
S.40412	B	5	120,69	34,93
S.40413	B	5	120,23	34,93
S.40414	B	4	120,42	34,93
S.41540	C	3	120,72	34,93
S.42197	B	3	120,69	34,93
S.42199	B	3	120,73	34,93
S.42436	Square	3	108,06	38,10
S.42198	C	3	108,25	38,03
S.42937	Square	5	108,14	34,92

Liner Type

1

2

3

4

Piston details		H mm	D 1 mm	D 2 mm
Liner	Rim type	Height	inside	outside
S.40431	1	215,90	91,49	93,67
S.40432	2	215,90	91,49	93,66
S.40433	2	215,90	88,93	93,71
S.40434	3	226,22	98,48	103,18
S.40436	4	223,90	101,07	103,26
S.40437	3	227,27	101,07	104,20
S.41373	2	226,52	98,48	103,18
S.41375	2	226,52	101,22	104,20
S.42431	2	226,44	100,06	104,33



Description	Remarks	Replaces	Sparex
1 Piston and Liner Set (per Cyl.)			S.40446
2 Liner			S.40433
3 Piston		739845M91	S.40404
4 Ring Set (5 rings)		745823M91	S.40418

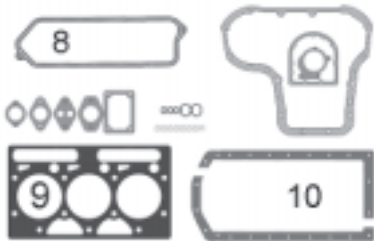

Top Gasket Set		747166M91	S.40588
Bottom Gasket Set		83400	S.40604
8 Rocker Cover Gasket		731273M1	S.40630
9 Head Gasket		747166M91	S.40619
10 Sump Gasket			

Case IH

David Brown

Deutz

Fendt

Fiatagri

Ford

John Deere

M F

Renault

Zetor

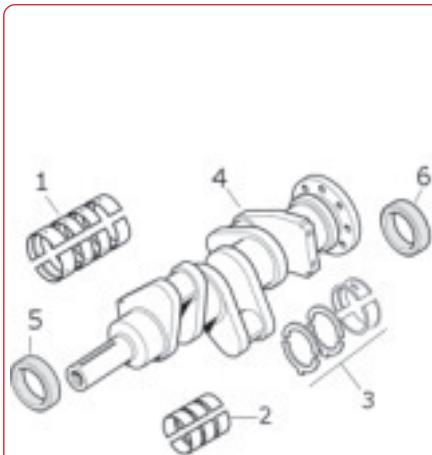

1 Main Bearings (1 set)	Standard	746156M91	S.40331	
	0,010"	746157M91	S.40332	
	0,020"	746158M91	S.40333	
	0,030"	746159M91	S.40334	
2 Conrod Bearings (1 set)	Standard	737070M91	S.40315	
	0,010"	737071M91	S.40316	
	0,020"	737072M91	S.40317	
	0,030"	737073M91	S.40318	
3 Thrust Washers (1 set)	Standard	735112/13M1	S.40343	
	0,007"	735800/01M1	S.40344	
4 Crankshaft (Rope Seals)	>390144DL	3647454M91	S.40309	
4 Crankshaft	390145DL>	3637410M91	S.40313	
	Lock Tab	731192M1	S.40347	
	Ring Gear	731008M1	S.40364	
5 Front Oil Seal	Viton	1447689M1	S.40352	
6 Rear Oil Seal	Black Viton	1447691M1	S.40356	
	Rear Oil Seal	Rope	735866M1	S.40354



1 Conrod		3637439M91	S.40357
2 Small End Bush		740407M1	S.40360
3 Conrod Bolt and Nut		375756X1	S.40362
4 Conrod Nut		377185X1	S.41328

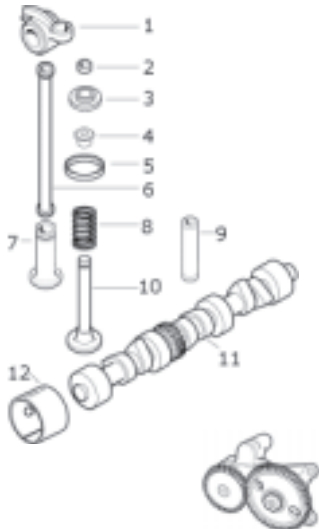

1 Rocker Arm (LH)			
1 Rocker Arm (RH)			
2 Collet		731155M1	S.41412
3 Valve Retainer			
4 Valve Stem Seal			
5 Valve Insert / Seal			
7 Tappet/Cam Follow er		731150M1	S.41345
8 Inner Valve Spring		731153M1	S.40500
8 Outer Valve Spring		731154M1	S.40505
9 Valve Guide		732445M1	S.40495
10 Inlet Valve		731151M1	S.40475
10 Exhaust Valve		731152M1	S.40485
11 Camshaft		733507M1	S.41507
12 Camshaft Bush			
13 Oil Pump		736513M91	S.5934

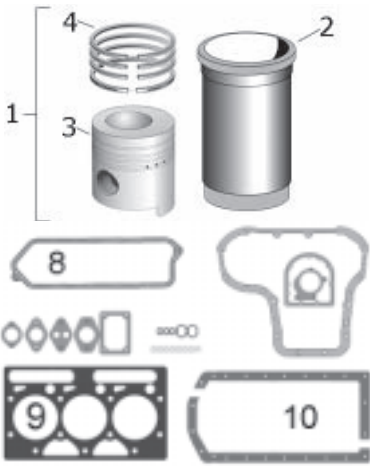

Description	Remarks	Replaces	Sparex
1 Piston and Liner Set (per Cyl.)		3639471M1	S.40444
2 Liner	>1935853	732638M1	S.40431
3 Piston	Chrome Liner	734460M91	S.40403
4 Ring Set (5 rings)		745819M1	S.40416
1 Piston and Liner Set (per Cyl.)		3640482M91	S.40445
2 Liner	1935853>	739043M1	S.40432
3 Piston	Cast Liner	734460M91	S.40403
4 Ring Set (5 rings)		745818M1	S.40417
Top Gasket Set		747166M91	S.40588
Bottom Gasket Set		83400	S.40604
Bottom Gasket Set	>390145DL	747187M91	S.40605
8 Rocker Cover Gasket		731273M1	S.40630
9 Head Gasket		747166M91	S.40619
10 Sump Gasket			

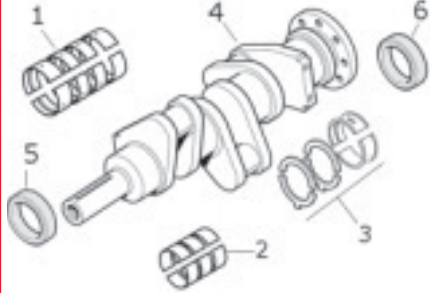

1 Main Bearings (1 set)	Standard	746156M91	S.40331
	0,010"	746157M91	S.40332
	0,020"	746158M91	S.40333
	0,030"	746159M91	S.40334
2 Conrod Bearings (1 set)	Standard	737070M91	S.40315
	0,010"	737071M91	S.40316
	0,020"	737072M91	S.40317
3 Thrust Washers (1 set)	0,030"	737073M91	S.40318
	Standard	735112/13M1	S.40343
4 Crankshaft	0,007"	735800/01M1	S.40344
		3647454M91	S.40309
		731192M1	S.40347
		731008M1	S.40364
5 Front Oil Seal	Viton	1447689M1	S.40352
6 Rear Oil Seal	Black Viton	1447691M1	S.40356
	Rope	735866M1	S.40354



1 Conrod	3637392M91	S.40358
2 Small End Bush	740407M1	S.40360
3 Conrod Bolt and Nut	375756X1	S.40362
4 Conrod Nut	377185X1	S.41328

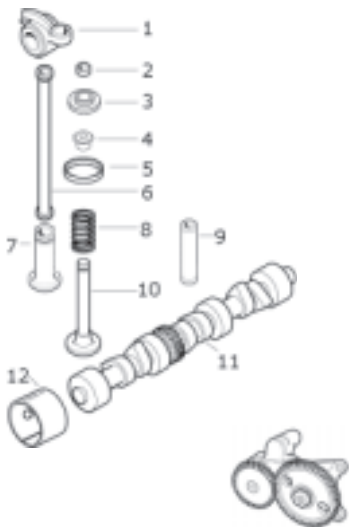

1 Rocker Arm (LH)		
Rocker Arm (RH)		
2 Collet	731155M1	S.41412
3 Bottom Retainer		
4 Valve Stem Seal		
5 Valve Insert / Seal		Entfällt
7 Tappet/Cam Follow er	731150M1	S.41345
8 Inner Valve Spring	731153M1	S.40500
Outer Valve Spring	731154M1	S.40505
9 Valve Guide	732445M1	S.40495
10 Inlet Valve	731151M1	S.40475
Exhaust Valve	731152M1	S.40485
11 Camshaft	733507M1	S.41507
12 Camshaft Bush		
13 Oil Pump	736513M91	S.5934

Perkins Cyl.	Bore	Height	Pin	Height	Rings	Additional Information
AD3.152	3	91,49	215,77	31,75	109,37 109,25	5 See page 179 for Piston dimensions

Models: 135, 148, 152, 154, 230, 233, 234, 235, 240, 245, 250, 253, 254, 255, 340, 342, 350, 353, 354, 550, 263

Case IH

David Brown

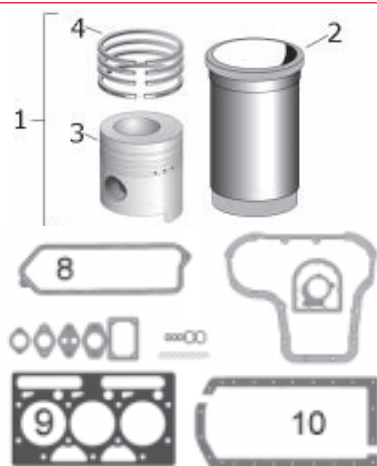

Description	Remarks	Replaces	Sparex
1 Piston and Liner Set (per Cyl.)			S.40454
2 Liner	>152UA275875D	739043M1	S.40432
3 Piston	Cast Liner	743824M91	S.40405
4 Ring Set (5 rings)		745661M1	S.41323
1 Piston and Liner Set (per Cyl.)		3688883M91	S.40447
2 Liner	152UA275875D>	739043M1	S.40432
3 Piston	Cast Liner	3638405M91	S.40406
4 Ring Set (5 rings)		745826M91	S.40419
Top Gasket Set		748008M91	S.40589
Bottom Gasket Set	>390144DL	747187M91	S.40605
Bottom Gasket Set	390145DL>	747186M91	S.40606
8 Rocker Cover Gasket		735057M1	S.40631
9 Head Gasket		747063M1	S.40620
10 Sump Gasket (Rope)	>390144DL	53587	S.41949
Sump Gasket (Seal)	390145DL<		S.41950

Deutz

Fendt

Fiatagri

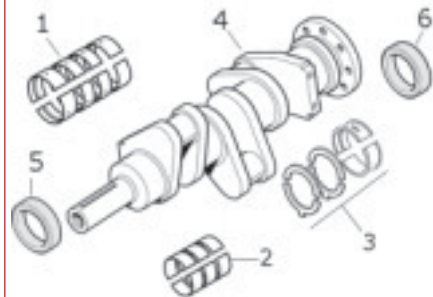

1 Main Bearings (1 set)	Standard	746156M91	S.40331
	0,010"	746157M91	S.40332
	0,020"	746158M91	S.40333
	0,030"	746159M91	S.40334
2 Conrod Bearings (1 set)	Standard	737070M91	S.40315
	0,010"	737071M91	S.40316
	0,020"	737072M91	S.40317
3 Thrust Washers (1 set)	0,030"	737073M91	S.40318
	Standard	735112/13M1	S.40343
4 Crankshaft	0,007"	735800/01M1	S.40344
4 Crankshaft (Rope Seals)		3637410M91	S.40313
Lock Tab		3637454M91	S.40309
Ring Gear		731192M1	S.40347
5 Front Oil Seal	Viton	731008M1	S.40364
6 Rear Oil Seal	Viton	1447689M1	S.40352
Rear Oil Seal	Black Viton	1447691M1	S.40356
Rear Oil Seal	Rope	735866M1M1	S.40354

Ford

John Deere



1 Conrod		3637392M91	S.40358
2 Small End Bush		740407M1	S.40360
3 Conrod Bolt and Nut		375756X1	S.40362
4 Conrod Nut		377185X1	S.41328

M F

Renault

Zetor

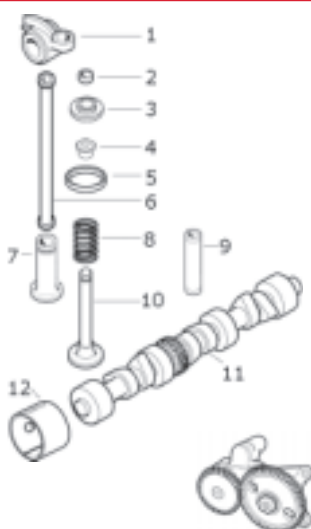

1 Rocker Arm (LH)				
1 Rocker Arm (RH)				
2 Collet		731155M1	S.41412	
3 Valve Retainer				
4 Valve Stem Seal				
5 Valve Insert / Seal			Entfällt	
7 Tappet/Cam Follow er		731150M1	S.41345	
8 Inner Valve Spring		731153M1	S.40500	
Outer Valve Spring		731154M1	S.40505	
9 Valve Guide		732445M1	S.40495	
10 Inlet Valve 45°	>U584638F	732811M1	S.40476	
	U584639F>	739060M1	S.40477	
	Inlet Valve 35°	>U584638F	737640M1	S.40486
	Exhaust Valve 35°	U584639F>	747581M1	S.40487
11 Camshaft		733507M1	S.41507	
12 Camshaft Bush			Entfällt	
13 Oil Pump		736513M91	S.5934	

Standard 85	Cyl.	Bore	Height	Pin	Height	Rings	Additional Information
	4	84,78	171,5	22,1	87,8	5	Petrol

Models: TEA20, TED20

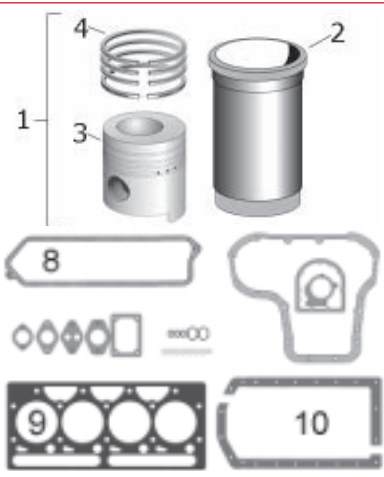

Description	Remarks	Replaces	Sparex
1 Piston and Liner Set (per Cyl.)			S.42275
2 Liner		893007M1	S.42628
3 Piston			S.75972
4 Ring Set (5 rings)			S.41614
Top Gasket Set		501923	S.42085
Bottom Gasket Set		894915M1	S.42631
8 Rocker Cover Gasket		829029M1	S.42393
9 Head Gasket		202084	S.42253
10 Sump Gasket		825654M1	S.41726

Case IH

David Brown

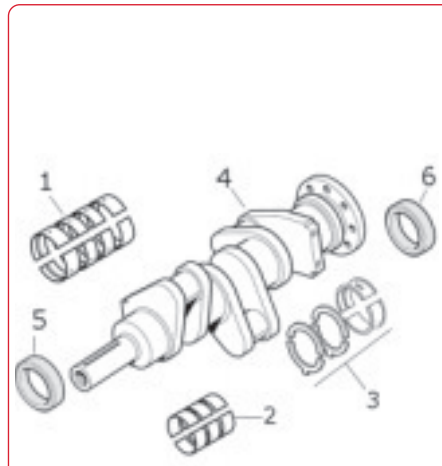

1 Main Bearings (1 set)	Standard	554320M91	S.42362
	0,010"	554322M91	S.42363
	0,020"	554323M91	S.42364
	0,030"	554324M91	S.42426
2 Conrod Bearings (1 set)	Standard	554314M91	S.42359
	0,010"	554316M91	S.42360
	0,020"	554317M91	S.42361
	0,030"	554318M91	S.42425
3 Thrust Washers (1 set)	Standard	825111M91	S.42365
4 Crankshaft		825216M1	S.42688
	Lock Tab	825179M1	S.42689
	Ring Gear	825452M1	S.42422
	Lock Plate	825140M1	S.42420
	5 Front Oil Seal	825740M1	S.42195
	6 Rear Oil Seal	825208M1	S.41725
	Timing Chain	825199M1	S.60909

Deutz

Fendt

Fiatagri



1 Conrod
2 Small End Bush
3 Conrod Bolt and Nut
4 Conrod Nut

Ford

John Deere

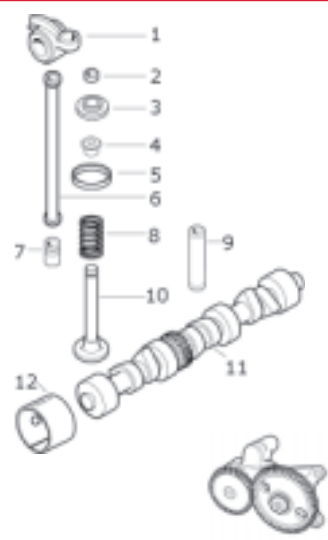

1 Rocker Arm (LH)		
1 Rocker Arm (RH)		
2 Collet		
3 Valve Retainer		
4 Valve Stem Seal		
5 Valve Insert / Seal		
6 Push Rod		
8 Inner Valve Spring		
Outer Valve Spring	825186M1	S.61906
9 Valve Guide	825259M1	S.60193
10 Inlet Valve	825388M1	S.61902
Exhaust Valve	825369M1	S.61904
11 Camshaft		
12 Camshaft Bush		
13 Oil Pump		

M F

Renault

Zetor

Perkins	Cyl.	Bore	Height	Pin	Height	Rings	Additional Information
Standard 87	4	86,62	171,5	22,1	87,4	4	Petrol

Models: 35, 135

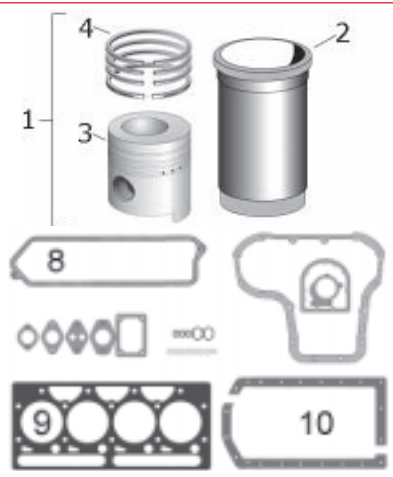

Description	Remarks	Replaces	Sparex
1 Piston and Liner Set (per Cyl.)			S.42276
2 Liner Seal		825864M1	S.42488
3 Piston			
4 Ring Set (4 rings)			S.41615
Top Gasket Set		827560M1	S.42485
Bottom Gasket Set		894915M91	S.42631
8 Rocker Cover Gasket			
9 Head Gasket			
10 Sump Gasket		825654M1	S.41726

Case IH

David Brown

Deutz

Fendt

Fiatagri

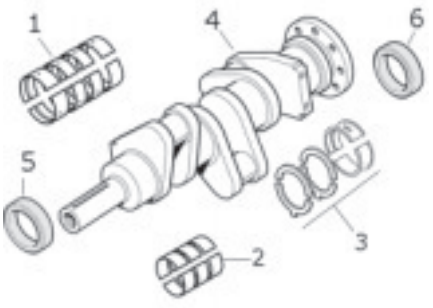

1 Main Bearings (1 set)	Standard	825840M91	S.42362
	0.010"	825837M91	S.42363
	0.020"	825982M91	S.42364
	0.030"	825983M91	S.42426
2 Conrod Bearings (1 set)	Standard	1810083M91	S.42359
	0.010"	1810084M91	S.42360
	0.020"	1810085M91	S.42361
	0.030"	1810086M91	S.42425
3 Thrust Washers (1 set)	Standard		
	0.007"		
4 Crankshaft		825216M1	S.42688
Lock Tab		825179M1	S.42689
Ring Gear		825452M1	S.42422
Lock Plate		825140M1	S.42420
5 Front Oil Seal		825740M1	S.42195
6 Rear Oil Seal		825208M1	S.41725
Timing Chain		825199M1	S.60909

Ford

John Deere



1 Conrod			
2 Small End Bush			
3 Conrod Bolt and Nut			
4 Conrod Nut			

M F

Renault

Zetor

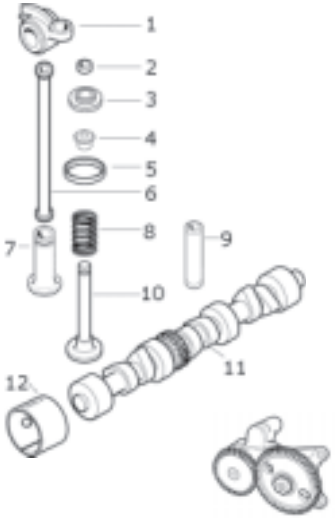

Rocker Arm (LH)			
1 Rocker Arm (RH)			
2 Collet			
3 Valve Retainer			
4 Valve Stem Seal			
5 Valve Insert / Seal			
6 Push Rod			
8 Inner Valve Spring		825186M1	S.61906
Outer Valve Spring		825186M1	S.61906
9 Inlet Valve Guide		825259M1	S.60193
Exhaust Valve Guide		826162M1	S.60194
10 Inlet Valve			
Exhaust Valve			
11 Camshaft			
12 Camshaft Bush			
13 Oil Pump			



Description	Remarks	Replaces	Sparex
1 Piston and Liner Set (per Cyl.)			S.42274
2 Liner			S.42626
3 Piston			S.75973
4 Ring Set (6 rings)		894900M91	S.42136
Top Gasket Set		106387	S.40586
Bottom Gasket Set		894916M91	S.40602
8 Rocker Cover Gasket		829029M1	S.40628
9 Head Gasket		61153	S.40617
10 Sump Gasket			

Case IH

David Brown

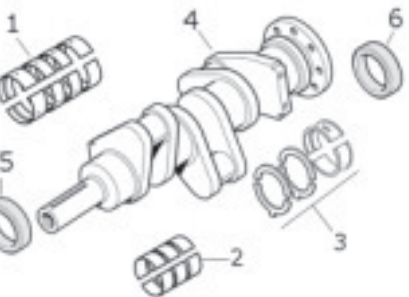

1 Main Bearings (1 set)	Standard	830897M91	S.42367
	0,010"	830898M91	S.42368
	0,020"	894944M91	S.42369
	0,030"	894945M91	S.42370
2 Conrod Bearings (1 set)	Standard	830899M91	S.42366
	0,010"	830900M91	S.42499
	0,020"	830901M91	S.42500
3 Thrust Washers (1 set)	Standard	826239/40M1	S.42427
	0,007"		
4 Crankshaft			
Lock Tab			
Ring Gear			
5 Front Oil Seal		825740M1	S.42195
6 Rear Oil Seal		1884098M1	S.42233
Timing Chain	1951-56	61471	S.41616

Deutz

Fendt

Fiataagri



1 Conrod			
2 Small End Bush			
3 Conrod Bolt and Nut			
4 Conrod Nut			

Ford

John Deere

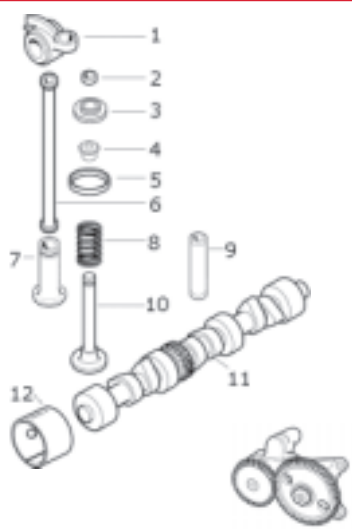

1 Rocker Arm (LH)			
1 Rocker Arm (RH)			
2 Collet			
3 Valve Retainer			
4 Valve Stem Seal			
5 Valve Insert / Seal			
6 Push Rod			
7 Tappet/Cam Follow er			
8 Inner Valve Spring	103369		S.40498
8 Outer Valve Spring	103368		S.40503
9 Valve Guide			
10 Inlet Valve	101661		S.40473
10 Exhaust Valve	110926		S.40483
11 Camshaft			
12 Camshaft Bush			
13 Oil Pump			

Renault

Zetor

Perkins	Cyl.	Bore	Height	Pin	Height	Rings	Additional Information
Standard 23C	4	84,17	187,96	28,1	98,26	5	Petrol

Models: FE35

Case IH

David Brown

Deutz

Fendt

Fiatagri

Ford

John Deere

M F

Renault

Zetor

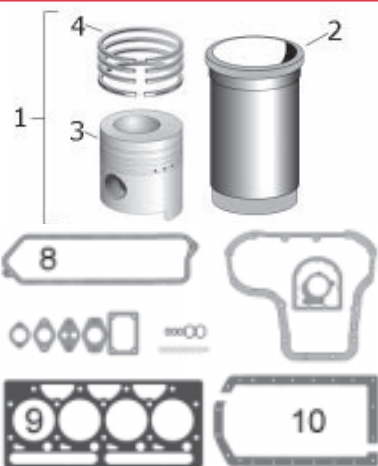

Description	Remarks	Replaces	Sparex
1 Piston and Liner Set (per Cyl.)		890972M92	S.41943
2 Liner			
3 Piston			
4 Ring Set (5 rings)		894900M91	S.42135
Top Gasket Set		1810028M91	S.40587
Bottom Gasket Set		1810027M91	S.40603
8 Rocker Cover Gasket		828695M1	S.40629
9 Head Gasket		1882771M1	S.40618
10			

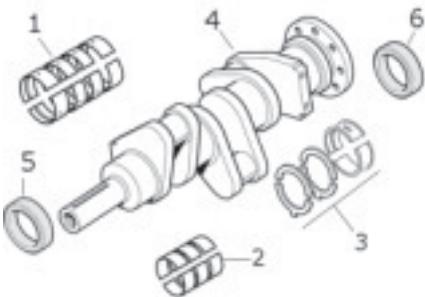

1 Main Bearings (1 set)	Standard	830897M91	S.42367
	0,010"	830898M91	S.42368
	0,020"	894944M91	S.42369
	0,030"	894945M91	S.42370
2 Conrod Bearings (1 set)	Standard	830899M91	S.42366
	0,010"	830900M91	S.42499
	0,020"	830901M91	S.42500
3 Thrust Washers (1 set)	0,030"	894947M91	S.42501
	Standard	826239/40M1	S.42427
4 Crankshaft			
Lock Tab			
Ring Gear			
5 Front Oil Seal		825740M1	S.42195
6 Rear Oil Seal		1884098M1	S.42233
Timing Chain		826094M1	S.60941



1 Conrod			
2 Small End Bush			
3 Conrod Bolt and Nut			
4 Conrod Nut			

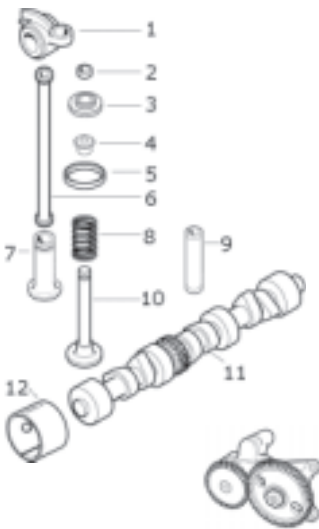

1 Rocker Arm (LH)			
Rocker Arm (RH)			
2 Collet			
3 Valve Retainer			
4 Valve Stem Seal			
5 Valve Insert / Seal			
6 Push Rod			
8 Inner Valve Spring		1884126M1	S.40499
Outer Valve Spring		1884125M1	S.40504
9 Inlet/Exhaust Valve Guide		825259M1	S.60193
Exhaust Valve Guide		826162M1	S.60194
10 Inlet Valve		18841234M1	S.40474
Exhaust Valve		1884124M1	S.40484
11 Camshaft			
12 Camshaft Bush			
13 Oil Pump			



Description	Remarks	Replaces	Sparex
1 Piston and Liner Set (per Cyl.)		Order Components	
2 Liner		734127M1	S.42450
3 Piston		741335M91	S.43082
4 Ring Set (5 rings)		745902M91	S.40425
Top Gasket Set		4222808M91	S.42315
Bottom Gasket Set		4223920M91	S.43083
8 Rocker Cover Gasket			
9 Head Gasket			
10 Sump Gasket			

Case IH

David Brown

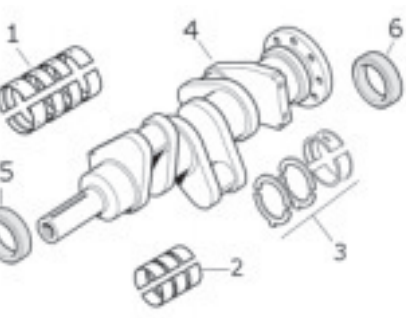

1 Main Bearings (1 set)	Standard		
	0.010"		
	0.020"		
	0.030"		
2 Conrod Bearings (1 set)	Standard		
	0.010"		
	0.020"		
	0.030"		
3 Thrust Washers (1 set)	Standard		
	0.007"		
4 Crankshaft			
Lock Tab			
Ring Gear			
5 Front Oil Seal		732043M1	S.30049
6 Rear Oil Seal	Black Viton		
6 Rear Oil Seal	Rope	4224055M1	S.43097

Deutz

Fendt

Fiataagri

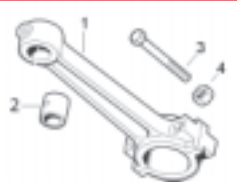

1 Conrod			
2 Small End Bush			
3 Conrod Bolt and Nut			
4 Conrod Nut			

Ford

John Deere

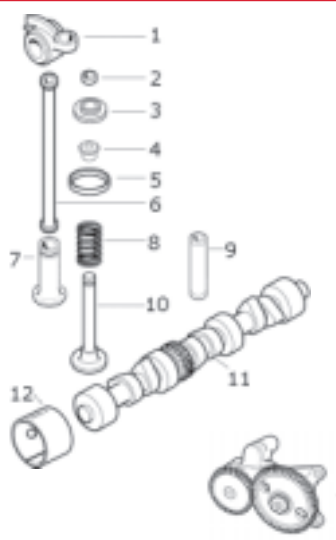

1 Rocker Arm (LH) Rocker Arm (RH)			
2 Collet		731155M1	S.41412
3 Valve Retainer			
4 Valve Stem Seal			
5 Valve Insert / Seal			
6 Push Rod			
7 Tappet/Cam Follow er			
8 Inner Valve Spring Outer Valve Spring			
9 Valve Guide			
10 Inlet Valve Exhaust Valve			
11 Camshaft			
12 Camshaft Bush			
13 Oil Pump			

M F

Renault

Zetor

Perkins	Cyl.	Bore	Height	Pin	Height	Rings	Additional information
A4.192	4	88,23	215,9	31,75	108,09	5	

Models: 65, 765



Description	Remarks	Replaces	Sparex
1 Piston and Liner Set (per Cyl.)			S.40446
2 Liner			S.40433
3 Piston		739845M91	S.40404
4 Ring Set (5 rings)		745823M91	S.40418
Top Gasket Set		735726M91	S.40590
Bottom Gasket Set		743029M91	S.40607
8 Rocker Cover Gasket		735057M1	S.40632
9 Head Gasket		490689	S.40621
10 Sump Gasket		4223524M91	S.41949

Case IH

David Brown

Deutz

Fendt

Fiatagri

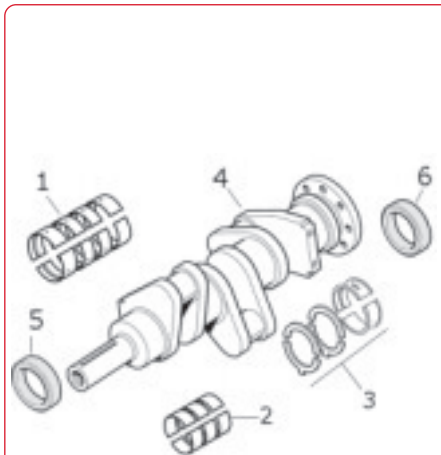

1 Main Bearings (1 set)	Standard	745405M91	S.40335
	0.010"	745406M91	S.40336
	0.020"	745407M91	S.40337
	0.030"	745408M91	S.40338
2 Conrod Bearings (1 set)	Standard	737066M91	S.40319
	0.010"	737067M91	S.40320
	0.020"	737068M91	S.40321
	0.030"	737069M91	S.40322
3 Thrust Washers (1 set)	Standard	735112/13M1	S.40343
	0.007"	735800/01M1	S.40344
4 Crankshaft		3647454M91	S.40310
	Lock Tab	731192M1	S.40347
	Ring Gear	731008M1	S.40364
5 Front Oil Seal		1447689M1	S.40352
	Rear Oil Seal		
6 Rear Oil Seal	Rope	735866M1M1	S.40354

Ford

John Deere

M F

Renault

Zetor



1 Conrod		3637439M91	S.40357
2 Small End Bush		740407M1	S.40360
3 Conrod Bolt and Nut		375756X1	S.40362
4 Conrod Nut		377185X1	S.41328

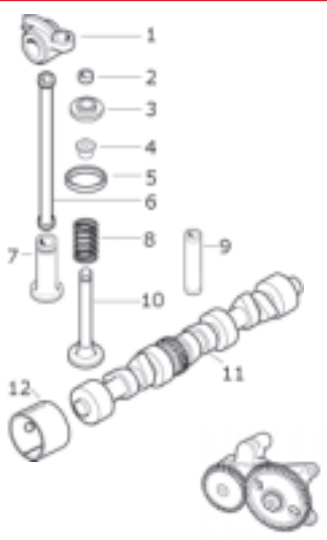

1	Rocker Arm (LH)		
	Rocker Arm (RH)		
2	Collet	731155M1	S.41412
3	Valve Retainer		
4	Valve Stem Seal		
5	Valve Insert / Seal		
6	Push Rod		
7	Tappet/Cam Follow er	731150M1	S.41345
8	Inner Valve Spring	731153M1	S.40500
	Outer Valve Spring	731154M1	S.40505
9	Valve Guide	732445M1	S.40495
10	Inlet Valve	731151M1	S.40475
	Exhaust Valve	731152M1	S.40485
11	Camshaft		
12	Camshaft Bush		
13	Oil Pump	1447483M91	S.5935



Description	Remarks	Replaces	Sparex
1 Piston and Liner Set (per Cyl.)			S.40444
2 Liner	>1935853	732638M1	S.40431
3 Piston	Chrome Liner	734460M91	S.40403
4 Ring Set (5 rings)		745819M1	S.40416
1 Piston and Liner Set (per Cyl.)		3640482M91	S.40445
2 Liner	1935853>	739043M1	S.40432
3 Piston	Cast Liner	734460M91	S.40403
4 Ring Set (5 rings)		745818M1	S.40417
Top Gasket Set		746051M91	S.40591
Bottom Gasket Set		743029M91	S.40607
8 Rocker Cover Gasket		735057M1	S.40632
9 Head Gasket		731011M2	S.40622
10 Sump Gasket	>390144DL		
Sump Gasket	390145DL>		

Case IH

David Brown

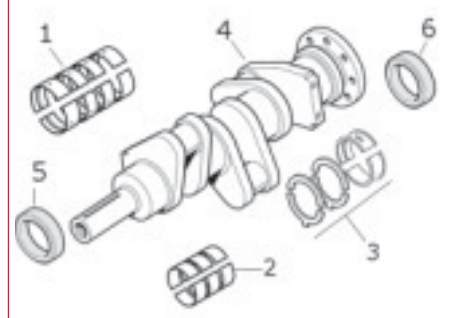

1 Main Bearings (1 set)	Standard	745405M91	S.40335
	0,010"	745406M91	S.40336
	0,020"	745407M91	S.40337
	0,030"	745408M91	S.40338
2 Conrod Bearings (1 set)	Standard	737066M91	S.40319
	0,010"	737067M91	S.40320
	0,020"	737068M91	S.40321
	0,030"	737069M91	S.40322
3 Thrust Washers (1 set)	Standard	735112/13M1	S.40343
	0,007"	735800/01M1	S.40344
4 Crankshaft (Rope Seals)		3647454M91	S.40310
	Lock Tab	731192M1	S.40347
	Ring Gear	731008M1	S.40364
5 Front Oil Seal		1447689M1	S.40352
6 Rear Oil Seal	Black Viton		
	Rope	735866M1M1	S.40354

Deutz

Fendt

Fiatagri

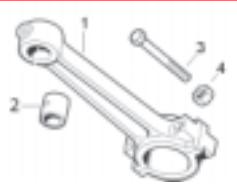

1 Conrod		3637392M91	S.40358
2 Small End Bush		740407M1	S.40360
3 Conrod Bolt and Nut		375756X1	S.40362
4 Conrod Nut		377185X1	S.41328

Ford

John Deere

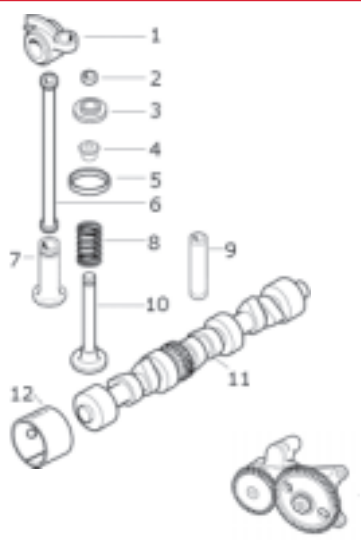

1 Rocker Arm (LH) Rocker Arm (RH)			
2 Collet		731155M1	S.41412
3 Valve Retainer			
4 Valve Stem Seal			
5 Valve Insert / Seal			
6 Push Rod			
7 Tappet/Cam Follow er		731150M1	S.41345
8 Inner Valve Spring Outer Valve Spring		731153M1	S.40500
		731154M1	S.40505
9 Valve Guide		732445M1	S.40495
10 Inlet Valve Exhaust Valve		731151M1 731152M1	S.40475 S.40485
11 Camshaft			
12 Camshaft Bush			
13 Oil Pump		1447483M91	S.5935

M F

Renault

Zetor

Models: 65, 155, 158, 165, 260, 765

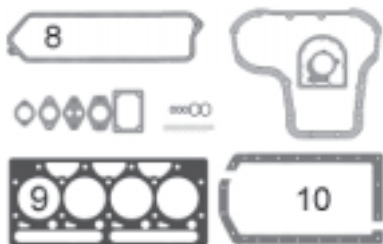

Description	Remarks	Replaces	Sparex
1 Piston and Liner Set (per Cyl.)			S.40443
2 Chrome Liner	>2939036	732638M1	S.40431
3 Piston		743824M91	S.40405
4 Ring Set (5 rings)		745819M91	S.40416
1 Piston and Liner Set (per Cyl.)		3637765M91	S.40454
2 Cast Liner	2939037>	739043M1	S.40432
3 Piston	>U589378L	743824M91	S.40405
4 Ring Set (5 rings)		745818M91	S.40417
1 Piston and Liner Set (per Cyl.)		3688883M91	S.40447
2 Cast Liner	U589378L>	739043M1	S.40432
3 Piston		3638405M91	S.40406
4 Ring Set (4 rings)		745826M91	S.40419
Top Gasket Set		735349M91	S.40592
Bottom Gasket Set	>29C1083	735350M91	S.40608
Bottom Gasket Set	29C1084>	745987M91	S.40609
8 Rocker Cover Gasket		73281M1	S.40633
9 Head Gasket		744391M1	S.40623
10 Sump Gasket			

Case IH

David Brown

Deutz

Fendt

Fiatagri

Ford

John Deere

M F

Renault

Zetor

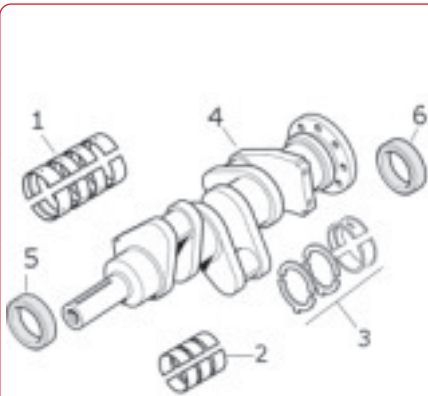

1 Main Bearings (1 set)	Standard	745405M91	S.40335
	0,010"	745406M91	S.40336
	0,020"	745407M91	S.40337
	0,030"	745408M91	S.40338
2 Conrod Bearings (1 set)	Standard	737066M91	S.40319
	0,010"	737067M91	S.40320
	0,020"	737068M91	S.40321
	0,030"	737069M91	S.40322
3 Thrust Washers (1 set)	Standard	735112/13M1	S.40343
	0,007"	735800/01M1	S.40344
4 Crankshaft	Rope Seal	747742M91	S.40310
	Lip Seal	742344M91	S.40312
		731192M1	S.40347
		731008M1	S.40364
5 Front Oil Seal		1447689M1	S.40352
6 Rear Oil Seal	Rope	735866M1	S.40354
	Black Viton	1447691M1	S.40356

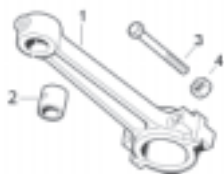

1 Conrod		3637392M91	S.40358
2 Small End Bush		740407M1	S.40360
3 Conrod Bolt and Nut		375756X1	S.40362
4 Conrod Nut		377185X1	S.41328

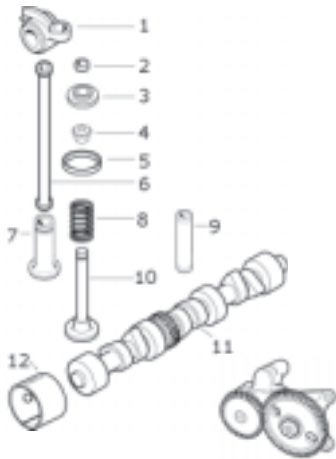

1 Rocker Arm (LH)			
1 Rocker Arm (RH)			
2 Collet		731155M1	S.41412
6 Push Rod			
7 Tappet/Cam Follow er		731150M1	S.41345
8 Inner Valve Spring		731153M1	S.40500
8 Outer Valve Spring		731154M1	S.40505
9 Inlet Valve Guide		732445M1	S.40495
9 Exhaust Valve Guide			
Inlet Valve	45°	732811M1	S.40476
	35°	739060M1	S.40477
10 Exhaust Valve	45°	737640M1	S.40486
	35°	747581M1	S.40487
13 Oil Pump		1447483M91	S.5935

Perkins Cyl.	Bore	Height	Pin	Height	Rings
4	98,46	227,57	34,93	116,13 127,28	3 4

Additional information
See page 179 for Piston dimensions

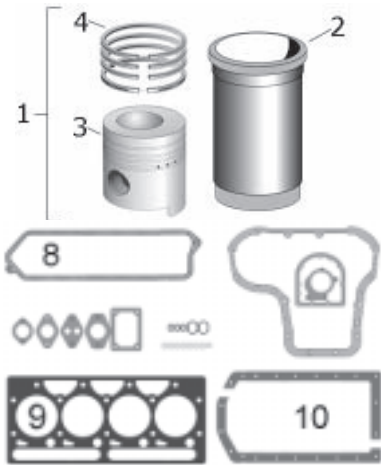

Description	Remarks	Replaces	Sparex
1 Piston and Liner Set (per Cyl.)			S.40453
2 Liner (226,22mm Height)	>UA187116L	744948M1	S.40434
3 Piston (116,13mm)		740082M91	S.40408
4 Ring Set (3 rings)		745764M91	S.40421
1 Piston and Liner Set (per Cyl.)			S.40448
2 Liner (226,22mm Height)	UA187116L>	744948M1	S.40434
3 Piston (127,28mm)		738249M91	S.40407
4 Ring Set (4 rings)		745763M91	S.40420
Top Gasket Set			3637444M91
Top Gasket Set	U106655N>	3637363M91	S.41954
Bottom Gasket Set		747191M91	S.40610
8 Rocker Cover Gasket		746714M1	S.40634
9 Head Gasket	>U106654N	746342M1	S.40624
Head Gasket	U106655N>	3637341M1	S.41951
10 Sump Gasket			

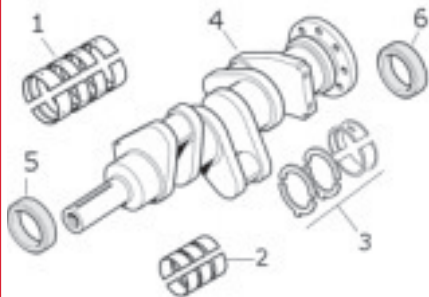

1 Main Bearings (1 set)	Standard	735168M91	S.40339
	0,010"	735169M91	S.40340
	0,020"	735170M91	S.40341
	0,030"	735171M91	S.40342
2 Conrod Bearings (1 set)	Standard	736950M91	S.40323
	0,010"	736951M91	S.40324
	0,020"	736952M91	S.40325
3 Thrust Washers (1 set)	Standard	747128/29M1	S.40345
	0,007"	735742/43M1	S.40346
4 Crankshaft			
Lock Tab		731192M1	S.40347
Ring Gear		731008M1	S.40364
5 Front Oil Seal		1447690M1	S.40351
6 Rear Oil Seal	Rope	735942M1	S.40355
Rear Oil Seal	Black Viton	1447691M1	S.40356



1 Conrod	3637034M91	S.40359
2 Small End Bush	733767M1	S.40361
3 Conrod Bolt and Nut		S.40363
4 Conrod Nut		S.41329

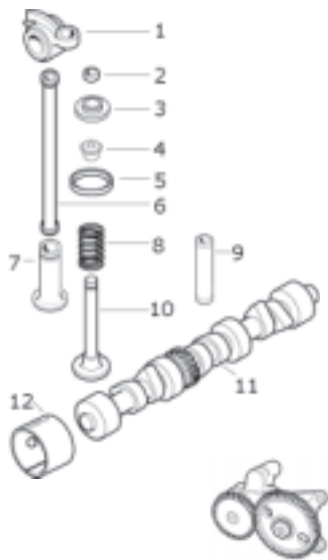

1 Rocker Arm (LH)	3637072M91	S.41920	
Rocker Arm (RH)	3637071M91	S.41919	
2 Collet	736453M1	S.41413	
3 Valve Retainer			
4 Valve Stem Seal			
5 Valve Insert / Seal	3637041M1	S.41325	
6 Push Rod	733817M	S.30019	
7 Tappet/Cam Follow er	740671M1	S.41918	
Inner Valve Spring (2mm)	733822M1	S.40501	
8 Inner Valve Spring (2,5mm)	735525M1	S.40502	
Outer Valve Spring	735521M1	S.40507	
9 Inlet Valve Guide	3637056M1	S.40496	
Exhaust Valve Guide	748420M1	S.41539	
10 Inlet Valve	Standard	739027M1	S.40478
Exhaust Valve	Standard	747552M1	S.40488
11 Camshaft	>U08336N	736818M1	S.41523
Camshaft	U08337N>	3637537M1	S.41524
12 Camshaft Bush		3638579M1	S.41399
13 Oil Pump	735118M91	S.5936	

Massey Ferguson

Perkins Cyl.	Bore	Height	Pin Height	Rings	Additional Information
A4.236	4	98,46	226,22 226,52	34,93	120,65 121,10
					5

Models: 50, 168, 174-4S, 175, 178, 184-4S, 240, 265, 273, 274, 274S, 275, 283, 284-4S, 362, 362N, 365, 372, 373, 374, 375, 377, 383, 384S, 387, 565, 575, 675, 3050



Description	Remarks	Replaces	Sparex
1 Piston and Liner Set (per Cyl.)	>109214L		S.40449
2 Liner	Piston Height	744948M1	S.40434
3 Piston	120,65 mm	735187M91	S.40409
4 Ring Set (5 rings)		745747M91	S.40422
1 Piston and Liner Set (per Cyl.)	109215L>		S.40450
2 Liner	>U08336N	744948M1	S.40434
3 Piston	Piston Height	3637516M91	S.40410
4 Ring Set (5 rings)	121,10 mm	745760M91	S.40423
1 Piston and Liner Set (per Cyl.)	U08337N>	U5MK0065	S.41939
2 Liner	Piston Height	3637032M91	S.41373
3 Piston	121,10 mm	3637516M91	S.40410
4 Ring Set (5 rings)		745760M91	S.40423

Case IH

David Brown

Deutz

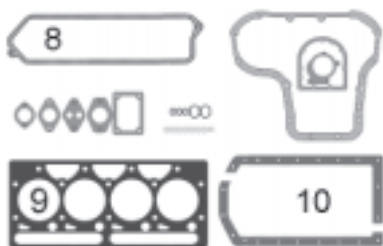

Top Gasket Set	>U106654N		S.40594
Bottom Gasket Set		747191M91	S.40610
8 Rocker Cover Gasket		746714M1	S.40634
9 Head Gasket	>U106654N	746342M1	S.40624
Head Gasket	U106655N>	3637341M1	S.41951
10 Sump Gasket			

Fendt

Fiatagri

Ford

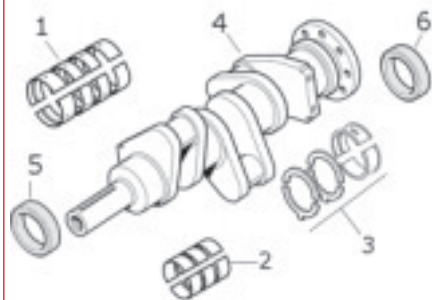

1 Main Bearings (1 set)	Standard	735168M91	S.40339
	0,010"	735169M91	S.40340
	0,020"	735170M91	S.40341
	0,030"	735171M91	S.40342
2 Conrod Bearings (1 set)	Standard	736950M91	S.40323
	0,010"	736951M91	S.40324
	0,020"	736952M91	S.40325
	0,030"	736953M91	S.40326
3 Thrust Washers (1 set)	Standard	747128/29M1	S.40345
	0,007"	735742/43M1	S.40346
4 Crankshaft	Rope Seal	736829M91	S.40311
	Rope Seal	3637789M91	S.41641
	Oil Seal	736829M91	S.40314
	Oil Seal	3637401M91	S.41639
Lock Tab		731192M1	S.40347
Ring Gear		731008M1	S.40364
5 Front Oil Seal		1447690M1	S.40351
6 Rear Oil Seal	Rope	735942M1	S.40355
	Black Viton	1447691M1	S.40356

John Deere

M F

Renault

Zetor

Perkins A4.236 continued



	Description	Remarks	Replaces	Sparex
1	Conrod		3637034M91	S.40359
2	Small End Bush		733767M1	S.40361
3	Conrod Bolt and Nut			S.40363
4	Conrod Nut			S.41329

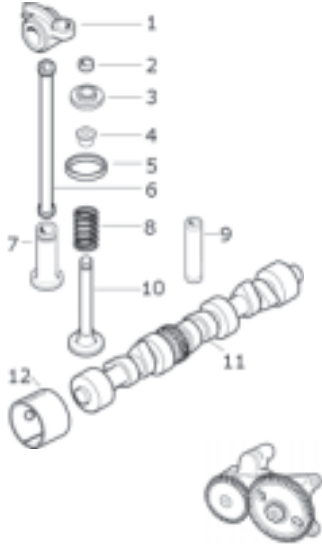

1	Rocker Arm (LH)		3637072M91	S.41920
	Rocker Arm (RH)		3637071M91	S.41919
2	Collet		736453M1	S.41413
5	Valve Insert / Seal		3637041M1	S.41325
6	Push Rod		31434307	S.30019
7	Tappet/Cam Follow er		740671M1	S.41918
8	Inner Valve Spring (2mm)		733822M1	S.40501
	Inner Valve Spring (2,5mm)		735525M1	S.40502
	Outer Valve Spring		735521M1	S.40507
9	Inlet Valve Guide		3637056M1	S.40496
	Exhaust Valve Guide		748420M1	S.41539
10	Inlet Valve	Standard	739027M1	S.40478
	Exhaust Valve	Standard	747552M1	S.40488
11	Camshaft	>U08336N	736818M1	S.41523
	Camshaft	U08337N>	3637537M1	S.41524
12	Camshaft Bush		3638579M1	S.41399
13	Oil Pump		735118M91	S.5936
	Oil Pump		3637489M91	S.41938

Case IH

David Brown

Deutz

Fendt

S.41938



Fiatagri

Ford

S.40634



S.41939



S.5936



John Deere

M F

S.40624

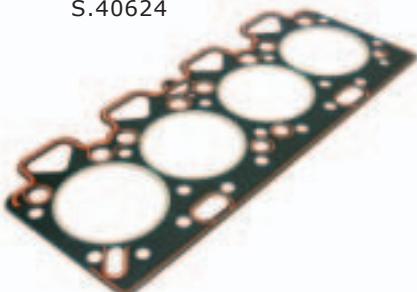

S.40610

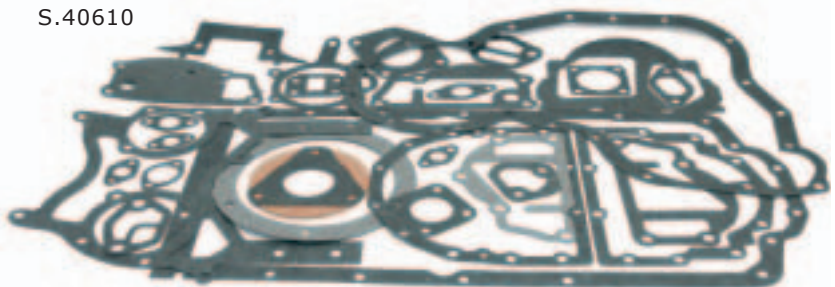

Renault

Zetor

Perkins	Cyl.	Bore	Height	Pin	Height	Rings	Additional information
AT4.236	4	98,46	227,57	38,03	108,25	3	See page 179 for Liner dimensions

Models: 390T, 398, 560, 698T, 1007, 3065, 3070, 3075



	Description	Remarks	Replaces	Sparex
1	Piston and Liner Set (per Cyl.)		Order Components	
2	Liner		744948M1	S.40434
	Liner		3637032M1	S.41373
3	Piston		3637360M91	S.42198
4	Ring Set (5 rings)		747602M91	S.42208

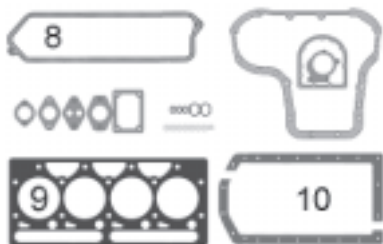

	Top Gasket Set		3637361M91	S.41955
	Bottom Gasket Set		747191M91	S.40610
8	Rocker Cover Gasket		3638482M1	S.42123
9	Head Gasket	>U027774M	3638845M1	S.40624
	Head Gasket	U027774M>	3637498M1	S.41952
10	Sump Gasket			

Case IH

David Brown

Deutz

Fendt

Fiatagri

Ford

John Deere

M F

Renault

Zetor

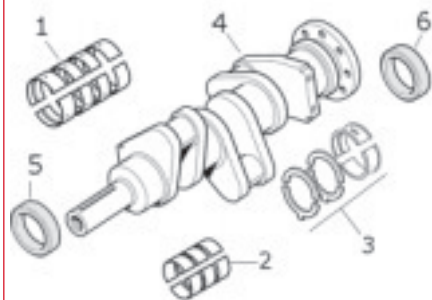

1	Main Bearings (1 set)	Standard	735168M91	S.40339
		0,010"	735169M91	S.40340
		0,020"	735170M91	S.40341
		0,030"	735171M91	S.40342
2	Conrod Bearings (1 set)	Standard	736950M91	S.40323
		0,010"	736951M91	S.40324
		0,020"	736952M91	S.40325
	0,030"	736953M91	S.40326	
3	Thrust Washers (1 set)	Standard	747128/29M1	S.40345
		0,007"	735742/43M1	S.40346
4	Crankshaft			
	Lock Tab		731192M1	S.40347
	Ring Gear		731008M1	S.40364
5	Front Oil Seal		1447690M1	S.40351
6	Rear Oil Seal	Black Viton	1447691M1	S.40356

Perkins AT4.236 continued

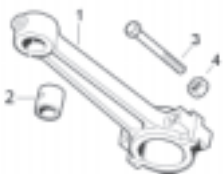

	Description	Remarks	Replaces	Sparex
1	Conrod			
2	Small End Bush		31134131	S.42247
3	Conrod Bolt and Nut			S.40363
4	Conrod Nut			S.41329

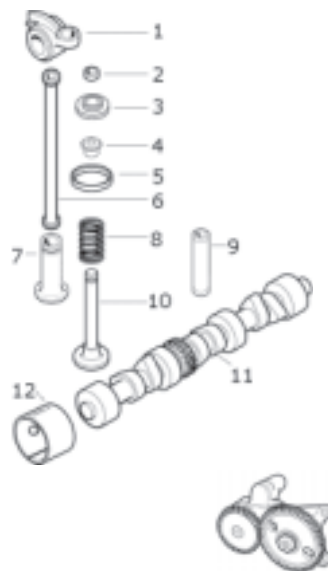

1	Rocker Arm (LH) Rocker Arm (RH)		3637072M91 3637071M91	S.41920 S.41919
2	Collet		746453M1	S.41413
3	Valve Retainer			
4	Valve Stem Seal		3637041M1	S.41325
5	Valve Insert / Seal			
6	Push Rod		733817M1	S.30019
7	Tappet/Cam Follow er		740671M1	S.41918
8	Inner Valve Spring (2mm)		735522M1	S.40501
	Inner Valve Spring (2,5mm)		735525M1	S.40502
	Outer Valve Spring		735521M1	S.40507
9	Exhaust Valve Guide		748420M1	S.41539
10	Inlet Valve			
	Exhaust Valve		747552M1	S.40488
11	Camshaft			
12	Camshaft Bush			S.41399
13	Balancer with Oil Pump		3637353M91	S.40512

S.40624

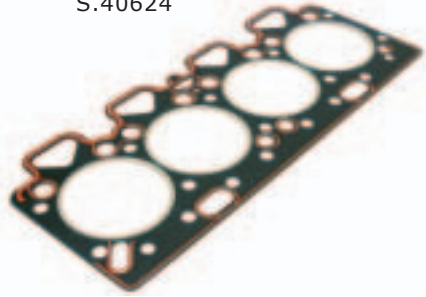

S.40610

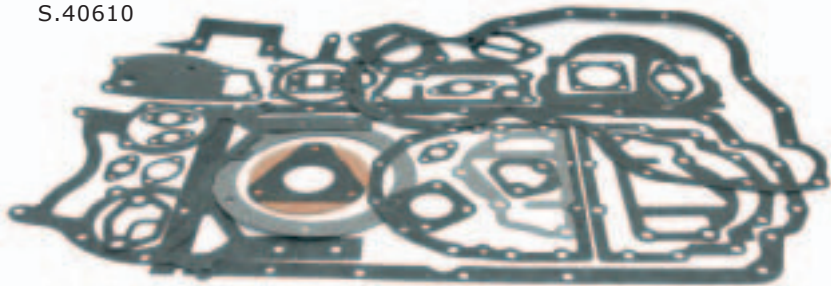

Case IH

David Brown

Deutz

Fendt

Fiatagri

Ford

John Deere

M F

Renault

Zetor

Massey Ferguson

Perkins	Cyl.	Bore	Height	Pin	Height	Rings	Additional information
A4.248	4	100,33	223,6	34,93	120,69 120,72	4 3	See page 179 for Piston dimensions

Models: 50, 60, 185, 178, 188, 194-4F, 285, 290, 293, 294S, 382, 382N, 383, 383S, 387, 390, 393, 394, 397, 440, 590, 690, 3060



Description	Remarks	Replaces	Sparex
1 Piston and Liner Set (per Cyl.)			S.40451
2 Liner (223,90mm Height)	>839079J	737214M1	S.41375
3 Piston (120,69mm)		740821M91	S.40411
4 Ring Set (4 rings)		747041M91	S.40424
1 Piston and Liner Set (per Cyl.)			S.40452
2 Liner (227,28mm Height)	>U08336N	742466M1	S.40437
3 Piston (120,69mm)		740821M91	S.40411
4 Ring Set (4 rings)		747041M91	S.40424
1 Piston and Liner Set (per Cyl.)			S.41595
2 Liner (226,52mm Height)	U08337N>	3637334M1	S.41375
3 Piston (120,72mm)		747050M91	S.41540
4 Ring Set (3 rings)		747428M91	S.41401

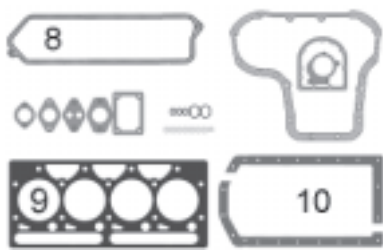

Top Gasket Set	>U106654N	3637363M91	S.40594
Bottom Gasket Set		747191M91	S.40610
Bottom Gasket Set	Industrial	747192M91	S.41617
8 Rocker Cover Gasket		746714M1	S.40634
9 Head Gasket	>U106654N	746342M1	S.40624
9 Head Gasket	U106655N>	3637341M1	S.41951
10 Sump Gasket			

Case IH

David Brown

Deutz

Fendt

Fiatagri

Ford

John Deere

M F

Renault

Zetor

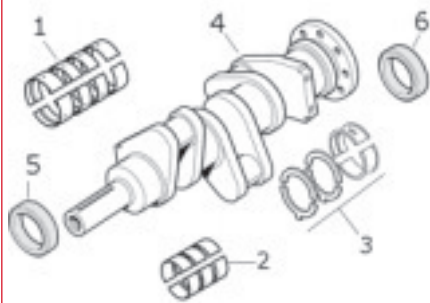

1 Main Bearings (1 set)	Standard	735168M91	S.40339
	0,010"	735169M91	S.40340
	0,020"	735170M91	S.40341
	0,030"	735171M91	S.40342
2 Conrod Bearings (1 set)	Standard	736950M91	S.40323
	0,010"	736951M91	S.40324
	0,020"	736952M91	S.40325
	0,030"	736953M91	S.40326
3 Thrust Washers (1 set)	Standard	747128/29M1	S.40345
	0,007"	735742/43M1	S.40346
4 Crankshaft	Rope Seals	3637789M91	S.41641
	Oil Seals	736829M91	S.40314
		731192M1	S.40347
		731008M1	S.40364
5 Front Oil Seal		1447690M1	S.40351
6 Rear Oil Seal	Rope	735942M1	S.40355
	Black Viton	1447691M1	S.40356

Perkins A4.248 continued

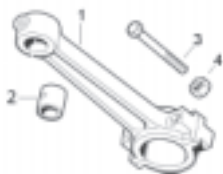

	Description	Remarks	Replaces	Sparex
1	Conrod		3637034M91	S.40359
2	Small End Bush		733767M1	S.40361
3	Conrod Bolt and Nut			S.40363
4	Conrod Nut			S.41329

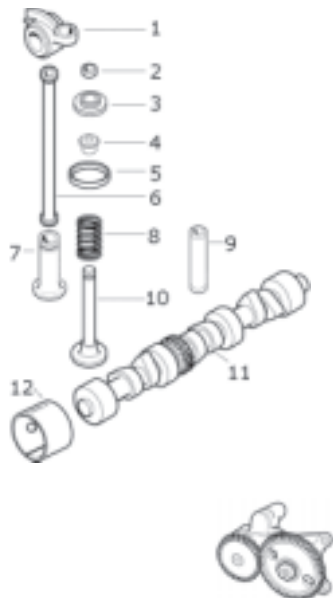

1	Rocker Arm (LH)		3637072M91	S.41920
	Rocker Arm (RH)		3637071M91	S.41919
2	Collet		736453M1	S.41413
3	Valve Retainer			
4	Valve Stem Seal			
5	Valve Insert / Seal		3637041M1	S.41325
6	Push Rod		733817M1	S.30019
7	Tappet/Cam Follow er		740671M1	S.41918
	Inner Valve Spring (2mm)		733822M1	S.40501
8	Inner Valve Spring (2,5mm)		735525M1	S.40502
	Outer Valve Spring		735521M1	S.40507
	Inlet Valve Guide		3637056M1	S.40496
9	Exhaust Valve Guide		748420M1	S.41539
	Inlet Valve	Standard	739027M1	S.40478
	Exhaust Valve	Standard	747552M1	S.40488
	Camshaft	>106654N	736818M1	S.41523
	Camshaft	106655N>	3637537M1	S.41524
12	Camshaft Bush		3638579M1	S.41399
	Oil Pump		735118M91	S.5936
13	Oil Pump for 6 Hole Balancer		3637489M91	S.41938

Case IH

David Brown

Deutz

Fendt

Fiatagri

Ford

John Deere

M F

Renault

Zetor

S.5936



S.41938



S.40634



S.40610

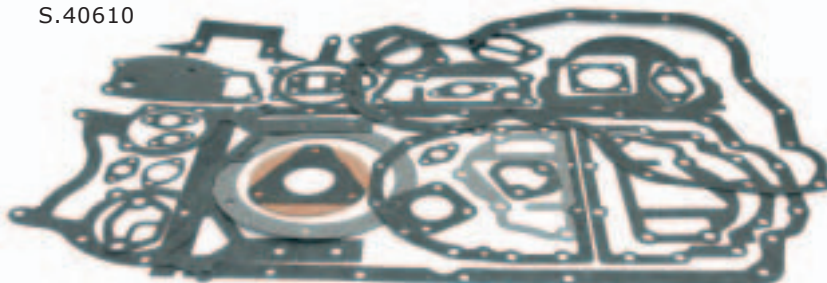

S.40624

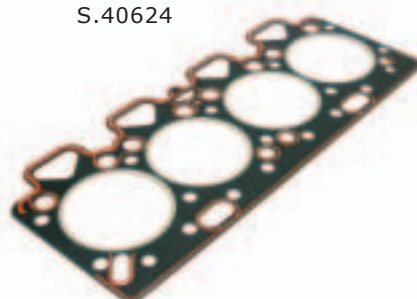

Perkins	Cyl.	Bore	Height	Pin	Height	Rings	Additional information
A4.318	4					4	
Models: 285, 595, 595KM, 1080							



Description	Remarks	Replaces	Sparex
1 Piston and Liner Set (per Cyl.)			
2 Liner			
3 Piston			
4 Ring Set (4 rings)		745950M91	S.40426
Top Gasket Set		746288M91	S.40596
Bottom Gasket Set		743789M91	S.40612
8 Rocker Cover Gasket			
9 Head Gasket			
10 Sump Gasket			

Case IH

David Brown

Deutz

Fendt

Fiatagri

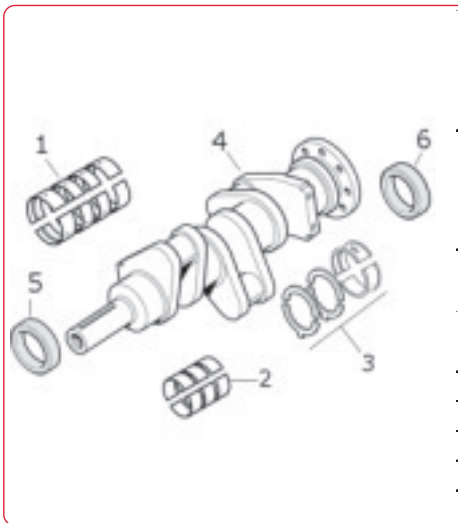

1 Main Bearings (1 set)	Standard		
	0,010"		
	0,020"		
	0,030"		
2 Conrod Bearings (1 set)	Standard		
	0,010"		
	0,020"		
	0,030"		
3 Thrust Washers (1 set)	Standard		
	0,007"		
4 Crankshaft	Rope Seals		
4 Crankshaft	Oil Seals		
Lock Tab		731192M1	S.40347
Ring Gear		731988M1	S.41449
5 Front Oil Seal			
6 Rear Oil Seal	Black Viton	1447691M1	S.40356

Ford



1 Conrod			
2 Small End Bush		733767M1	S.40361
3 Conrod Bolt and Nut			
4 Conrod Nut			

John Deere

M F

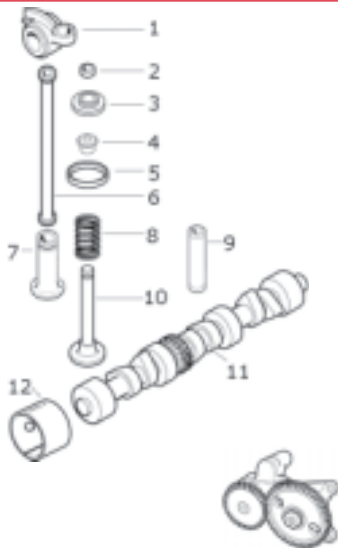

1 Rocker Arm (LH)			
1 Rocker Arm (RH)			
2 Collet		736453M1	S.41413
3 Valve Retainer			
4 Valve Stem Seal			
5 Valve Insert / Seal			
6 Push Rod			
Inner Valve Spring (2mm)		733822M1	S.40501
8 Inner Valve Spring (2,5mm)		735525M1	S.40502
Outer Valve Spring		735521M1	S.40507
9 Valve Guide		738094M1	S.41746
10 Inlet Valve		738095M1	S.41747
10 Exhaust Valve		738944M1	S.41820
11 Camshaft			
12 Camshaft Bush			
13 Oil Pump		737020M91	S.42441

Renault

Zetor

Case IH

David Brown

Deutz

Fendt

Fiataagri

Ford

John Deere

M F

Renault

Zetor

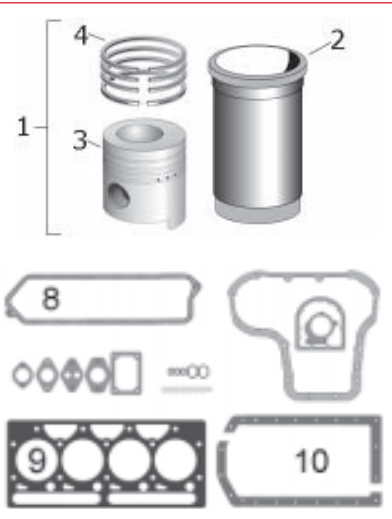

Description	Remarks	Replaces	Sparex
1 Piston and Liner Set (per Cyl.)			S.30039
2 Liner		748216M1	S.42431
3 Piston		363898M91	S.42937
4 Ring Set (5 rings)		3637033M91	S.42939

Top Gasket Set		3638709M91	S.42401
Bottom Gasket Set		3640515M91	S.42402
8 Rocker Cover Gasket		3640094M1	S.42403
9 Head Gasket		4222534M1	S.42400
10 Sump Gasket		U5MK0600	S.30012

1 Main Bearings (1 set)	Standard	735168M91	S.40339
	0,010"	735169M91	S.40340
	0,020"	735170M91	S.40341
	0,030"	735171M91	S.40342
2 Conrod Bearings (1 set)	Standard	736950M91	S.40323
	0,010"	736951M91	S.40324
	0,020"	736952M91	S.40325
3 Thrust Washers (1 set)	0,030"	736953M91	S.40326
	Standard	747128/29M1	S.40345
4 Crankshaft		ZZ90082	S.40314
5 Front Oil Seal		1447690M1	S.40351
6 Rear Oil Seal		1447691M91	S.40356

1 Conrod		3637034M91	S.40359
2 Small End Bush		733767M1	S.40361
3 Conrod Bolt and Nut		3637029/30	S.40363
4 Conrod Nut		3637030M1	S.41329

Rocker Arm (LH)		4223076M91	S.30017
1 Rocker Arm (RH)		4223075M91	S.30018
2 Collet		736453M1	S.41413
3 Valve Retainer			
4 Valve Stem Seal		3637041M1	S.41325
5 Valve Insert / Seal			
6 Push Rod		733817M1	S.30019
7 Tappet/Cam Follow er		740671M1	S.41918
Inner Valve Spring		740465M1	S.30014
8 Outer Valve Spring		740467M1	S.30015
Inlet Valve Guide		736297M1	S.40496
9 Exhaust Valve Guide		748420M1	S.41539
Inlet Valve		748413M1	S.30038
10 Exhaust Valve		748309M1	S.41745
11 Camshaft		3641840M91	S.30016
12 Camshaft Bush		734883M1	S.41399
13 Oil Pump		3640908M91	S.42433

1004.4T	4	100,059	226,5	38,1	108,18	5	
----------------	---	---------	-------	------	--------	---	--

Models: 3075, 4245, 4255, 4345, 4365, 6130, 6140, 6150, 6235, 6245, 6255, 6265



Description	Remarks	Replaces	Sparex
1 Piston and Liner Set (per Cyl.)			S.42737
2 Liner		748216M1	S.42431
3 Piston		3640593M91	S.42436
4 Ring Set (5 rings)		3641316M91	S.42437

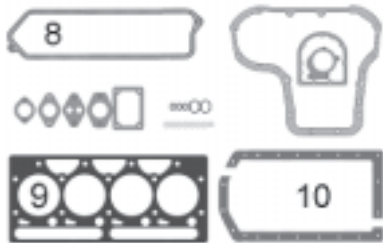

Top Gasket Set		3638709M91	S.42401
Bottom Gasket Set		4224042M91	S.30025
8 Rocker Cover Gasket		3640094M1	S.42403
9 Head Gasket		3641865M1	S.42400
10 Sump Gasket		U5MK0600	S.30012

Case IH

David Brown

Deutz

Fendt

Fiatagri

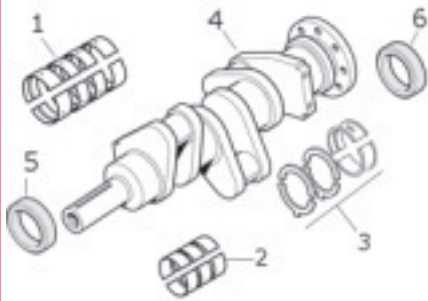

1 Main Bearings (1 set)	Standard	735168M91	S.40339
	0,010"	735169M91	S.40340
	0,020"	735170M91	S.40341
	0,030"	735171M91	S.40342
2 Conrod Bearings (1 set)	Standard	3637791M91	S.42972
	0,010"	3637792M91	S.42973
	0,020"	3637793M91	S.42974
3 Thrust Washers (1 set)	0,030"	3637794M91	S.30026
	Standard	747128M1	S.40345
4 Crankshaft		3640408M91	S.30027
5 Front Oil Seal		1447690M1	S.40351
6 Rear Oil Seal		1447691M1	S.40356

Ford

John Deere

M F

Renault

Zetor

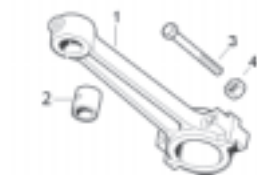

1 Conrod		3637028M91	S.30028
2 Small End Bush		744971M1	S.42247
3 Conrod Bolt and Nut		3637029/30	S.40363
4 Conrod Nut		3637030M1	S.41329

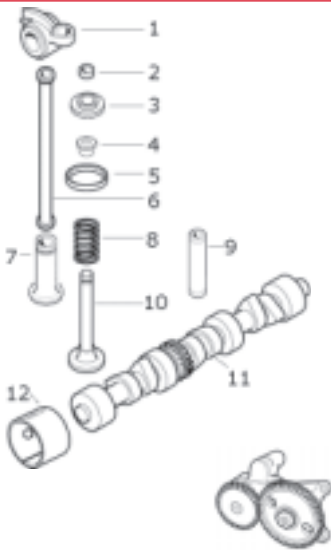

1	Rocker Arm (LH)	4223076M91	S.30017
	Rocker Arm (RH)	4223075M91	S.30018
2	Collet	736453M1	S.41413
3	Valve Retainer		
4	Valve Stem Seal	3637041M1	S.41325
5	Valve Insert / Seal		
6	Push Rod	733817M1	S.30019
7	Tappet/Cam Follow er	4222069M1	S.41918
8	Inner Valve Spring	740465M1	S.30014
	Outer Valve Spring	740467M1	S.30015
9	Inlet Valve Guide	3637056M1	S.40496
	Exhaust Valve Guide	748420M1	S.41539
10	Inlet Valve >U608301W	3637042M1	S.30029
	Inlet Valve <U608301W	3640597M1	S.42439
	Exhaust Valve	748309M1	S.41745
11	Camshaft	3641840M91	S.30016
12	Camshaft Bush	3638579M1	S.41399
13	Oil Pump	4222282M91	S.42434



Description	Remarks	Replaces	Sparex
1 Piston and Liner Set (per Cyl.)			S.40455
2 Liner	>S653769H	744948M1	S.40434
3 Piston		738871M91	S.40412
4 Ring Set (5 rings)		745747M91	S.40422
1 Piston and Liner Set (per Cyl.)			S.40456
2 Liner	S653769H>	744948M1	S.40434
3 Piston		3637280M91	S.40413
4 Ring Set (5 rings)		745752M91	S.40427
Top Gasket Set		747175M91	S.40597
Bottom Gasket Set		747195M91	S.40616
8 Rocker Cover Gasket			
9 Head Gasket		744723M1	S.40625
10 Sump Gasket			

Case IH

David Brown

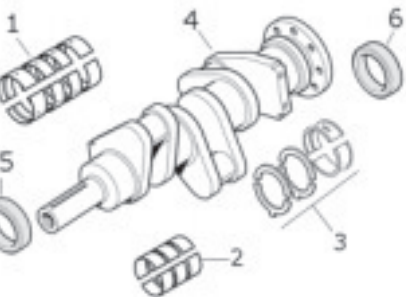

1 Main Bearings (1 set)	Standard	736930M91	S.42118
	0,010"	3638765M91	S.42119
	0,020"	736932M91	S.42120
	0,030"	3638767M91	S.42121
2 Conrod Bearings (1 set)	Standard	736934M91	S.40327
	0,010"	736935M91	S.40328
	0,020"	736936M91	S.40329
	0,030"	736937M91	S.40330
3 Thrust Washers (1 set)	Standard	747128/29M1	S.40345
	0,007"	735742/43M1	S.40346
1 Crankshaft	Rope Seals	ZZ90089	S.60225
Crankshaft	Oil Seals	ZZ90090	S.60097
Lock Tab		731192M1	S.40347
Ring Gear		731988M1	S.41449
5 Front Oil Seal		1447690M1	S.40351
6 Rear Oil Seal	Black Viton	1447691M1	S.40356
	Rope	735942M1	S.40355

Deutz

Fendt

Fiatagri

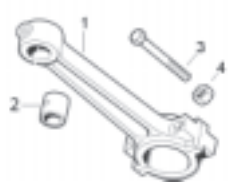

1 Conrod		3637034M91	S.40359
2 Small End Bush		733767M1	S.40361
3 Conrod Bolt and Nut		3637029/30	S.40363
4 Conrod Nut		3637030M1	S.41329

Ford

John Deere

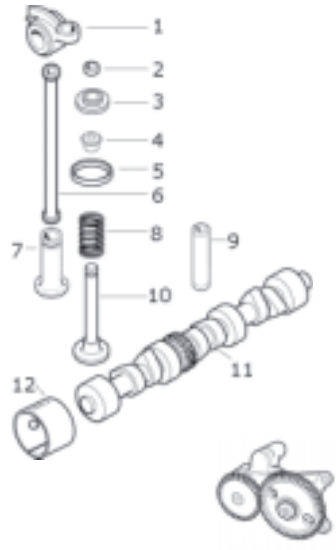

1 Rocker Arm (LH) Rocker Arm (RH)			
2 Collet		736453M1	S.41413
3 Valve Retainer			
4 Valve Stem Seal			
5 Valve Insert / Seal		3637041M1	S.41325
6 Push Rod		733817M1	S.30019
7 Tappet/Cam Follow er		740671M1	S.41918
8 Inner Valve Spring		731525M1	S.40502
9 Outer Valve Spring		735521M1	S.40507
Inlet Valve Guide		3637056M1	S.40496
Exhaust Valve Guide		734154M1	S.40497
Inlet Valve		735820/27M1	S.40478
Exhaust Valve		747552M1	S.40488
11 Camshaft			
12 Camshaft Bush			
13 Oil Pump (short shaft)		739400M91	S.41937
Oil Pump (long shaft)		736012M91	S.41934

Renault

Zetor

Perkins	Cyl.	Bore	Height	Pin	Height	Rings	Additional information
AT6.354	6	98,46	227,57	38,1	120,42	4	
Models: 31XP							

Case IH

David Brown

Deutz

Fendt

Fiatagri

Ford

John Deere

M F

Renault

Zetor



Description	Remarks	Replaces	Sparex
1 Piston and Liner Set (per Cyl.)			S.40457
2 Liner		744948M1	S.40434
3 Piston		738368M91	S.40414
4 Ring Set (4 rings)		745751M91	S.40428
Top Gasket Set		747219M91	S.40598
Bottom Gasket Set		747195M91	S.40616
8 Rocker Cover Gasket			
9 Head Gasket		744723M1	S.40625
10 Sump Gasket			

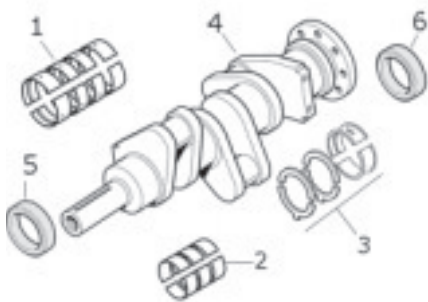

1 Main Bearings (1 set)	Standard		
	0,010"		
	0,020"		
	0,030"		
2 Conrod Bearings (1 set)	Standard		
	0,010"		
	0,020"		
	0,030"		
3 Thrust Washers (1 set)	Standard		
	0,007"		
4 Crankshaft	Rope Seals		
4 Crankshaft	Oil Seals		
Lock Tab		731192M1	S.40347
Ring Gear		731988M1	S.41449
5 Front Oil Seal		1447690M1	S.40351
6 Rear Oil Seal	Black Viton	1447691M1	S.40356
6 Rear Oil Seal	Rope		



1 Conrod			
2 Small End Bush			
3 Conrod Bolt and Nut			
4 Conrod Nut			

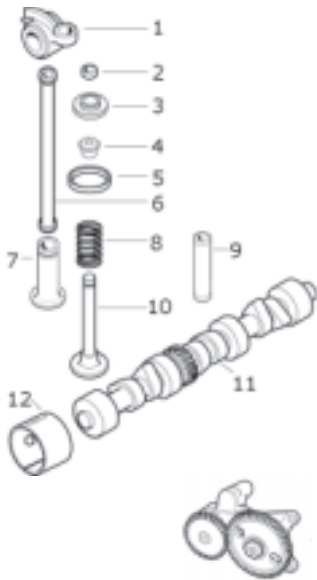

1 Rocker Arm (LH)			
1 Rocker Arm (RH)			
2 Collet			
3 Top Retainer			
3 Bottom Retainer			
4 Valve Stem Seal			
5 Valve Insert / Seal			
6 Push Rod		733817M1	S.30019
7 Tappet/Cam Follow er		740671M1	S.41918
8 Inner Valve Spring			
8 Outer Valve Spring			
9 Inlet Valve Guide			
9 Exhaust Valve Guide			
10 Inlet Valve			
10 Exhaust Valve			
11 Camshaft			
12 Camshaft Bush			
13 Oil Pump		736012M91	S.41934

Models: 1014, 1105, 1200



Description	Remarks	Replaces	Sparex
1 Piston and Liner Set (per Cyl.)			S.40456
2 Liner		744948M1	S.40434
3 Piston		3637280M91	S.40413
4 Ring Set (5 rings)		745752M91	S.40427
Top Gasket Set		747178M91	S.40599
Bottom Gasket Set		747195M91	S.40616
8 Rocker Cover Gasket			
9 Head Gasket		742993M91	S.40619
10 Sump Gasket			

Case IH

David Brown

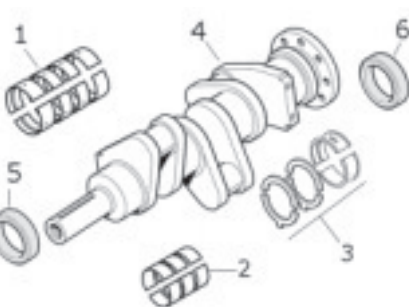

1 Main Bearings (1 set)	Standard	736930M91	S.42118
	0,010"	3638765M91	S.42119
	0,020"	736932M91	S.42120
	0,030"	3638767M91	S.42121
2 Conrod Bearings (1 set)	Standard	736934M91	S.40327
	0,010"	736935M91	S.40328
	0,020"	736936M91	S.40329
3 Thrust Washers (1 set)	Standard	747128/29M1	S.40345
	0,007"	735742/43M1	S.40346
4 Crankshaft	Rope Seals	ZZ90089	S.60225
	Oil Seals	ZZ90090	S.60097
	Lock Tab	731192M1	S.40347
	Ring Gear	731988M1	S.41449
5 Front Oil Seal		1447690M1	S.40351
6 Rear Oil Seal	Black Viton	1447691M1	S.40356
Rear Oil Seal	Rope	735942M1	S.40355

Deutz

Fendt

Fiataagri



1 Conrod		3637034M91	S.40359
2 Small End Bush		733767M1	S.40361
3 Conrod Bolt and Nut		3637029/30	S.40363
4 Conrod Nut		3637030M1	S.41329

Ford

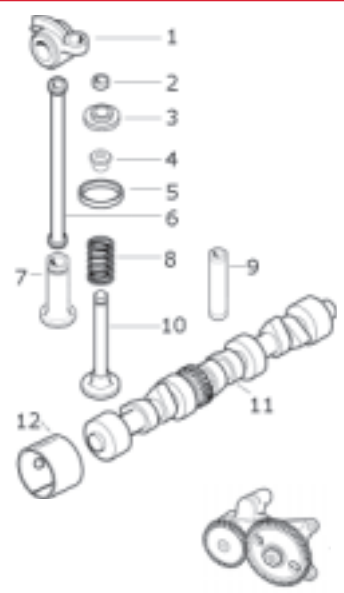

1	Rocker Arm (LH)		
	Rocker Arm (RH)		
2	Collet	736453M1	S.41413
3	Top Retainer		
	Bottom Retainer		
4	Valve Stem Seal		
5	Valve Insert / Seal		
6	Push Rod	733817M1	S.30019
7	Tappet/Cam Follow er	740671M1	S.41918
8	Inner Valve Spring	731525M1	S.40502
	Outer Valve Spring	735521M1	S.40507
9	Inlet Valve Guide	3637056M1	S.40496
	Exhaust Valve Guide	734154M1	S.40497
10	Inlet Valve	735820/27M1	S.40478
	Exhaust Valve	747552M1	S.40488
11	Camshaft		
12	Camshaft Bush		
13	Oil Pump	736012M91	S.41934

John Deere

M F

Renault

Zetor

Perkins	Cyl.	Bore	Height	Pin	Height	Rings	Additional Information
AT6.354.1	6	98,46	227,57	38,1	120,42	4	

Models: 1130, 1135



Description	Remarks	Replaces	Sparex
1 Piston and Liner Set (per Cyl.)		Order Components	
2 Liner		744948M1	S.40434
3 Piston		738368M91	S.40414
4 Ring Set (4 rings)		745751M91	S.40428
Top Gasket Set		U5LT0026	S.40599
Bottom Gasket Set		747195M91	S.40616
8 Rocker Cover Gasket			
9 Head Gasket			
10 Sump Gasket			

Case IH

David Brown

Deutz

Fendt

Fiatagri

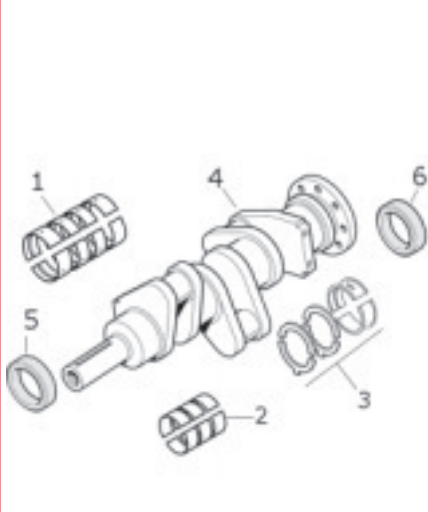

1 Main Bearings (1 set)	Standard		
	0,010"		
	0,020"		
	0,030"		
2 Conrod Bearings (1 set)	Standard		
	0,010"		
	0,020"		
	0,030"		
3 Thrust Washers (1 set)	Standard	747128/29M1	S.40345
	0,007"	735742/43M1	S.40346
4 Crankshaft			
4 Crankshaft			
Lock Tab		731192M1	S.40347
Ring Gear			
5 Front Oil Seal		1447690M1	S.40351
6 Rear Oil Seal	Black Viton	1447691M1	S.40356
6 Rear Oil Seal			

Ford



1 Conrod			
2 Small End Bush			
3 Conrod Bolt and Nut		3637029/30	S.40363
4 Conrod Nut		3637030M1	S.41329

John Deere

M F

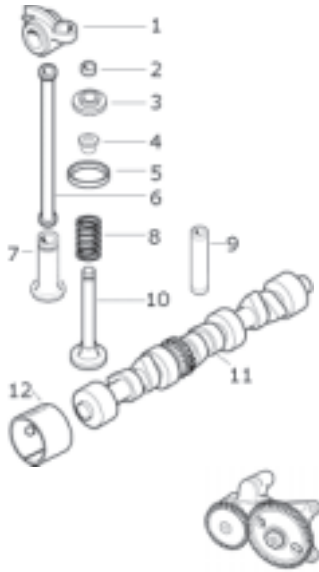

1 Rocker Arm (LH)			
1 Rocker Arm (RH)			
2 Collet		736453M1	S.41413
3 Top Retainer			
3 Bottom Retainer			
4 Valve Stem Seal			
5 Valve Insert / Seal			
6 Push Rod		733817M1	S.30019
7 Tappet/Cam Follow er		740671M1	S.41918
8 Inner Valve Spring		731525M1	S.40502
8 Outer Valve Spring		735521M1	S.40507
9 Inlet Valve Guide		3637056M1	S.40496
9 Exhaust Valve Guide		748420M1	S.41539
10 Inlet Valve		735820/27M1	S.40478
10 Exhaust Valve		741466M1	S.40488
11 Camshaft			
12 Camshaft Bush			
13 Oil Pump		41314067	S.41934

Renault

Zetor



Description	Remarks	Replaces	Sparex
1 Piston and Liner Set (per Cyl.)			
2 Liner		744948M1	S.40434
3 Piston		748266M91	S.42197
4 Ring Set (3 rings)		745738M91	S.42207
Top Gasket Set		74717191	S.40600
Bottom Gasket Set		747195M91	S.40616
8 Rocker Cover Gasket		744381M1	S.41637
9 Head Gasket		745491M1	S.41638
10 Sump Gasket			

Case IH

David Brown

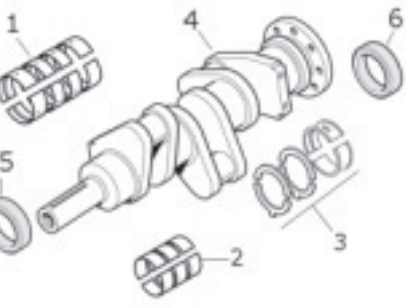

1 Main Bearings (1 set)	Standard	744921M91	S.60335
	0,010"	744922M91	S.60336
	0,020"	744923M91	S.60337
	0,030"	744924M91	S.60338
2 Conrod Bearings (1 set)	Standard	736934M91	S.40327
	0,010"	736935M91	S.40328
	0,020"	736936M91	S.40329
3 Thrust Washers (1 set)	Standard	747128/29M1	S.40345
	0,007"	735742/43M1	S.40346
4 Crankshaft	Rope Seals	3637408M91	S.60096
	Oil Seals	ZZ90086	S.60095
	Lock Tab	731192M1	S.40347
	Ring Gear	731988M1	S.41449
5 Front Oil Seal		1447690M1	S.40351
6 Rear Oil Seal	Black Viton	1447691M1	S.40356
Rear Oil Seal	Rope	735942M1	S.40355

Deutz

Fendt

Fiataagri



1 Conrod		3637034M91	S.40359
2 Small End Bush		733767M1	S.40361
3 Conrod Bolt and Nut		3637029/30	S.40363
4 Conrod Nut		3637030M1	S.41329

Ford

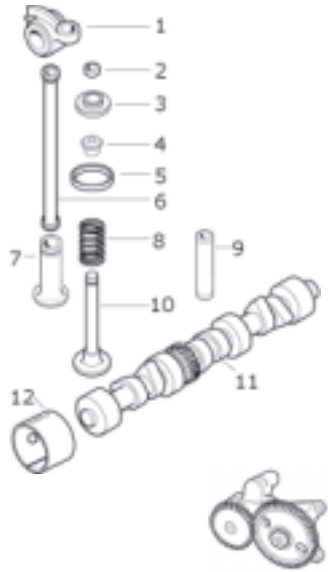

1 Rocker Arm (LH)			
Rocker Arm (RH)			
2 Collet		736453M1	S.41413
3 Top Retainer			
Bottom Retainer			
4 Valve Stem Seal		3637041M1	S.41325
5 Valve Insert / Seal			
6 Push Rod		733817M1	S.30019
7 Tappet/Cam Follow er		740671M1	S.41918
8 Inner Valve Spring		731525M1	S.40502
Outer Valve Spring		735521M1	S.40507
9 Inlet Valve Guide		3637056M1	S.40496
Exhaust Valve Guide		748420M1	S.41539
10 Inlet Valve		735820/27M1	S.40478
Exhaust Valve		748309M1	S.41745
11 Camshaft			
12 Camshaft Bush			
13 Oil Pump	>U757253N	747292M91	S.41935
Oil Pump	U757254N>	747293M91	S.41936

John Deere

M F

Renault

Zetor

Perkins	Cyl.	Bore	Height	Pin	Height	Rings	Additional Information
AT6.354.4	6	98,46	227,57	34,93	120,73	3	
Models: 560, 565, 660, 665, 750, 760, 820, 825, 830, 835, 840, 845, 1134, 2680, 2685, 2720, 2725, 3630, 3650							

Case IH

David Brown

Deutz

Fendt

Fiatagri

Ford

John Deere

M F

Renault

Zetor



Description	Remarks	Replaces	Sparex
1 Piston and Liner Set (per Cyl.)			Order Components
2 Liner		744948M1	S.40434
3 Piston		748267M91	S.42199
4 Ring Set (3 rings)		745738M91	S.42207

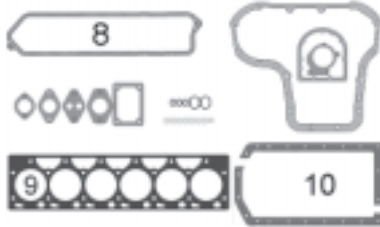

Top Gasket Set		747172M91	S.40601
Bottom Gasket Set		747195M91	S.40616
8 Rocker Cover Gasket		744381M1	S.41637
9 Head Gasket		745491M1	S.41638
10 Sump Gasket			

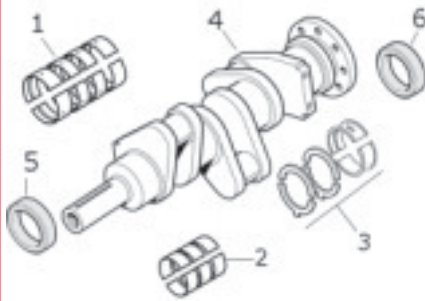

1 Main Bearings (1 set)	Standard	744921M91	S.60335
	0,010"	744922M91	S.60336
	0,020"	744923M91	S.60337
	0,030"	744924M91	S.60338
2 Conrod Bearings (1 set)	Standard	736934M91	S.40327
	0,010"	736935M91	S.40328
	0,020"	736736M91	S.40329
3 Thrust Washers (1 set)	0,030"	736937M91	S.40330
	Standard	744128/29M1	S.40345
4 Crankshaft	0,007"	735742/43M1	S.40346
Lock Tab		3637404M91	S.60095
Ring Gear		731192M1	S.40347
5 Front Oil Seal		731988M1	S.41449
6 Rear Oil Seal			
	Black Viton	1447691M1	S.40356

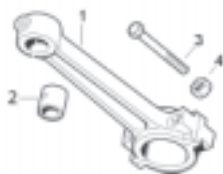

1 Conrod			
2 Small End Bush		744971M1	S.42247
3 Conrod Bolt and Nut		3637029/30	S.40363
4 Conrod Nut		3637030M1	S.41329

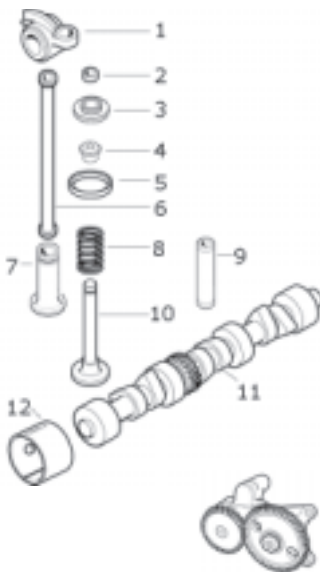

1	Rocker Arm (LH)		
	Rocker Arm (RH)		
2 Collet		736453M1	S.41413
3	Top Retainer		
	Bottom Retainer		
4 Valve Stem Seal			
5 Valve Insert / Seal		3637041M1	S.41325
6 Push Rod		733817M1	S.30019
7 Tappet/Cam Follow er		740671M1	S.41918
8	Inner Valve Spring		731525M1
	Outer Valve Spring		735521M1
9	Inlet Valve Guide		3637056M1
	Exhaust Valve Guide		748420M1
10	Inlet Valve		735820M1
	Exhaust Valve		748309M1
11 Camshaft			
12 Camshaft Bush			
13	Oil Pump	>U757253N	747292M91
	Oil Pump	U757254N>	747293M91

Perkins Cyl.	Bore	Height	Pin	Height	Rings	Additional Information
1006.6	6	100,059	226,5	34,92	108,14	5

Models: 3085, 3095, 3115, 4260, 4270, 6160, 6170, 6260



Description	Remarks	Replaces	Sparex
1 Piston and Liner Set (per Cyl.)			S.30039
2 Liner		748216M1	S.42431
3 Piston		3638989M91	S.42937
4 Ring Set (5 rings)		3637033M91	S.42939
Top Gasket Set		3638697M91	S.42397
Bottom Gasket Set		4222229M91	S.42398
8 Rocker Cover Gasket		48329M1	S.42399
9 Head Gasket		4222354M1	S.42396
10 Sump Gasket			

Case IH

David Brown

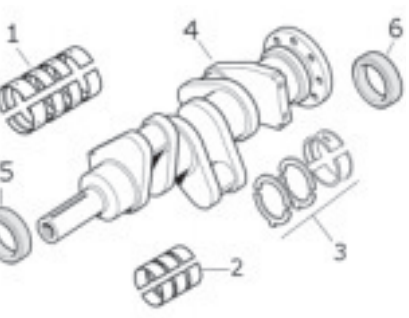

1 Main Bearings (1 set)	Standard	3637020M91	S.42478
	0,010"	3637021M91	S.42479
	0,020"	3637022M91	S.42480
	0,030"	3637023M91	S.42481
2 Conrod Bearings (1 set)	Standard	736934M91	S.40327
	0,010"	736935M91	S.40328
	0,020"	736936M91	S.40329
	0,030"	736937M91	S.40330
3 Thrust Washers (1 set)	Standard	747128M1	S.40345
4 Crankshaft		3638402M91	S.30030
5 Front Oil Seal		1447690M1	S.40351
6 Rear Oil Seal		1447691M91	S.40356

Deutz

Fendt

Fiatagri

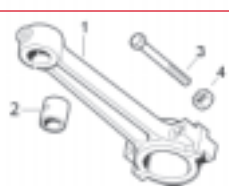

1 Conrod		3637034M91	S.40359
2 Small End Bush		733767M1	S.40361
3 Conrod Bolt and Nut		3637029/30	S.40363
4 Conrod Nut		3637030M1	S.41329

Ford

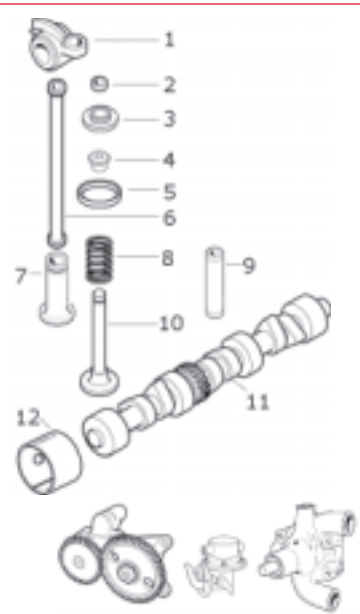

1 Rocker Arm (LH)		4223076M91	S.30017
1 Rocker Arm (RH)		4223075M91	S.30018
2 Collet		736453M1	S.41413
3 Top Retainer			
3 Bottom Retainer			
4 Valve Stem Seal		3637041M1	S.41325
5 Valve Insert / Seal			
6 Push Rod		733817M1	S.30019
7 Tappet/Cam Follow er		740671M1	S.41918
8 Inner Valve Spring		740465M1	S.30014
8 Outer Valve Spring		740467M1	S.30015
9 Inlet Valve Guide			
9 Exhaust Valve Guide		748420M1	S.41539
10 Inlet Valve		748413M1	S.30038
10 Exhaust Valve		748309M1	S.41745
11 Camshaft		3641738M1	S.30031
12 Camshaft Bush			
13 Oil Pump		3638595M91	S.42432
14 Fuel Pump		4222105M91	S.40565
15 Water Pump		3641860M91	S.42316

John Deere

M F

Renault

Zetor

Perkins	Cyl.	Bore	Height	Pin	Height	Rings	Additional Information
1006.6T	6	100,059	226,5	38,1	108,18	3	See page 179 for Piston dimensions
Models: 3120, 3125, 3140, 3635, 3645, 3655, 3660, 4270, 4370, 6180, 6190, 6270, 6280, 6290, 8110, 8120, 8130, 8210, 8220							



Description	Remarks	Replaces	Sparex
1 Piston and Liner Set (per Cyl.)			S.42737
2 Liner		748216M1	S.42431
3 Piston		3640593M91	S.42436
4 Ring Set (3 rings)		3641316M91	S.42437
Top Gasket Set		3638697M91	S.42397
Bottom Gasket Set		4222229M91	S.42398
8 Rocker Cover Gasket		748329M1	S.42399
9 Head Gasket		4222354M1	S.42396
10 Sump Gasket			

Case IH

David Brown

Deutz

Fendt

Fiatagri

Ford

John Deere

M F

Renault

Zetor

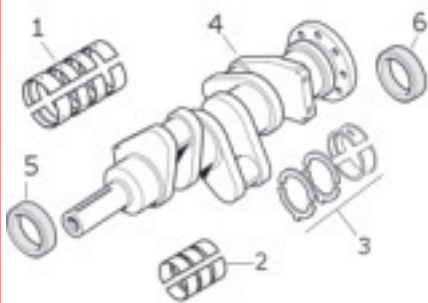

1 Main Bearings (1 set)	Standard	3637020M91	S.42478
	0,010"	3637021M91	S.42479
	0,020"	3637022M91	S.42480
	0,030"	3637023M91	S.42481
2 Conrod Bearings (1 set)	Standard	3637024M91	S.30034
	0,010"	3637025M91	S.30035
	0,020"	3637026M91	S.30036
3 Thrust Washers (1 set)	0,030"	3637027M91	S.30037
	Standard	747128M1	S.40345
4 Crankshaft		3637019M91	S.30032
5 Front Oil Seal		1447690M1	S.40351
6 Rear Oil Seal		1447691M1	S.40356



1 Conrod >F044009		3637028M91	S.30028
	Conrod <F044009	3638768M91	S.30033
2 Small End Bush		744971M1	S.42247
3 Conrod Bolt and Nut		3637029/30	S.40363
4 Conrod Nut		3637030M1	S.41329

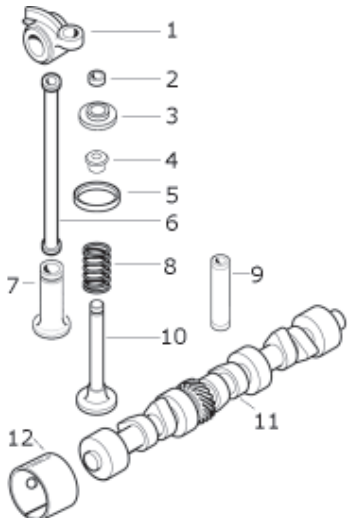

1 Rocker Arm (LH)		4223076M91	S.30017
	Rocker Arm (RH)	4223075M91	S.30018
2 Collet		736453M1	S.41413
3 Top Retainer			
	Bottom Retainer		
4 Valve Stem Seal		3637041M1	S.41325
5 Valve Insert / Seal			
6 Push Rod		733817M1	S.30019
7 Tappet/Cam Follow er		740671M1	S.41918
8 Inner Valve Spring		740465M1	S.30014
	Outer Valve Spring	740467M1	S.30015
9 Inlet Valve Guide		4223073M1	S.40496
Exhaust Valve Guide		748420M1	S.41539
Inlet Valve		3637042M1	S.30029
10 Inlet Valve		3640597M1	S.42439
	Exhaust Valve	748309M1	S.41745
11 Camshaft		3641738M1	S.30031
12 Camshaft Bush			



13 Oil Pump		3641171M91	S.42435
14 Fuel Pump		4222105M91	S.40565
15 Water Pump		4223109M91	S.42316

Various Engine Parts suitable for Massey Ferguson



Sparex

S.40306



Cylinder Head					
Pos	Description	Engine	Remarks	Replaces	Sparex
Cylinder Head complete with Valves		A3.152		ZZ80058	S.40303
		AD3.152		ZZ80082	S.40304
		AD4.203		ZZ80033	S.40305
		A4.212 A4.236 A4.248		ZZ80072	S.40306
		A6.354 A6.354.4		ZZ80071	S.42323
		A4.192 A4.203		ZZ80089	S.42496

S.40508

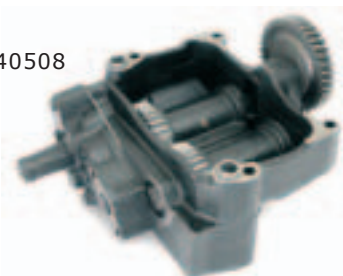

Balancer Unit					
Pos	Description	Engine	Remarks	Replaces	Sparex
Balancer		A4.236 AT4.236 A4.248	4 Hole	746432M91	S.40508
		A4.236 AT4.236 A4.248 1004	6 Hole	3637352M91	S.40512



Spare Parts for Crankshafts and Camshafts					
Pos	Description	Engine	Remarks	Replaces	Sparex
1	Crankshaft Gears	85mm, 87mm Petrol	Bottom	825136M1	S.42419
			Middle	825135M1	S.42418
		A3.144 A3.152 AD3.152	Bottom	3641826M1	S.40353
			Middle	731205M1	S.40523
		A4.192 A4.203 AD4.203	Middle	731203M1	S.40520
			Bottom	731797M91	S.40525
		A4.212 A4.236 AT4.236 A4.248	Middle	731034M1	S.40524
			Bottom	734749M1	S.41851
		A4.212 A4.236 AT4.236 A4.248	Middle	734738M91	S.40526
			Middle	734627M1	S.41879
2	Crankshaft Pulley	A3.144 A3.152 AD3.152 A4.236 AT4.236 A4.248		3638098M1	S.41855
3	Oil Pump Gear	A3.144 A3.152 AD3.152		73355M92	S.42125
4	Camshaft Gear	A4.192 A4.203 AD4.203		731028M1	S.40521
		A4.212 A4.236 AT4.236 A4.248 A6.354.A6.354.1/4		736254M1	S.40522

Case IH

David Brown

Deutz

Fendt

Fiatagri

Ford

John Deere

M F

Renault

Zetor



Case IH

Starter Ring Gears

Engine	Replaces	Sparex
Standard 85 Standard 87	825452M1	S.42422
A3.144 A3.152 AD3.152 A4.192 A4.203 AD4.203 A4.212 A4.236 AT4.236 A4.248	731008M1	S.40364
A4.318 A6.354 AT6.354	731988M1	S.41449

David Brown

Deutz

Fendt

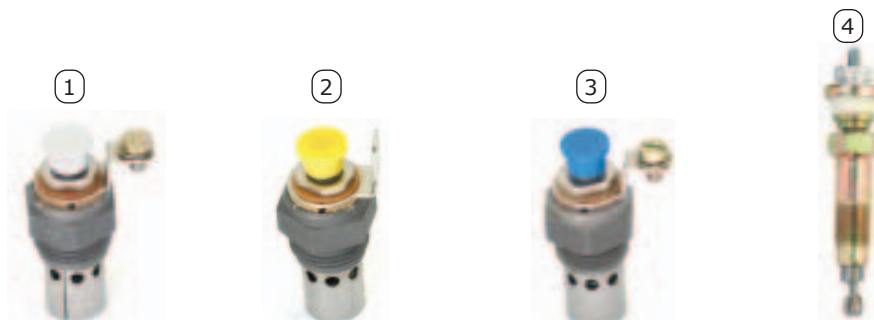

Heater Plugs

Pos	Engine	Remarks	Replaces	Sparex
1	A3.152 AD3.152 A4.192 A4.203 AD4.203 A4.212 A6.354.4	Screw Fittings	893501M91	S.40626
2	A4.107 AD3.152 A4.248 A4.236 AT4.236 A4.318 A6.354.4	Sleeve Fittings	1446935M1	S.40627
3	23C Diesel		1446176M91	S.41322
4	23C Diesel		829162M1	S.61336

Fiatagri

Ford



Spark Plug

Remarks	Replaces	Sparex
Petrol 85mm,87mm		S.42484

Core Plugs

Sizes	Sparex
22,27 mm	S.8444
32,18 mm	S.8449
32,18 mm Stainless Steel	S.12874
35,36 mm	S.8451
35,36 mm Stainless Steel	S.14535
38,48 mm	S.8450
38,53 mm	S.8446
38,53 mm Stainless Steel	S.14458

John Deere

M F

Renault

Zetor



Various Engine Parts suitable for Massey Ferguson



Sparex

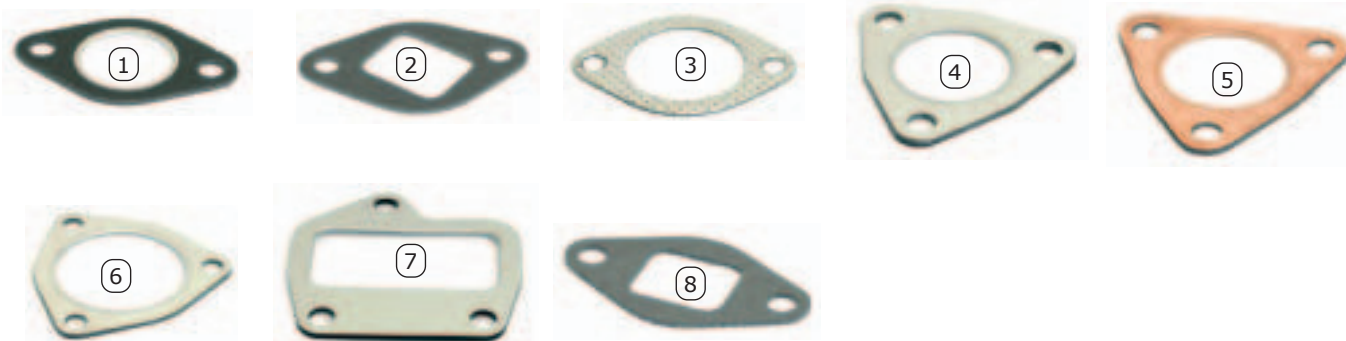

Exhaust and Thermostat Gaskets

Pos	Engine	Description	Remarks	Replaces	Sparex
1	A3.144,A3.152	Exhaust Gasket		731268M1	S.41348
2	A3.152,AD3.152	Exhaust Gasket		735016M1	S.41350
3	Petrol 80, 85, 87mm,Diesel 20,23C	Exhaust Gasket		825003M1	S.40644
4	A4.192,A4.203,AD4.203	Exhaust Gasket		827877M1	S.40645
5	A4.212,A4.236,A4.248	Exhaust Gasket	180° Manifold	897938M1	S.40646
6	A4.212,A4.236,A4.248	Exhaust Gasket	90° Manifold	194742M1	S.40647
7	A4.236,A4.248	Exhaust Gasket		1876671M2	S.42646
8	AD4.203	Exhaust Gasket		782814M1	S.42686
9	A3.152 AD3.152	Thermostat Gasket			S.41347
10	A3.152,AD3.152	Thermostat Housing Gasket		3637530M1	S.42211

Injector Pipes (Engine A4.212 | A4.236 | A4.248)

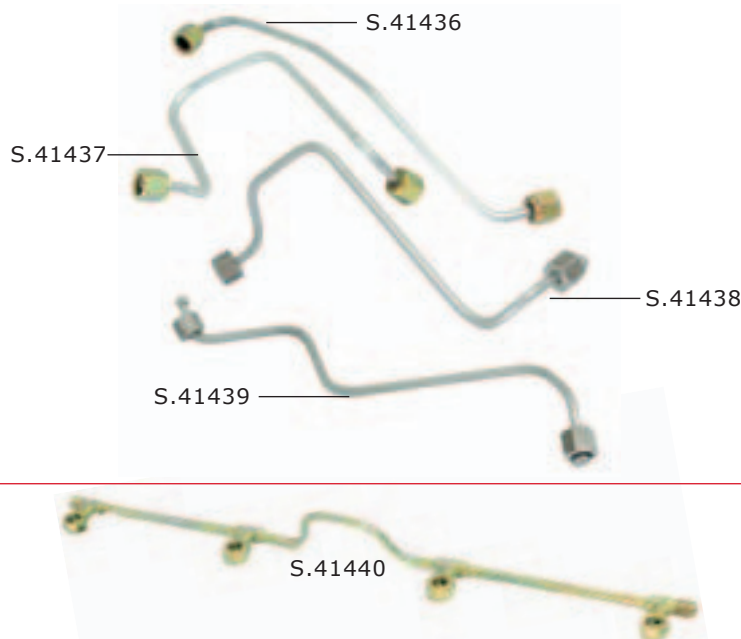

Engine	Remarks	Replaces	Sparex
AD3.152	Pipe (1)	3638623M01	S.41510
	Pipe (2)	3638624M01	S.41511
	Pipe (3)	3638625M01	S.41512
	Oil overflow	735010M01	S.41513
A4.212 A4.236 A4.248	Pipe (1)	3641094M01	S.41436
	Pipe (2)	3641262M01	S.41437
	Pipe (3)	3641095M01	S.41438
	Pipe (4)	3641156M01	S.41439
	Oil overflow	734723M01	S.41440

Case IH

David Brown

Deutz

Fendt

Fiatagri

Ford

John Deere

M F

Renault

Zetor